

JUNETEENTH MONUMENT UPDATE

MAY 11, 2015

**BERNADETTE PHIFER, CARVER MANAGER
LAURA ESPARZA, DIVISION MANAGER
LAND, FACILITIES AND PROGRAM COMMITTEE**



**George
Washington
Carver
Museum
& Cultural
Center**

PURPOSE

- Project Briefing Update
- Background
- Project Timeline
- Project Design
- Project Budget

BACKGROUND

- The Juneteenth Memorial Monument (JMM) is composed of five large bronze figures of 19th Century Texans.
- The JMM was commissioned and paid for by the State of Texas through the Texas Legislative Black Caucus (TLBC).
- TLBC recognized the George Washington Carver Museum (Carver) as the ideal location for these monuments.
- The Carver is renown as “*a key source of information on the history and celebration of Juneteenth*”.
- The Carver and the Texas Facilities Commission (TFC) accepted Joint custodianship of the JMM after a discussion with State Rep. Dawnna Dukes in 2012.

BACKGROUND

- City Council authorized the negotiation and execution of an inter-local agreement with the Texas Facilities Commission (TFC) on August 22, 2013 to accept custodial possession of the JMM for a term of 99 years, executed 9/20/2013.
- The City will pay for the siting and installation of the JMM and will also provide a plaque recognizing the State of Texas.
- The City is responsible for the maintenance of the JMM bronze sculptures.

PROJECT TIMELINE

- Jan 2014: PARD selects “The Lawrence Group” from rotation list
- Feb 2014: Contracting of architect
- May 2014: Conceptual design work
- June 2014: Design finalized
- July-September 2014: Permitting process
- **October-December 2014: Request for Proposal, Proposal Review and Revision**
- **January 20, 2015: Proposal Acceptance, Notice to Proceed**
- **January 26, 2015: Construction initiated**
- **May 2015: Sculpture installation**
- **June 2015: Proposed completion of project and opening celebration**



PROJECT DESIGN & PREPARATION

- The Lawrence Group architectural firm selected to design the setting of the JMM at the Carver location.
- The monument will feature a park-like setting with seating, interpretive panels, landscaping and ADA accessibility.
- Heart of Texas Art Foundry, originally cast the work and participated in the planning process with the artists in 2000, was selected with a sole source requisition to apply final patina to the sculpture and place them on individual mounts.

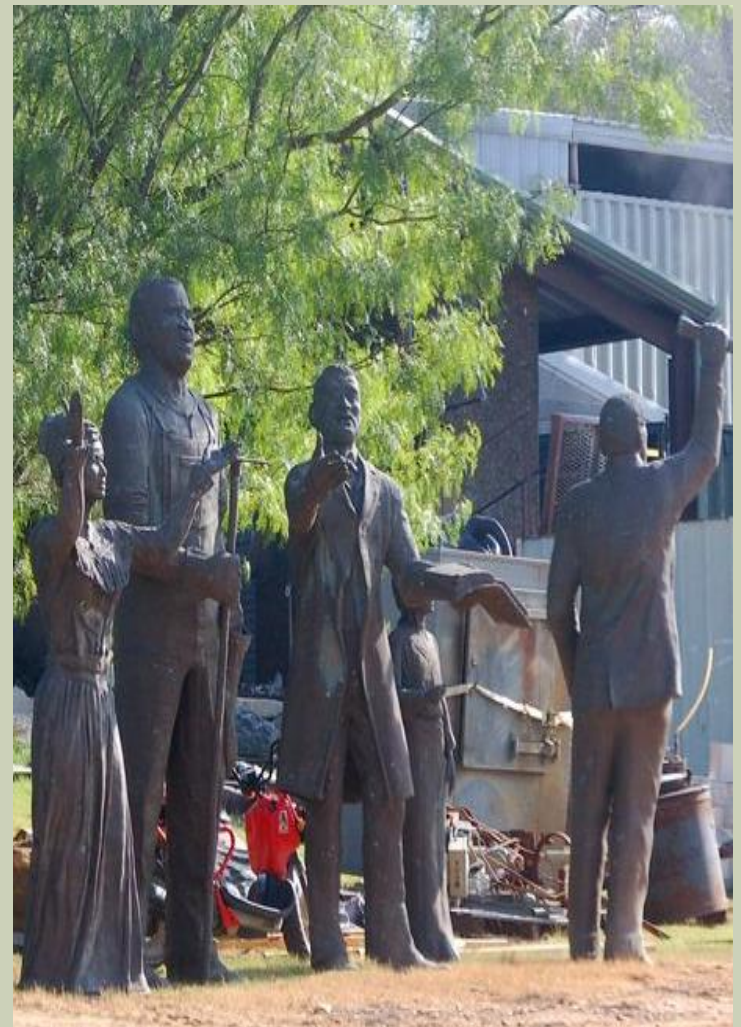

JUNETEENTH MEMORIAL PROJECT DESIGN-PLAN

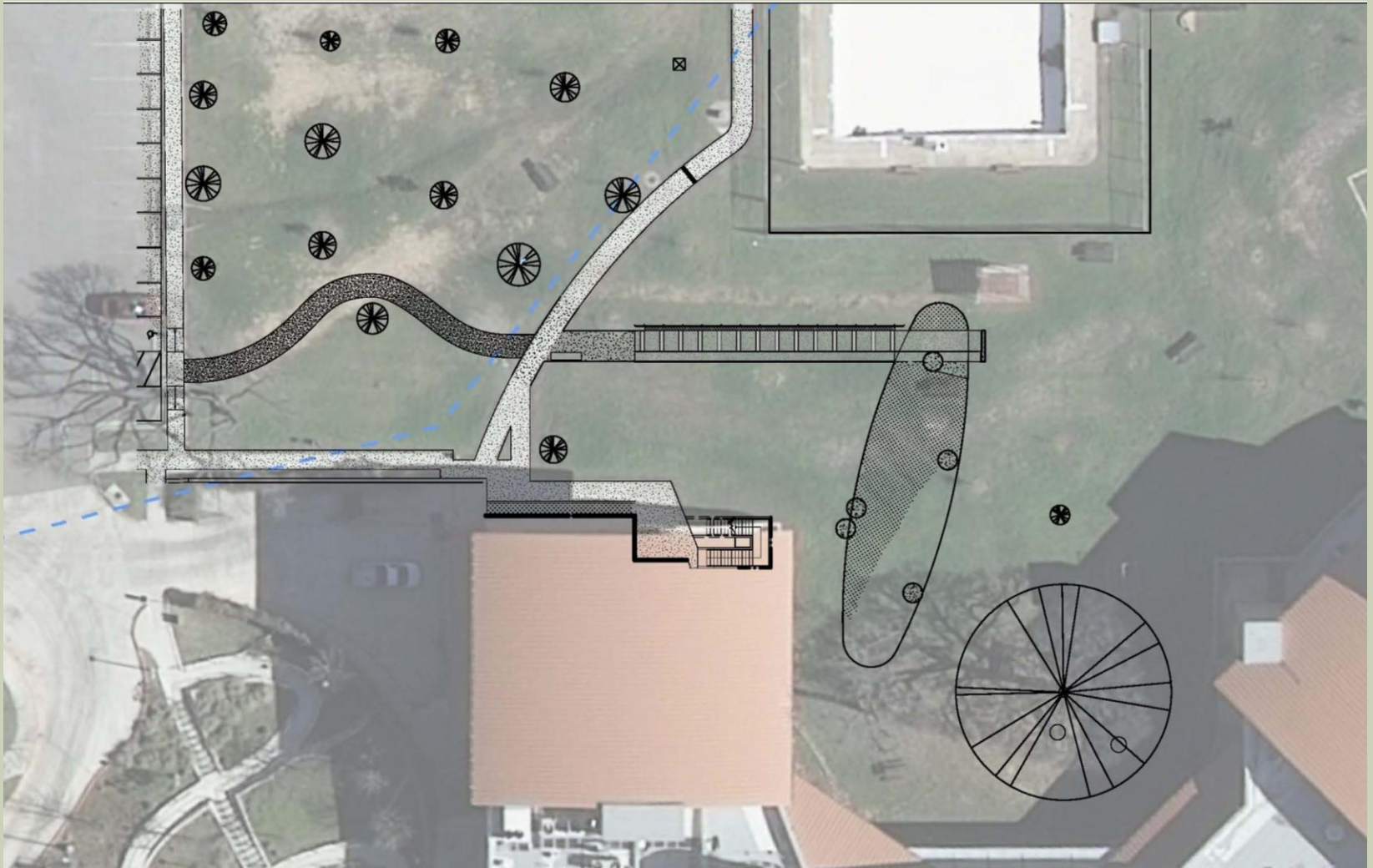

JUNETEENTH MEMORIAL PROJECT DESIGN-EAST VIEW

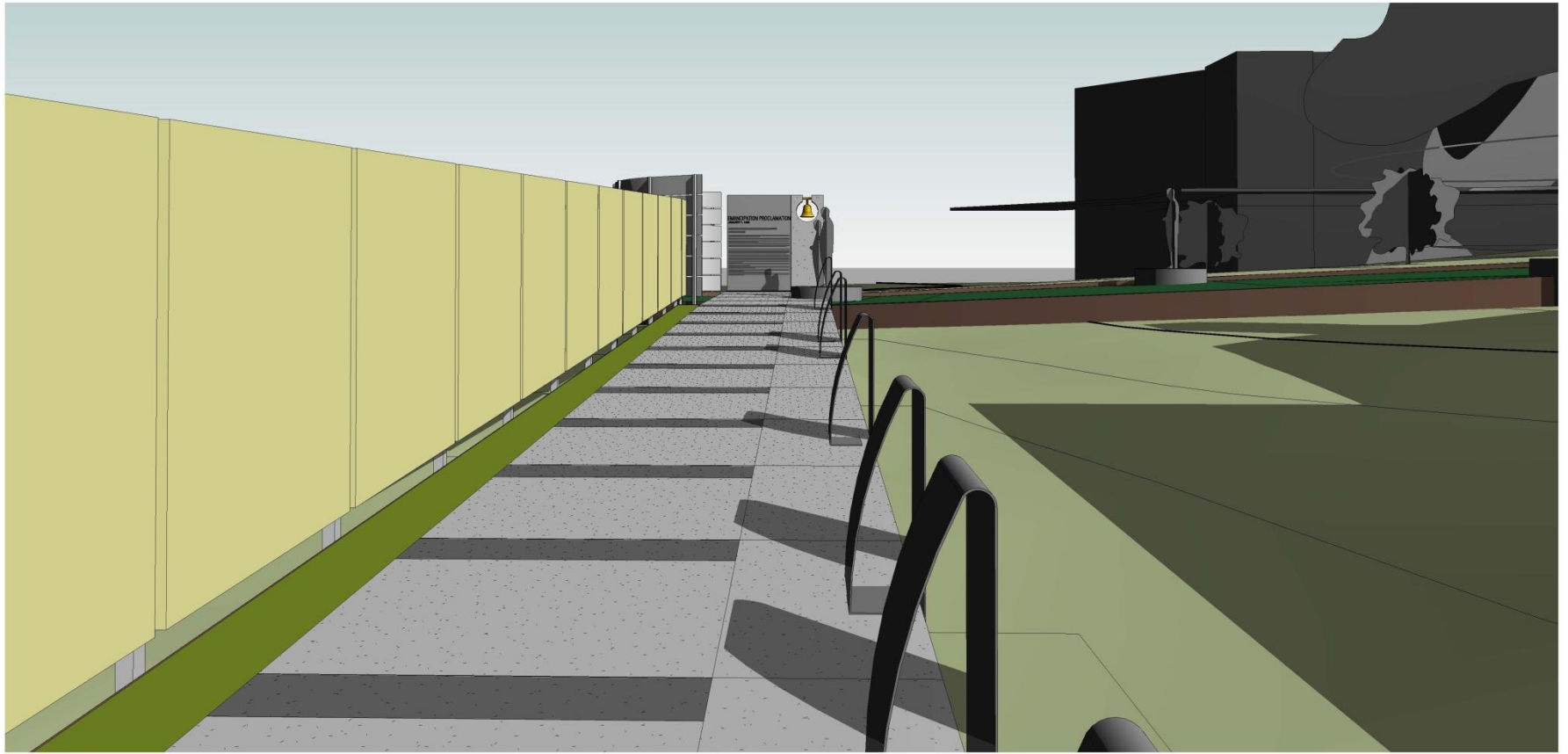

JUNETEENTH MEMORIAL PROJECT DESIGN-DETAIL

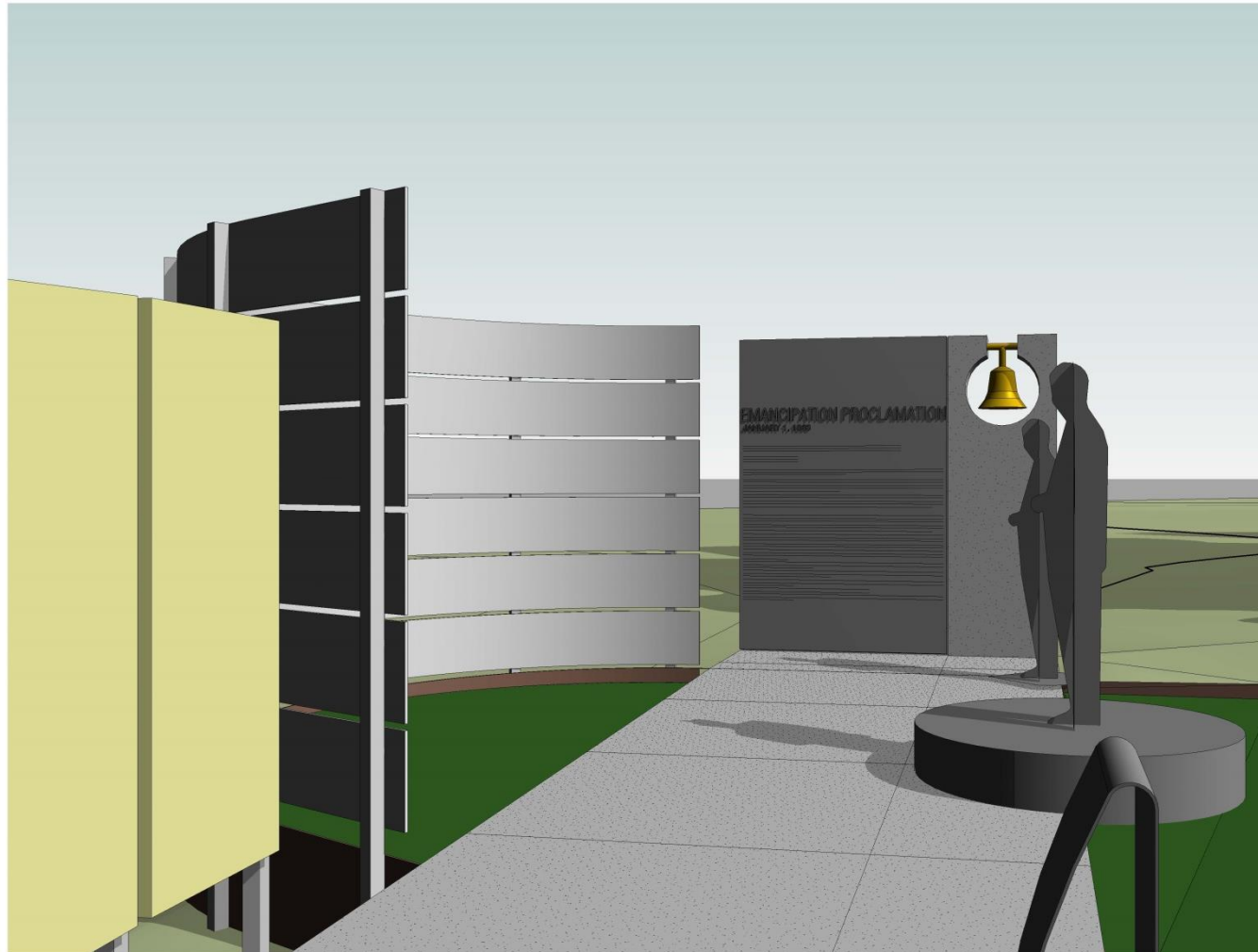

BUDGET

- Total budget for this project is \$236,000 for design, permitting, construction and landscaping.
- The budget source is Parkland Dedication Funds
- The JMM is insured by the City of Austin
- The contract's only plaque requirement is to recognize the Texas Legislative Black Caucus



FOR MORE INFORMATION

- **Bernadette Phifer**
Curator & Program Manager
George Washington Carver Museum
512.974-4926
- **D'Anne Williams**
Project Manager
Planning and Design Division
512.974-9456
- **Laura Esparza**
Division Manager
History, Arts and Nature Division
512.974-4001

