

**HISTORIC LANDMARK COMMISSION
MAY 18, 2015
DEMOLITION AND RELOCATION PERMITS
HDP-2015-0252
2102 E.M. FRANKLIN AVENUE**

PROPOSAL

Demolish a ca. 1940 house.

ARCHITECTURE

One-story, wing-and-gable plan, stone-veneered frame house with minimal Tudor Revival detailing; single and paired 2:2 windows; round-arched recessed entry in a front-gabled entry bay; exterior stone-veneered, battered chimney. The actual construction date of this house is not known; however, the house displays a style consistent with a late 1930s – early 1940s design sensibility with its Tudor Revival styling and stone veneer; however, the windows in the house are 1950s-style 2:2, and a house of this style built in the late 1930s or early 1940s would more likely have had 6:6 windows.

RESEARCH

The house appears to have been built around 1940, but was outside the city limit at the time, so no building permit exists; the only city permit for this address is a water service permit from 1954. The house was built by Jesse W. and Verna Marx, who also do not appear at this address in city directories prior to 1952, again because the house was outside the city limit. Jesse W. Marx was born in Burnet, Texas, and operated a fix-it shop. He died in 1943, and neighborhood legend has it that he and Verna built this house shortly before his death. His death certificate shows that he was living on Redwood Street on Route 1 in Austin at the time of his death. Very little is known of Verna Marx – she was apparently the second wife of Jesse W. Marx, but there is little to no information about her, and all she had was a death notice in the Austin newspapers when she passed away in 1986.

STAFF COMMENTS

The house is not within the bounds of any City survey.

STAFF RECOMMENDATION

Encourage relocation over demolition, but release the permit upon completion of a City of Austin Documentation Package, consisting of photographs of all elevations, a dimensioned sketch plan, and a narrative history, for archiving at the Austin History Center. The applicant is in active negotiations with a neighbor to relocate the house to the property next door, which will keep it in the neighborhood.

LOCATION MAP

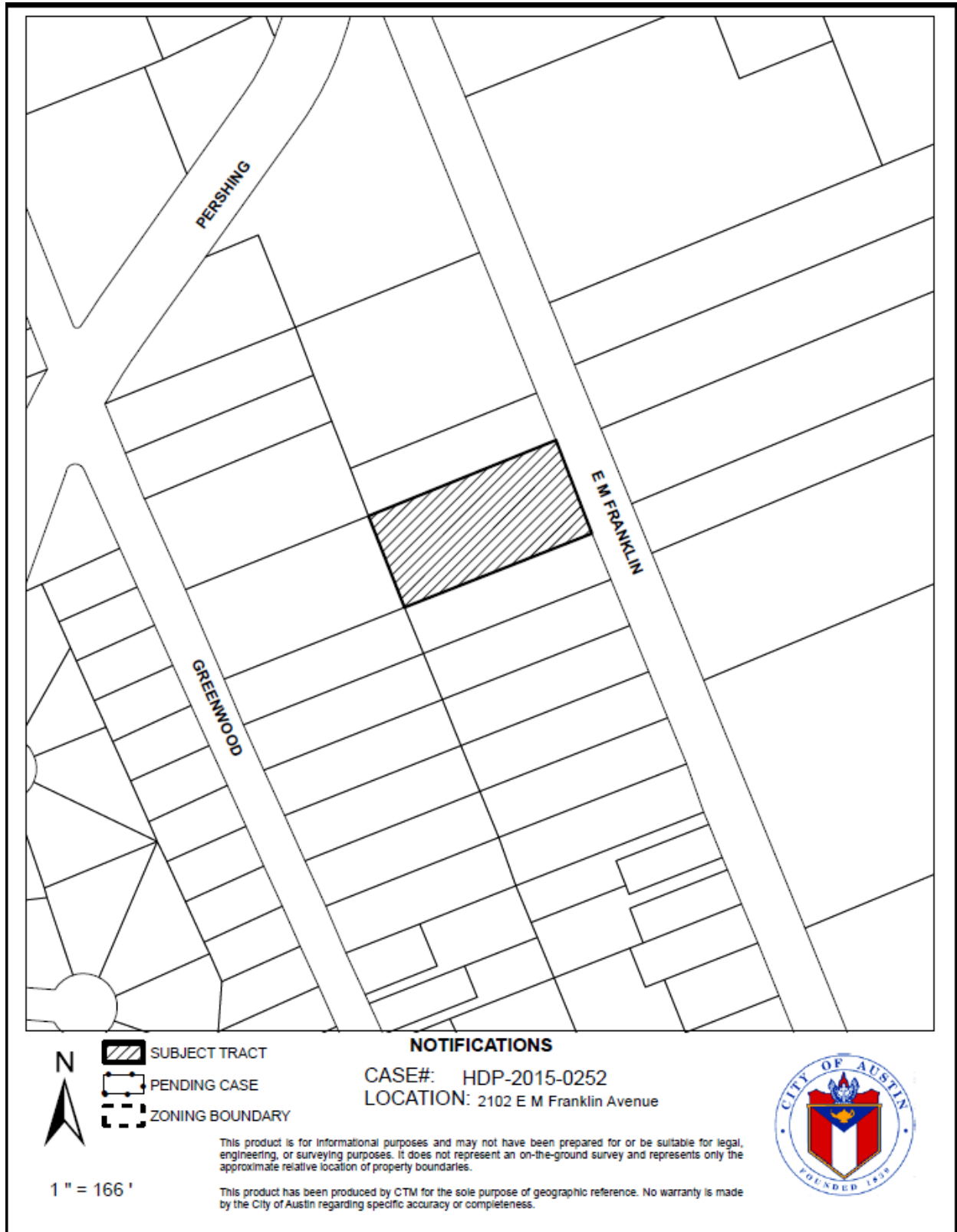

2102 E.M. Franklin Avenue
ca. 1940



OCCUPANCY HISTORY
2102 E.M. Franklin Avenue

By City Historic Preservation Office
April, 2015

NOTE: All directory listings are for 2102 Redwood Avenue, the former name of the street.

1992	Verna Marx, owner Retired
1985-86	Verna Marx, owner Retired
1981	Verna Marx, owner Retired
1977	Verna Marx, owner Widow, Jesse W. Marx Babysitter
1973	Verna Marx, owner Widow, Jesse W. Marx Retired
1968	Verna Marx, owner Widow, J.W. Marx Retired
1962	Verna Marx, owner Widow, J.W. Marx No occupation listed
1959	Verna Marx, owner Widow, J.W. Marx No occupation listed
1955	Verna Marx, owner Widow, J.W. Marx No occupation listed
1952	Verna Marx, owner Widow, J.W. Marx No occupation listed NOTE: The address is listed as 1914 Redwood Avenue.
1949	No houses are listed on Redwood Avenue. NOTE: Neither J.W. nor Verna Marx are listed in the directory.

BIOGRAPHICAL NOTES:

Verna Marx, the widow of Jesse W. Marx, (ca. 1948 – ca. 1986)

According to his 1943 death certificate, Jesse Wade Marx was born in 1898 in Burnet, Texas. He operated a fix-it shop. He lived on Route 1, Redwood Street in Austin. Verna Marx was his wife.

~~MARX, Verna, 86, of Austin died Monday. Services 2 p.m. Thursday, Wilke-Amey-Clay Funeral Home. Burial Austin Memorial Park.~~

Death notice for Verna Marx
Austin American-Statesman, January 19, 1994

66
2130

WATER SERVICE PERMIT

Austin, Texas

Received of Mrs J. W. Marx

Address 2102 E. M. Franklin Av

Amount Location, 2102 RED WOOD - AVE Water District

Plumber _____ Size of Tap 78X3/4

Date of Connection Tropic A # 3437826

Size of Tap Made _____

Size Service Made _____

Size Main Tapped _____

From Front Prop. Line to Curb Cock _____

From Prop. Line to Curb Cock _____

Location of Meter _____

Type of Box _____

Depth of Main in St. _____

Depth of Service Line _____

From Curb Cock to Tap on Main _____

Checked by Engr. Dept. 4-1-59 137

INDEXED

No. Fittings	Corp. Cock	Elbow	St. Elbow	Bushing	Reducer	Pipe	Lead Comp.	Nipples	Union	Plug	Tee	Stop	Box	Lid	Valves	Job No.	Req. No.

Water service permit to Verna Marx for this address (1954)