

SUBDIVISION REVIEW SHEET

C17
/

CASE NO.: C8-2015-0131.0A

P.C. DATE: June 23, 2015

SUBDIVISION NAME: ST. Stephen's Square Phase Two

AREA: 3.43

LOT(S): 1

OWNER/APPLICANT: (Carianne Shulte)
(Christopher R. Chollet)
(Luke & Peni Ellis)

AGENT: Catalyst Engineering Group
(Timothy J. Moltz, P.E.)

ADDRESS OF SUBDIVISION: 4905 PECAN SPRINGS RD

GRIDS: M24

COUNTY: Travis

WATERSHED: Little Walnut Creek

JURISDICTION: Full-Purpose

EXISTING ZONING: N/A

MUD: N/A

NEIGHBORHOOD PLAN: MLK

PROPOSED LAND USE: Commercial Multi Family

ADMINISTRATIVE WAIVERS:

VARIANCES: None

SIDEWALKS: Sidewalks will be provided on both sides of all internal streets and the subdivision side of boundary streets.

DEPARTMENT COMMENTS: The request is for approval of the ST. Stephen's Square Phase Two. The proposed plat is composed of 1 lot on 3.43 acres.

STAFF RECOMMENDATION: The staff recommends disapproval of the plat. This plat does not meet all applicable State and City of Austin LDC requirements.

PLANNING COMMISSION / ZONING AND PLATTING ACTION:

C17
1/2

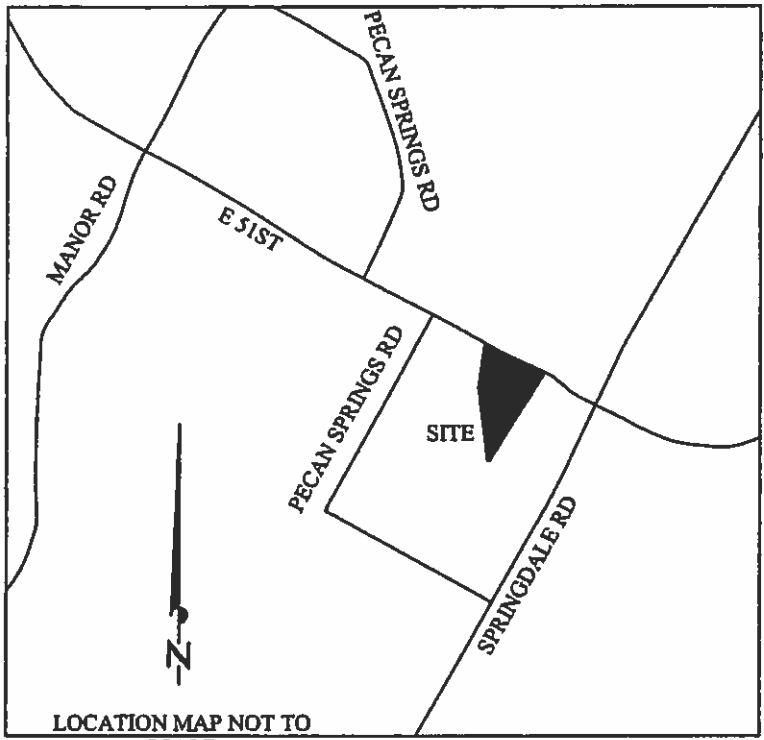

PC
11369524