

**SUBDIVISION REVIEW SHEET**

C35/1

**CASE NO.:** C8-2015-0125

**ZAP DATE:** July 7, 2015

**SUBDIVISION NAME:** Gracy Woods

**AREA:** 5.51

**LOT(S):** 26

**OWNER/APPLICANT:** Gracy Receiver (Mary Walker)

**AGENT:** Texas Engineering Solutions (James Hagen, P.E)

**ADDRESS OF SUBDIVISION:** 1601-1/2 KATHY LYNN CT

**GRIDS:** ML33

**COUNTY:** Travis

**WATERSHED:** Walnut Creek

**JURISDICTION:** Full-Purpose

**EXISTING ZONING:** N/A

**MUD:** N/A

**NEIGHBORHOOD PLAN:** N/A

**PROPOSED LAND USE:** SF

**ADMINISTRATIVE WAIVERS:**

**VARIANCES:** None

**SIDEWALKS:** Sidewalks will be provided on both sides of all internal streets and the subdivision side of boundary streets.

**DEPARTMENT COMMENTS:** The request is for approval of the Gracy Woods. The proposed plat is composed of 26 lots on 5.51 acres.

**STAFF RECOMMENDATION:** The staff recommends disapproval of the plat. This plat does not meet all applicable State and City of Austin LDC requirements.

**PLANNING COMMISSION// ZONING AND PLATTING ACTION:**

**Location Map**  
Gracy Farms



C35/2

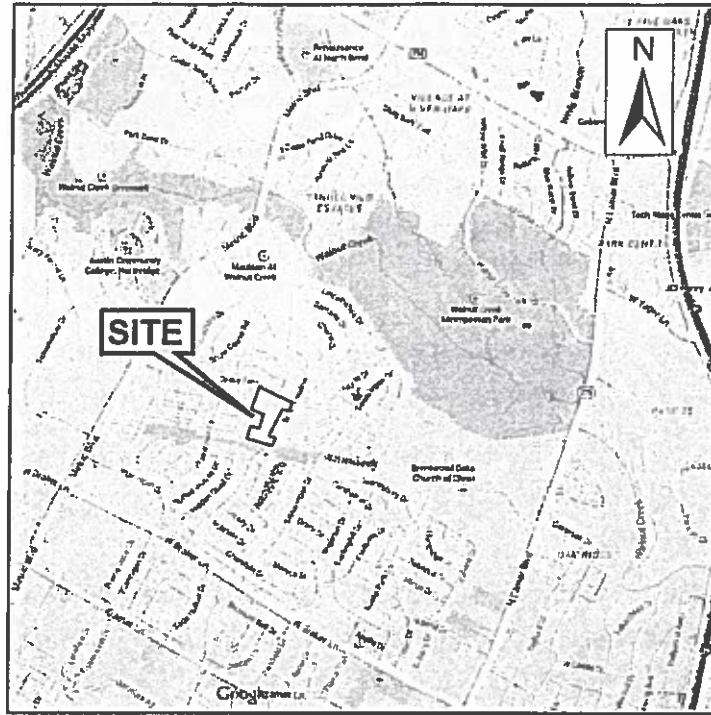

**DRAWING NOT TO SCALE**

ZAP  
#11367827