

C15
/

SUBDIVISION REVIEW SHEET

CASE NO.: C8-2015-0144.0A

P.C. DATE: 7/28/15

SUBDIVISION NAME: East End Partners Subdivision

AREA: 0.9785

LOT(S): 2

OWNER/APPLICANT: Long Real Estate Holdings, LLC (Paul Long)

AGENT: Land Answers, Inc. (Jim Wittliff)

ADDRESS OF SUBDIVISION: 501 Cater Dr.

GRIDS: MH22

COUNTY:

WATERSHED: Town Lake

JURISDICTION: Full-Purpose

EXISTING ZONING:

MUD: N/A

NEIGHBORHOOD PLAN: Zilker

PROPOSED LAND USE: SF

ADMINISTRATIVE WAIVERS: None

VARIANCES: None

SIDEWALKS: Sidewalks will be provided on both sides of all internal streets and the subdivision side of boundary streets.

DEPARTMENT COMMENTS: The request is for approval of the East End Partners Subdivision. The proposed plat is composed of 2 lots on 0.9785 acres.

STAFF RECOMMENDATION: The staff recommends disapproval of the plat. This plat does not meet all applicable State and City of Austin LDC requirements.

ZONING AND PLATTING ACTION:

CITY OF AUSTIN DEVELOPMENT WEB MAP

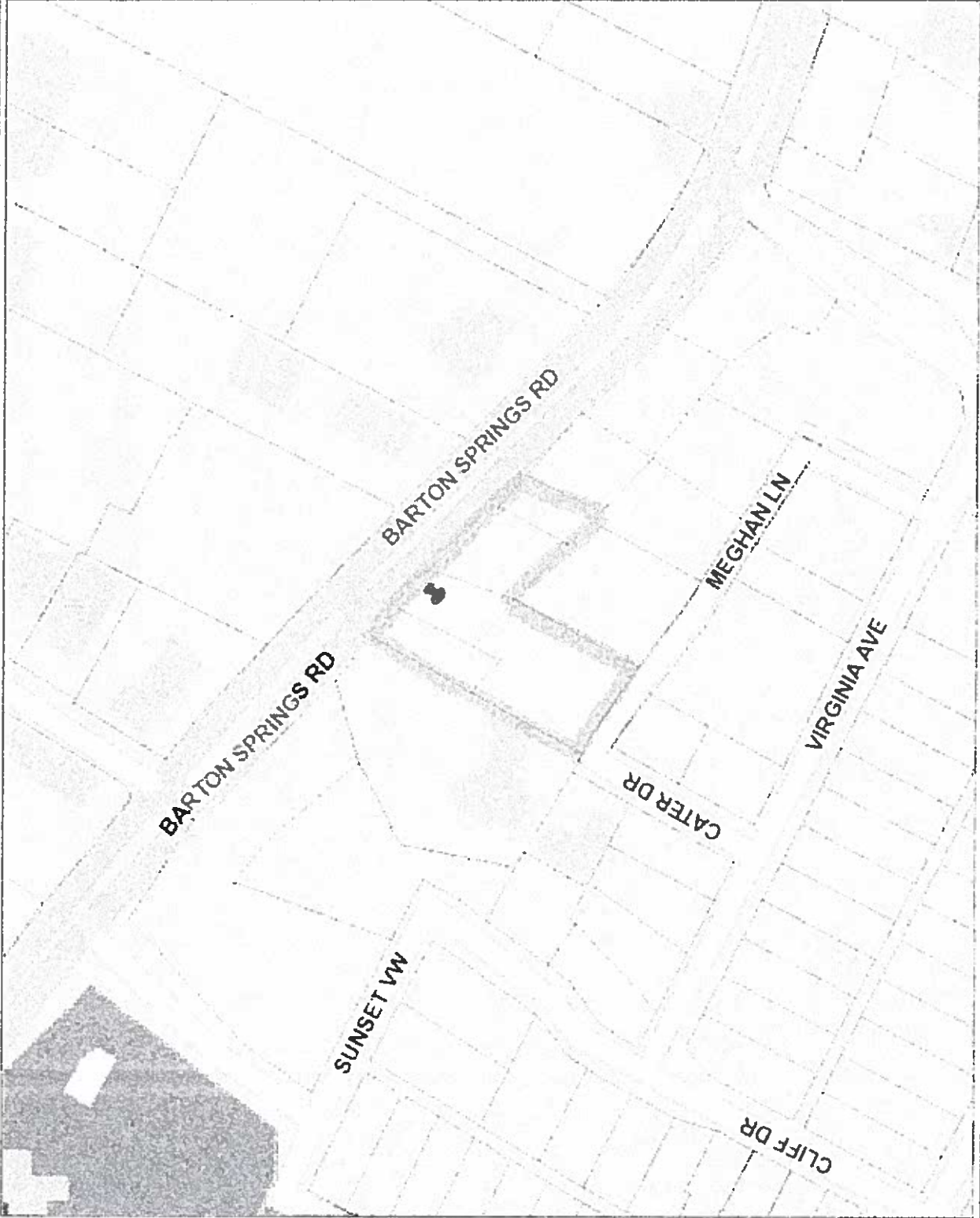

- Legend**
- Lot Lines
 - Streets
 - Building Footprints
 - Named Creeks
 - Lakes and Rivers
 - Parks
 - County
 - Lot Line

Handwritten: 2778
13388
C/S 1/2

THIS PRODUCT IS FOR INFORMATIONAL PURPOSES AND MAY NOT HAVE BEEN PREPARED FOR OR BE SUITABLE FOR LEGAL, ENGINEERING, OR SURVEYING PURPOSES. IT DOES NOT REPRESENT AN ON-THE-GROUND SURVEY AND REPRESENTS ONLY THE APPROXIMATE RELATIVE LOCATION OF PROPERTY BOUNDARIES. THIS PRODUCT HAS BEEN PRODUCED BY THE CITY OF AUSTIN FOR THE SOLE PURPOSE OF GEOGRAPHIC REFERENCE. NO WARRANTY IS MADE BY THE CITY OF AUSTIN REGARDING SPECIFIC ACCURACY OR COMPLETENESS.