

C10
/

SUBDIVISION REVIEW SHEET

CASE NO.: C8-85-086.02.13A

ZAP DATE: September 15, 2015,
August 18, 2015

SUBDIVISION NAME: Springfield Section 8A & 8B

AREA: 24.944 acres

LOT(S): 120

OWNER/APPLICANT: RKS Texas Investments LLC
(Rick Sheldon)

AGENT: Pape-Dawson Engineers
(Dustin Goss)

ADDRESS OF SUBDIVISION: E. William Cannon Drive

GRIDS: J/K-13/14

COUNTY: Travis

WATERSHED: Onion Creek

JURISDICTION: Full Purpose

EXISTING ZONING: SF-2

DISTRICT: 2

PROPOSED LAND USE: Residential, Open Space

SIDEWALKS: Sidewalks will be provided along both sides of all internal streets of the subdivision prior to the lots being occupied.

DEPARTMENT COMMENTS: The request is for approval of the final plat out of an approved preliminary, namely, Springfield Section 8A & 8B. The proposed plat is composed of 120 lots on 24.944 acres.

STAFF RECOMMENDATION: The staff recommends approval of the final plat. This final plat meets all applicable City of Austin and State Local Government code requirements.

ZONING AND PLATTING ACTION: 8/18/15: Postponed to 9/15/15 (10-0)

CASE MANAGER: Sylvia Limon
E-mail: Sylvia.limon@austintexas.gov

PHONE: 512-974-2767

C19/2



Date: Feb. 28, 2011, 2:10pm User: GJ. DSW
 File: C:\Users\GJ\Documents\Projects\Springfield\Springfield.dwg
 Plot: 11/11/2011 10:50 AM

JOB NO. 50718-00
 DATE 02/22/2011
 DRAWN BY BRADY, GJ
 SHEET **EXHIBIT 1**

**SPRINGFIELD 7, 8 & 9
 SUBDIVISION**
EXHIBIT 1: VICINITY MAP

**PAPE-DAWSON
 ENGINEERS**

2000 BROAD CREEK BLVD | AUSTIN, TEXAS 78757 | PHONE: 512.434.8711
 SUITE 220 WEST | FAX: 512.438.8867
 TEXAS BOARD OF PROFESSIONAL ENGINEERS, FIRM REGISTRATION # 470

THIS DOCUMENT HAS BEEN PRODUCED FROM MATERIAL THAT WAS STORED AND/OR TRANSMITTED ELECTRONICALLY AND MAY HAVE BEEN IMPAIRED BY ALTERATION. RELY ONLY ON FINAL HARD-COPY MATERIALS BEARING AN ORIGINALITY SYMBOL, SIGNATURE AND SEAL.

C10/3

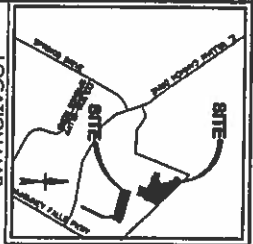

LINE	BEARING	LENGTH
1	N 1/4° E	36.72'
2	N 89° 59' 57" W	11.84'
3	S 89° 59' 57" E	11.84'
4	S 1/4° W	36.72'
5	S 89° 59' 57" E	11.84'
6	N 1/4° E	36.72'
7	N 89° 59' 57" W	11.84'
8	S 89° 59' 57" E	11.84'
9	S 1/4° W	36.72'
10	S 89° 59' 57" E	11.84'
11	N 1/4° E	36.72'
12	N 89° 59' 57" W	11.84'
13	S 89° 59' 57" E	11.84'
14	S 1/4° W	36.72'
15	S 89° 59' 57" E	11.84'
16	N 1/4° E	36.72'
17	N 89° 59' 57" W	11.84'
18	S 89° 59' 57" E	11.84'
19	S 1/4° W	36.72'
20	S 89° 59' 57" E	11.84'
21	N 1/4° E	36.72'
22	N 89° 59' 57" W	11.84'
23	S 89° 59' 57" E	11.84'
24	S 1/4° W	36.72'
25	S 89° 59' 57" E	11.84'
26	N 1/4° E	36.72'
27	N 89° 59' 57" W	11.84'
28	S 89° 59' 57" E	11.84'
29	S 1/4° W	36.72'
30	S 89° 59' 57" E	11.84'
31	N 1/4° E	36.72'
32	N 89° 59' 57" W	11.84'
33	S 89° 59' 57" E	11.84'
34	S 1/4° W	36.72'
35	S 89° 59' 57" E	11.84'
36	N 1/4° E	36.72'
37	N 89° 59' 57" W	11.84'
38	S 89° 59' 57" E	11.84'
39	S 1/4° W	36.72'
40	S 89° 59' 57" E	11.84'
41	N 1/4° E	36.72'
42	N 89° 59' 57" W	11.84'
43	S 89° 59' 57" E	11.84'
44	S 1/4° W	36.72'
45	S 89° 59' 57" E	11.84'
46	N 1/4° E	36.72'
47	N 89° 59' 57" W	11.84'
48	S 89° 59' 57" E	11.84'
49	S 1/4° W	36.72'
50	S 89° 59' 57" E	11.84'
51	N 1/4° E	36.72'
52	N 89° 59' 57" W	11.84'
53	S 89° 59' 57" E	11.84'
54	S 1/4° W	36.72'
55	S 89° 59' 57" E	11.84'
56	N 1/4° E	36.72'
57	N 89° 59' 57" W	11.84'
58	S 89° 59' 57" E	11.84'
59	S 1/4° W	36.72'
60	S 89° 59' 57" E	11.84'
61	N 1/4° E	36.72'
62	N 89° 59' 57" W	11.84'
63	S 89° 59' 57" E	11.84'
64	S 1/4° W	36.72'
65	S 89° 59' 57" E	11.84'
66	N 1/4° E	36.72'
67	N 89° 59' 57" W	11.84'
68	S 89° 59' 57" E	11.84'
69	S 1/4° W	36.72'
70	S 89° 59' 57" E	11.84'
71	N 1/4° E	36.72'
72	N 89° 59' 57" W	11.84'
73	S 89° 59' 57" E	11.84'
74	S 1/4° W	36.72'
75	S 89° 59' 57" E	11.84'
76	N 1/4° E	36.72'
77	N 89° 59' 57" W	11.84'
78	S 89° 59' 57" E	11.84'
79	S 1/4° W	36.72'
80	S 89° 59' 57" E	11.84'
81	N 1/4° E	36.72'
82	N 89° 59' 57" W	11.84'
83	S 89° 59' 57" E	11.84'
84	S 1/4° W	36.72'
85	S 89° 59' 57" E	11.84'
86	N 1/4° E	36.72'
87	N 89° 59' 57" W	11.84'
88	S 89° 59' 57" E	11.84'
89	S 1/4° W	36.72'
90	S 89° 59' 57" E	11.84'
91	N 1/4° E	36.72'
92	N 89° 59' 57" W	11.84'
93	S 89° 59' 57" E	11.84'
94	S 1/4° W	36.72'
95	S 89° 59' 57" E	11.84'
96	N 1/4° E	36.72'
97	N 89° 59' 57" W	11.84'
98	S 89° 59' 57" E	11.84'
99	S 1/4° W	36.72'
100	S 89° 59' 57" E	11.84'

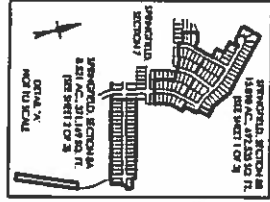

LINE	BEARING	LENGTH
1	N 1/4° E	36.72'
2	N 89° 59' 57" W	11.84'
3	S 89° 59' 57" E	11.84'
4	S 1/4° W	36.72'
5	S 89° 59' 57" E	11.84'
6	N 1/4° E	36.72'
7	N 89° 59' 57" W	11.84'
8	S 89° 59' 57" E	11.84'
9	S 1/4° W	36.72'
10	S 89° 59' 57" E	11.84'
11	N 1/4° E	36.72'
12	N 89° 59' 57" W	11.84'
13	S 89° 59' 57" E	11.84'
14	S 1/4° W	36.72'
15	S 89° 59' 57" E	11.84'
16	N 1/4° E	36.72'
17	N 89° 59' 57" W	11.84'
18	S 89° 59' 57" E	11.84'
19	S 1/4° W	36.72'
20	S 89° 59' 57" E	11.84'
21	N 1/4° E	36.72'
22	N 89° 59' 57" W	11.84'
23	S 89° 59' 57" E	11.84'
24	S 1/4° W	36.72'
25	S 89° 59' 57" E	11.84'
26	N 1/4° E	36.72'
27	N 89° 59' 57" W	11.84'
28	S 89° 59' 57" E	11.84'
29	S 1/4° W	36.72'
30	S 89° 59' 57" E	11.84'
31	N 1/4° E	36.72'
32	N 89° 59' 57" W	11.84'
33	S 89° 59' 57" E	11.84'
34	S 1/4° W	36.72'
35	S 89° 59' 57" E	11.84'
36	N 1/4° E	36.72'
37	N 89° 59' 57" W	11.84'
38	S 89° 59' 57" E	11.84'
39	S 1/4° W	36.72'
40	S 89° 59' 57" E	11.84'
41	N 1/4° E	36.72'
42	N 89° 59' 57" W	11.84'
43	S 89° 59' 57" E	11.84'
44	S 1/4° W	36.72'
45	S 89° 59' 57" E	11.84'
46	N 1/4° E	36.72'
47	N 89° 59' 57" W	11.84'
48	S 89° 59' 57" E	11.84'
49	S 1/4° W	36.72'
50	S 89° 59' 57" E	11.84'
51	N 1/4° E	36.72'
52	N 89° 59' 57" W	11.84'
53	S 89° 59' 57" E	11.84'
54	S 1/4° W	36.72'
55	S 89° 59' 57" E	11.84'
56	N 1/4° E	36.72'
57	N 89° 59' 57" W	11.84'
58	S 89° 59' 57" E	11.84'
59	S 1/4° W	36.72'
60	S 89° 59' 57" E	11.84'
61	N 1/4° E	36.72'
62	N 89° 59' 57" W	11.84'
63	S 89° 59' 57" E	11.84'
64	S 1/4° W	36.72'
65	S 89° 59' 57" E	11.84'
66	N 1/4° E	36.72'
67	N 89° 59' 57" W	11.84'
68	S 89° 59' 57" E	11.84'
69	S 1/4° W	36.72'
70	S 89° 59' 57" E	11.84'
71	N 1/4° E	36.72'
72	N 89° 59' 57" W	11.84'
73	S 89° 59' 57" E	11.84'
74	S 1/4° W	36.72'
75	S 89° 59' 57" E	11.84'
76	N 1/4° E	36.72'
77	N 89° 59' 57" W	11.84'
78	S 89° 59' 57" E	11.84'
79	S 1/4° W	36.72'
80	S 89° 59' 57" E	11.84'
81	N 1/4° E	36.72'
82	N 89° 59' 57" W	11.84'
83	S 89° 59' 57" E	11.84'
84	S 1/4° W	36.72'
85	S 89° 59' 57" E	11.84'
86	N 1/4° E	36.72'
87	N 89° 59' 57" W	11.84'
88	S 89° 59' 57" E	11.84'
89	S 1/4° W	36.72'
90	S 89° 59' 57" E	11.84'
91	N 1/4° E	36.72'
92	N 89° 59' 57" W	11.84'
93	S 89° 59' 57" E	11.84'
94	S 1/4° W	36.72'
95	S 89° 59' 57" E	11.84'
96	N 1/4° E	36.72'
97	N 89° 59' 57" W	11.84'
98	S 89° 59' 57" E	11.84'
99	S 1/4° W	36.72'
100	S 89° 59' 57" E	11.84'

SPRINGFIELD, SECTION 8A & 8B
SUBDIVISION PLAT
 OF
SANTIAGO DEL VALLE QUARTER
 ABSTRACT NO. 24
 TARRANT COUNTY, TEXAS

OWNER: MRS. TEXAS INVESTMENTS, LP
 17784 AGNES ST.
 (DOC. PRODUCTION D.P.R.)

OWNER: STATE OF TEXAS
 574 000 AGNES ST.
 (DOC. 1181, POL. 1982-1988 D.P.R.)

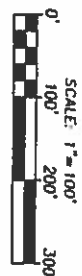
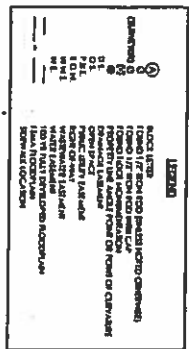

ALL DISTANCES ARE MEASURED ALONG THE CENTER LINE OF THE ROAD OR RAILROAD UNLESS OTHERWISE SPECIFIED.

ALL DISTANCES ARE MEASURED ALONG THE CENTER LINE OF THE ROAD OR RAILROAD UNLESS OTHERWISE SPECIFIED.

ALL DISTANCES ARE MEASURED ALONG THE CENTER LINE OF THE ROAD OR RAILROAD UNLESS OTHERWISE SPECIFIED.

SHEET 1 OF 3

CB-85-086.02.13A



