

**SUBDIVISION REVIEW SHEET**

**CASE NO.:** C8-2015-0202.0A

**PC DATE:** 10/13/15

**SUBDIVISION NAME:** Crumley Subdivision, Amended Plat of Lot 1

**AREA:** .4781 acres

**LOT(S):** 2

**OWNER/APPLICANT:** (Carole Crumley)

**AGENT:** Live Oak Surveying (Phylliss Woodley)

**ADDRESS OF SUBDIVISION:** 1137 Lott Ave.

**GRIDS:** MM22

**COUNTY:**

**WATERSHED:** Fort Branch

**JURISDICTION:** Full-Purpose

**EXISTING ZONING:**

**MUD:** N/A

**NEIGHBORHOOD PLAN:** MLK-183

**PROPOSED LAND USE:** Single Family

**ADMINISTRATIVE WAIVERS:** None

**VARIANCES:** None

**SIDEWALKS:** Sidewalks will be provided on both sides of all internal streets and the subdivision side of boundary streets.

**DEPARTMENT COMMENTS:** The request is for the approval of Crumley Subdivision, Amended Plat of Lot 1. The proposed plat is composed of 2 lots on .4781 acres.

**STAFF RECOMMENDATION:** The staff recommends disapproval of the plat. This plat does not meet all applicable State and City of Austin LDC requirements.

**PLANNING COMMISSION ACTION:**

1139 & 1137 LOTT AVENUE  
LOCATION MAP

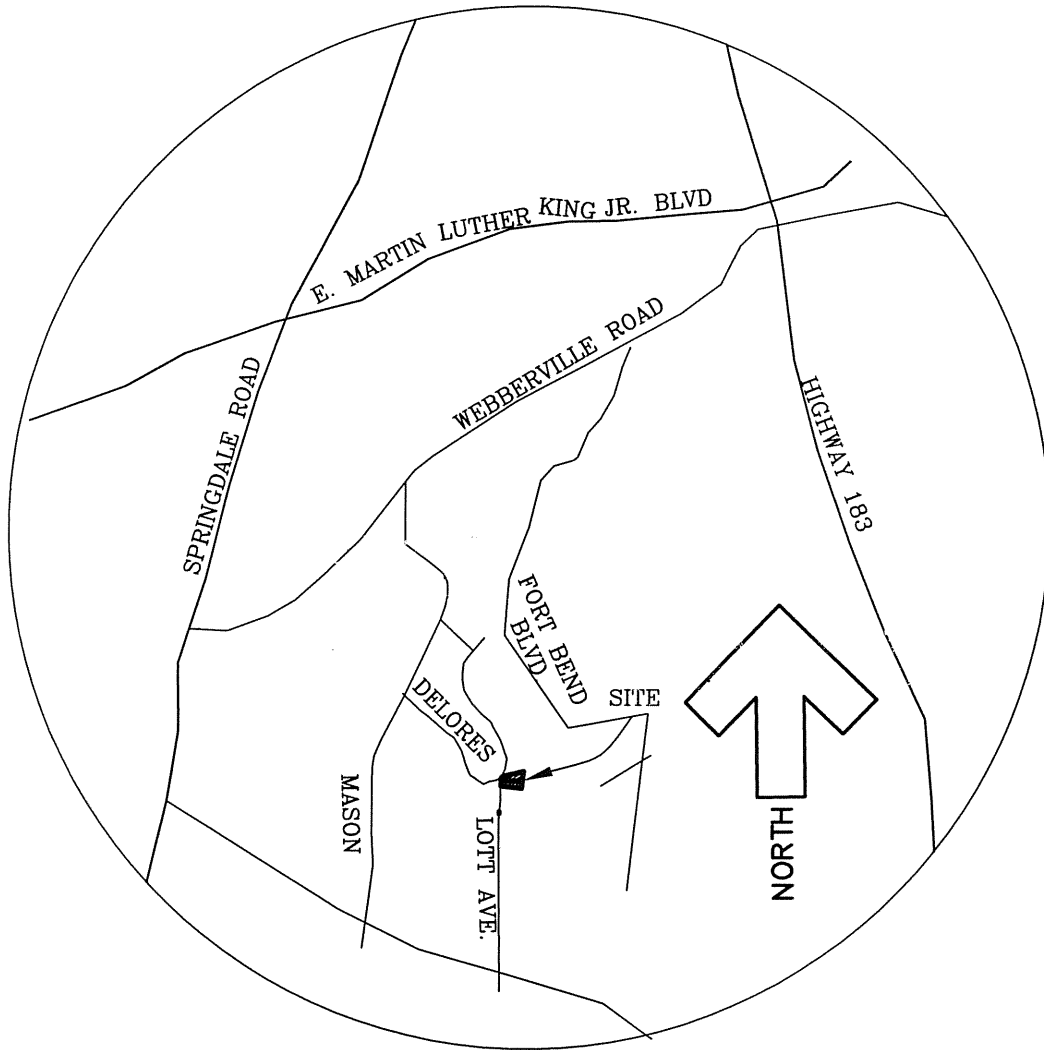

PC 11417923

NOT TO SCALE