

**SUBDIVISION REVIEW SHEET**

**CASE NO.:** C8-2015-0216.0A

**PC DATE:** 10/27/15

**SUBDIVISION NAME:** 8611 Centre Subdivision

**AREA:** 2.316 acres

**LOT(S):** 1

**OWNER/APPLICANT:** (Gerald Kucera)

**AGENT:** Thrower Design (A. Ron Thrower)

**ADDRESS OF SUBDIVISION:** 8611 N Mopac Expressway

**GRIDS:** MJ31

**COUNTY:**

**WATERSHED:** Shoal Creek

**JURISDICTION:** Full-Purpose

**EXISTING ZONING:**

**MUD:** N/A

**NEIGHBORHOOD PLAN:** North Shoal Creek

**PROPOSED LAND USE:** Commercial/Office

**ADMINISTRATIVE WAIVERS:** None

**VARIANCES:** None

**SIDEWALKS:** Sidewalks will be provided on both sides of all internal streets and the subdivision side of boundary streets.

**DEPARTMENT COMMENTS:** The request is for the approval of 8611 Centre Subdivision. The proposed plat is composed of 1 lot on 2.316 acres.

**STAFF RECOMMENDATION:** The staff recommends disapproval of the plat. This plat does not meet all applicable State and City of Austin LDC requirements.

**PLANNING COMMISSION ACTION:**

8611 N. MOPAC EXPRESSWAY

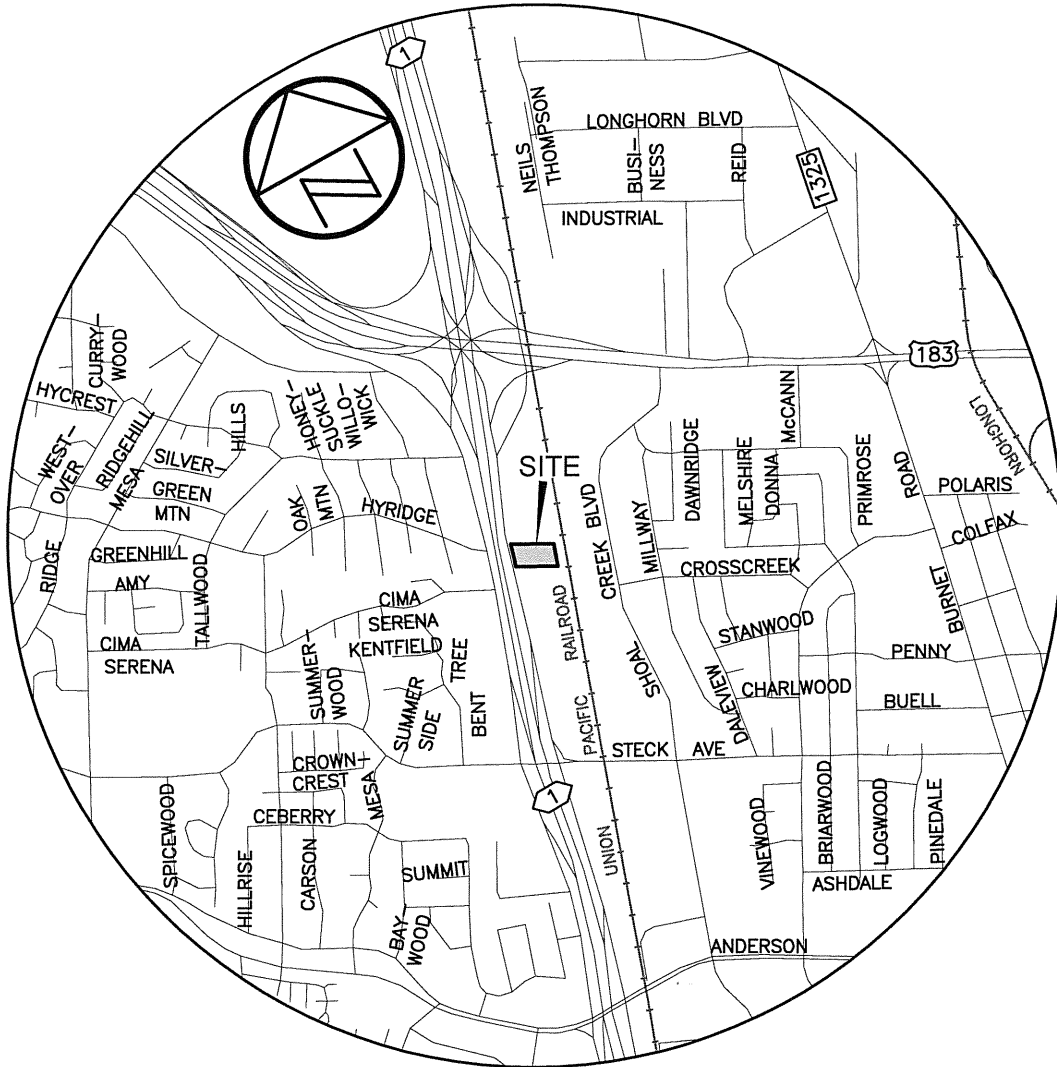

LOCATION MAP  
N.T.S.

PC  
11424924