

SUBDIVISION REVIEW SHEET**CASE NO.:** C8J-2015-0229.0A**ZAP DATE:** 11/17/15**SUBDIVISION NAME:** Gelfer Subdivision**AREA:** 10.9 acres**LOT(S):** 3**OWNER/APPLICANT:** Cobalt Companies, LLC (Zack Gelfer)**AGENT:** Brown & Gay Engineers (Steven Buffum)**ADDRESS OF SUBDIVISION:** 11402 Rimrock Trail**GRIDS:** WY17**COUNTY:****WATERSHED:** Slaughter Creek**JURISDICTION:** 5-Mile ETJ**EXISTING ZONING:****MUD:** N/A**NEIGHBORHOOD PLAN:****PROPOSED LAND USE:** Single Family**ADMINISTRATIVE WAIVERS:** None**VARIANCES:** None**SIDEWALKS:** Sidewalks will be provided on both sides of all internal streets and the subdivision side of boundary streets.**DEPARTMENT COMMENTS:** The request is for the approval of Gelfer Subdivision. The proposed plat is composed of 3 lots on 10.9 acres.**STAFF RECOMMENDATION:** The staff recommends disapproval of the plat. This plat does not meet all applicable State and City of Austin LDC requirements.**PLANNING COMMISSION ACTION:**

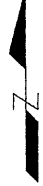

ZAP 11433252

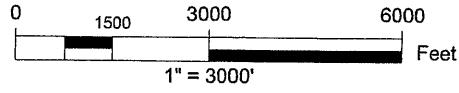
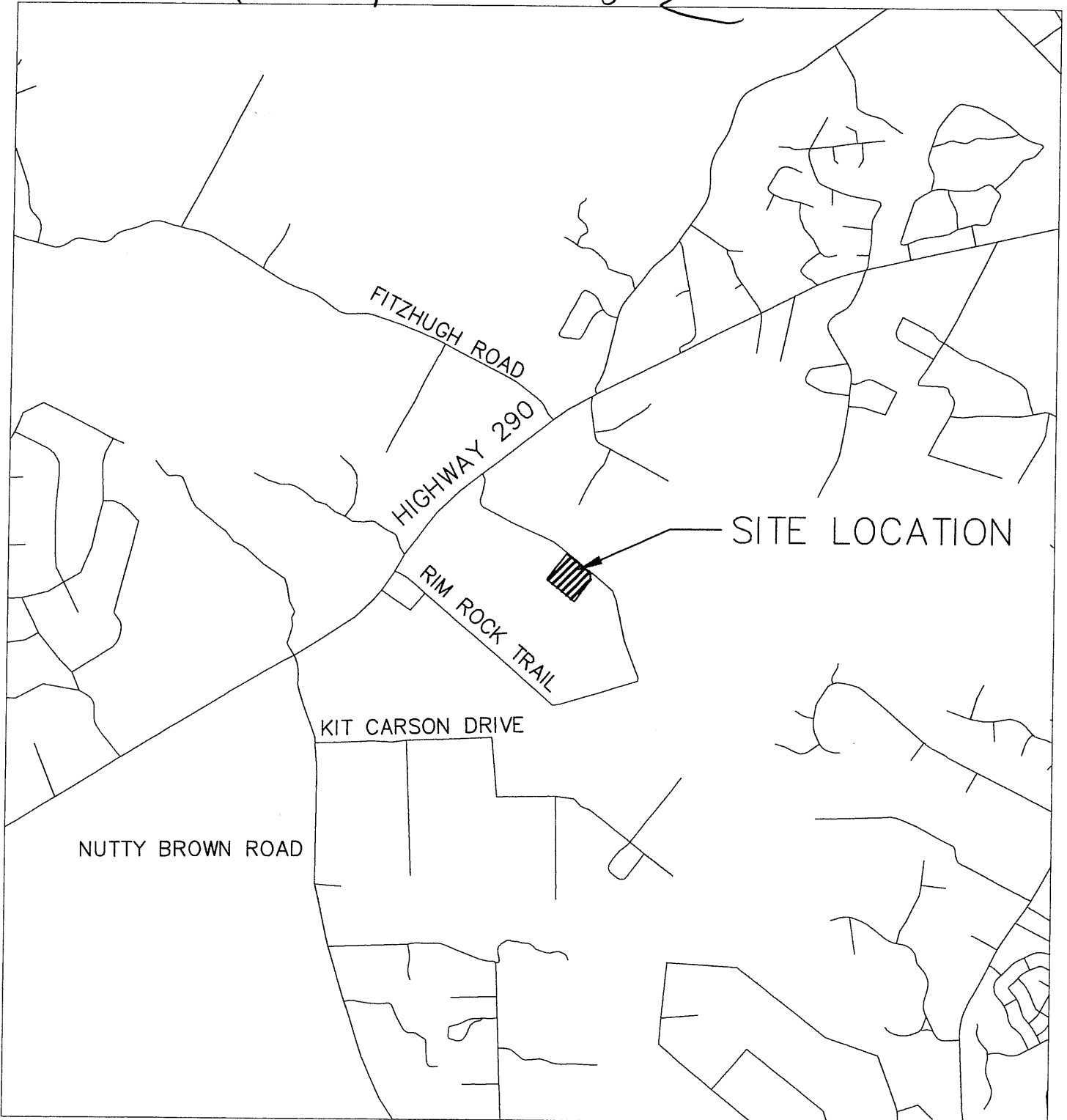

C:\Users\Seifert\Desktop\Rim_Rock_Trail\Site_Location.dwg
1.40 1 LBHS

ASH CREEK HOMES
11402 RIM ROCK TRAIL
AUSTIN, TX

SITE LOCATION MAP

BROWN & GAY ENGINEERS, INC.
7000 NORTH MOPAC, SUITE 330 AUSTIN,
TX 78731 TBPE Registration No. F-1046
TEL: 512-879-0400 www.browngay.com



APPENDIX: A-1

DATE: 7/23/2015

DRAWN BY: AUSTIN SEIFERT