

SUBDIVISION REVIEW SHEET

CASE NO.: C8-2015-0279.0A

P.C. DATE: 1-12-16

SUBDIVISION NAME: Marcy Hill

AREA: .851

LOT(S): 4

OWNER/APPLICANT: Jaomi Brasher

AGENT: Prossner and Associates, Inc. (Kurt Prossner)

ADDRESS OF SUBDIVISION: 1104 MARCY ST

GRIDS: MG18

COUNTY:

WATERSHED: W Bouldin Creek

JURISDICTION: Full Purpose

EXISTING ZONING:

NEIGHBORHOOD PLAN: S Manchaca

PROPOSED LAND USE: SF

ADMINISTRATIVE WAIVERS: None

VARIANCES: None

SIDEWALKS: Sidewalks will be provided on both sides of all internal streets and the subdivision side of boundary streets.

DEPARTMENT COMMENTS: The request is for approval of the Marcy Hill. The proposed plat is composed of 4 lots on .851 acres.

STAFF RECOMMENDATION: The staff recommends disapproval of the plat. This plat does not meet all applicable State and City of Austin LDC requirements.

PLANNING COMMISSION ACTION:

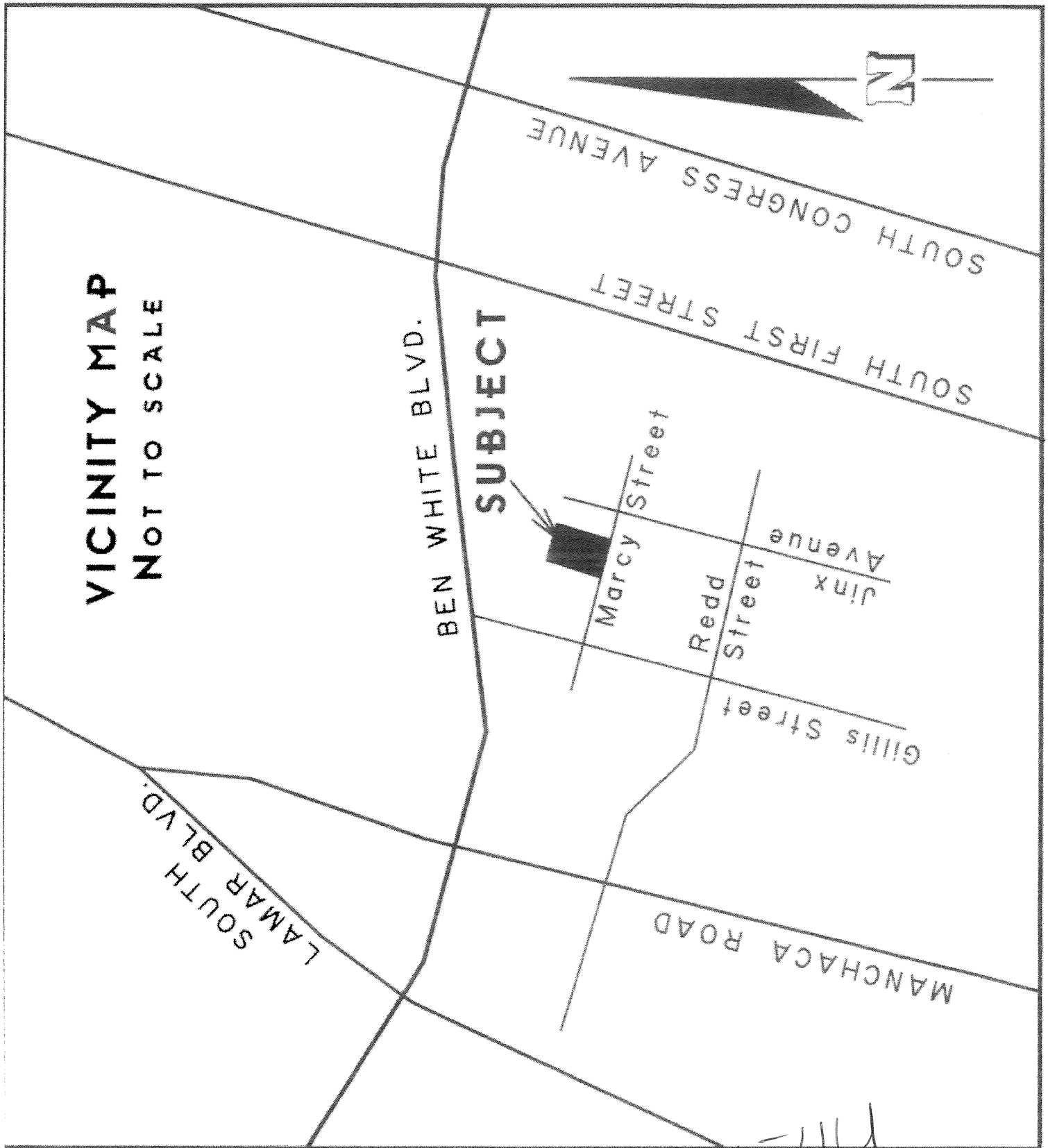

2AP 11401544