

HOLLY  
COMPOSITE  
MAP

UPDATED 5-05-14

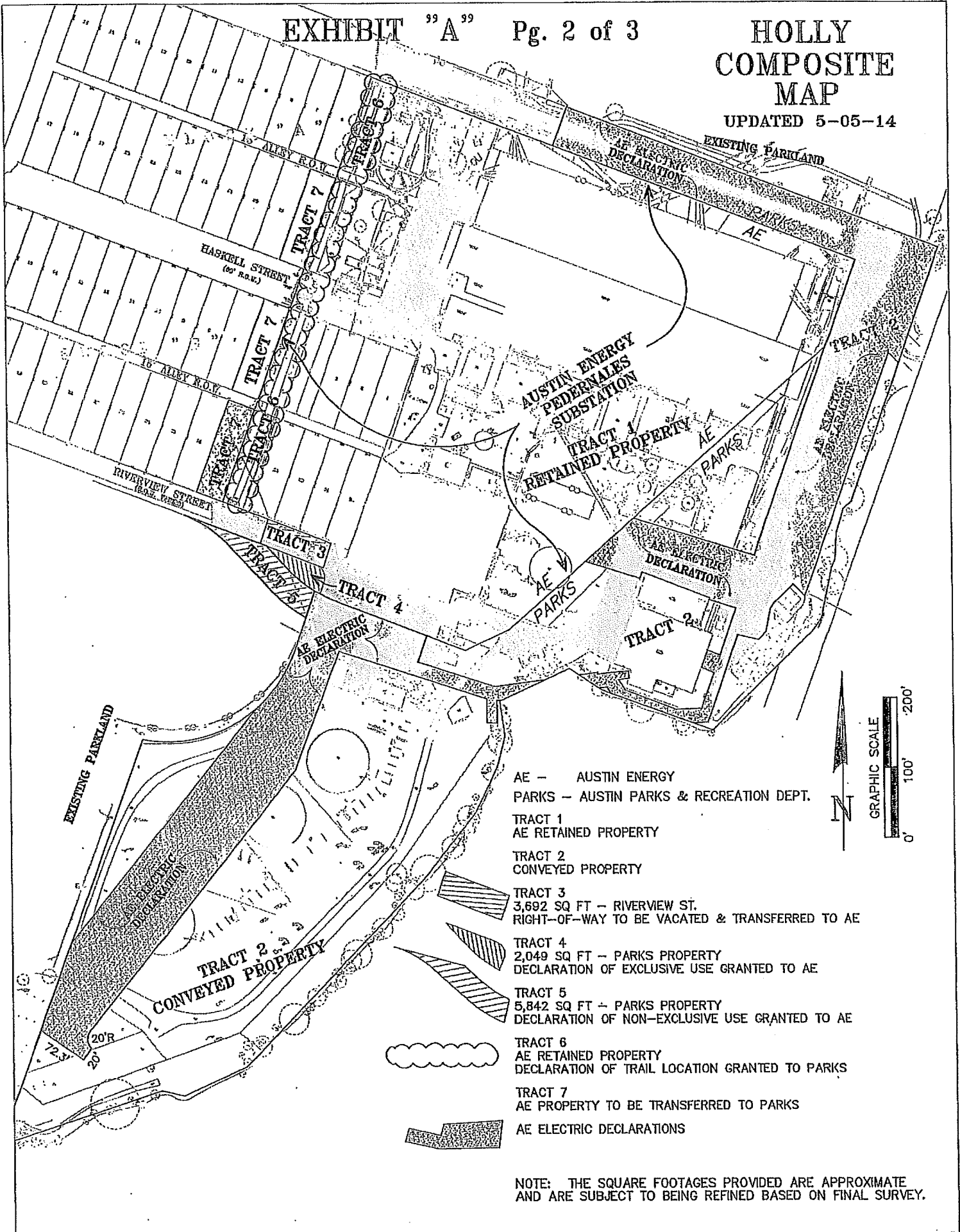

- AE - AUSTIN ENERGY
- PARKS - AUSTIN PARKS & RECREATION DEPT.
- TRACT 1  
AE RETAINED PROPERTY
- TRACT 2  
CONVEYED PROPERTY
- TRACT 3  
3,692 SQ FT - RIVERVIEW ST.  
RIGHT-OF-WAY TO BE VACATED & TRANSFERRED TO AE
- TRACT 4  
2,049 SQ FT - PARKS PROPERTY  
DECLARATION OF EXCLUSIVE USE GRANTED TO AE
- TRACT 5  
5,842 SQ FT - PARKS PROPERTY  
DECLARATION OF NON-EXCLUSIVE USE GRANTED TO AE
- TRACT 6  
AE RETAINED PROPERTY  
DECLARATION OF TRAIL LOCATION GRANTED TO PARKS
- TRACT 7  
AE PROPERTY TO BE TRANSFERRED TO PARKS
- AE ELECTRIC DECLARATIONS

NOTE: THE SQUARE FOOTAGES PROVIDED ARE APPROXIMATE AND ARE SUBJECT TO BEING REFINED BASED ON FINAL SURVEY.