

SUBDIVISION REVIEW SHEET**CASE NO.:** C8-2016-0004.0A**P.C. DATE:** 1-26-16**SUBDIVISION NAME:** Resub of Lot 1, of the Resubdivision of Lots 1 & 2, J.D. Horn Addition**AREA:** 0.62**LOT(S):** 3**AGENT:** Land Answers, Inc. (Jim Wittliff)**ADDRESS OF SUBDIVISION:** 4016 VALLEY VIEW RD**GRIDS:** MG19**COUNTY:** Travis**WATERSHED:** W Bouldin Creek**JURISDICTION:** Full Purpose**EXISTING ZONING:****NEIGHBORHOOD PLAN:** S Lamar**PROPOSED LAND USE:** Commercial Multi Family**ADMINISTRATIVE WAIVERS:** None**VARIANCES:** None**SIDEWALKS:** Sidewalks will be provided on both sides of all internal streets and the subdivision side of boundary streets.**DEPARTMENT COMMENTS:** The request is for approval of the Resub of Lot 1, of the Resubdivision of Lots 1 & 2, J.D. Horn Addition. The proposed plat is composed of 3 lots on 0.62 acres.**STAFF RECOMMENDATION:** The staff recommends disapproval of the plat. This plat does not meet all applicable State and City of Austin LDC requirements.**PLANNING COMMISSION ACTION:**

Travis CAD - Map of Property ID 308121 for Year 2015

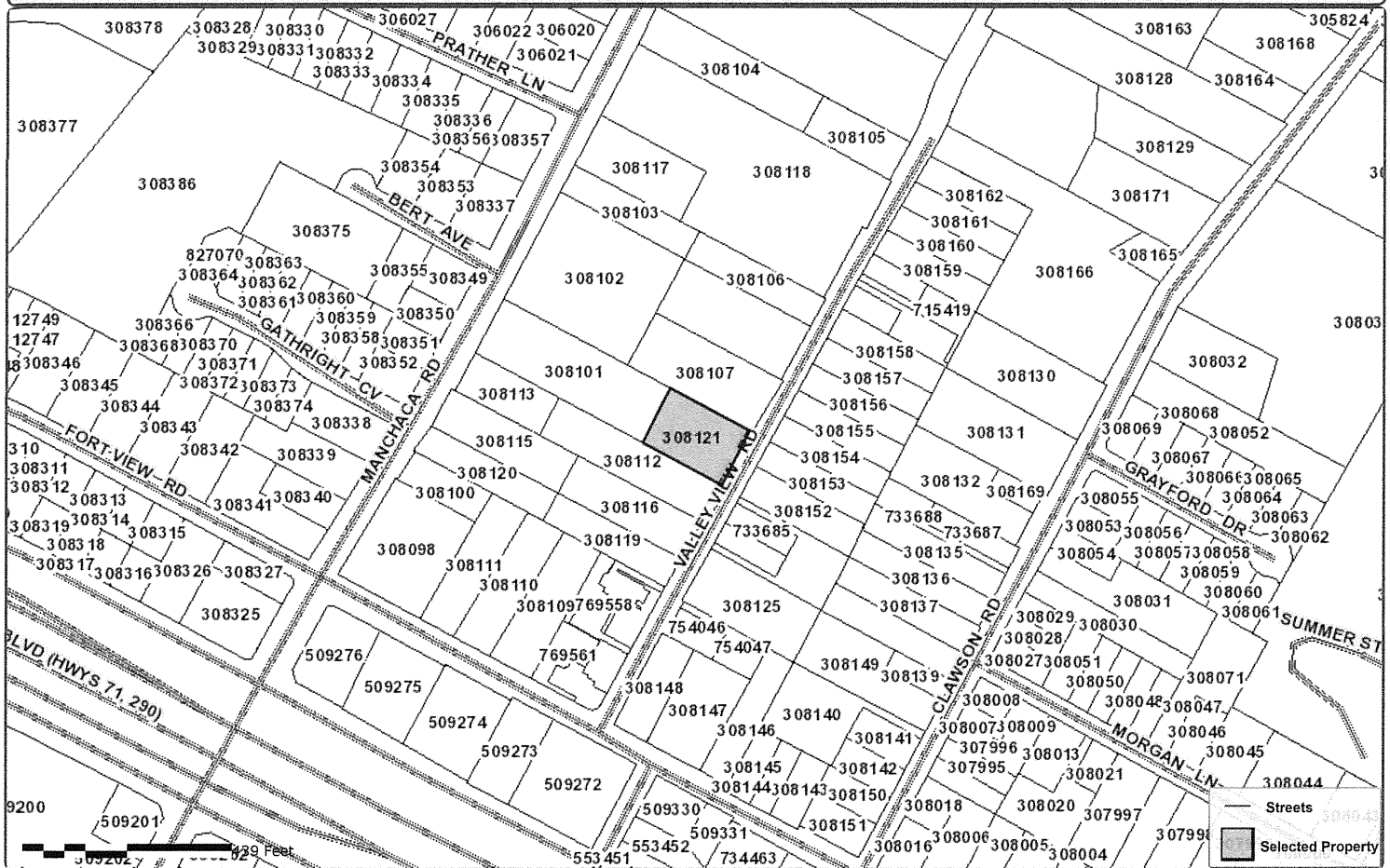

Property Details

Account

Property ID: 308121

Geo ID: 0406100147

Type: Real

Legal Description: LOT 2-3 RESUB OF LTS 1&2 HORNE J D ADDN

Location

Situs Address: 4016 VALLEY VIEW RD TX 78704

Neighborhood: SOUTH LAMAR

Mapsc0: 614W

Jurisdictions: 03, 02, 0A, 2J, 01, 68

Owner

Owner Name: BODHI GROUP LLC

Mailing Address: , 11526 RILEY GREEN RD, FRANKLIN, TX 77856

Property

Appraised Value: \$329,621.00

<http://propaccess.traviscad.org/Map/View/Map/1/308121/2015>

powered by:
PropertyACCESS
 www.trueautomation.com

Map Disclaimer: This tax map was compiled solely for the use of TCAD. Areas depicted by these digital products are approximate, and are not necessarily accurate to mapping, surveying or engineering standards. Conclusions drawn from this information are the responsibility of the user. The TCAD makes no claims, promises or guarantees about the accuracy, completeness or adequacy of this information and expressly disclaims liability for any errors and omissions. The mapped data does not constitute a legal document.