

## SUBDIVISION REVIEW SHEET

**CASE NO.:** C8J-2015-0134.1A

**Z.A.P. DATE:** 2-2-16

**SUBDIVISION NAME:** Preston Park Section One

**AREA:** 22.073

**LOT(S):** 271

**OWNER/APPLICANT:** Zydeco Partners - 1, Ltd.  
(Howard Yancy)

**AGENT:** Thrower Design  
(Ron Thrower)

**ADDRESS OF SUBDIVISION:** 16140 BRATTON LN

**GRIDS:** MM39

**COUNTY:** Travis

**WATERSHED:** Gilleland Creek

**JURISDICTION:** 2 Mile ETJ

**EXISTING ZONING:**

**NEIGHBORHOOD PLAN:**

**PROPOSED LAND USE:** SF

**ADMINISTRATIVE WAIVERS:** None

**VARIANCES:** None

**SIDEWALKS:** Sidewalks will be provided on both sides of all internal streets and the subdivision side of boundary streets.

**DEPARTMENT COMMENTS:** The request is for approval of the Preston Park Section One. The proposed plat is composed of 271 lots on 22.073 acres.

**STAFF RECOMMENDATION:** The staff recommends disapproval of the plat. This plat does not meet all applicable State and City of Austin LDC requirements.

**ZONING AND PLATTING ACTION:**

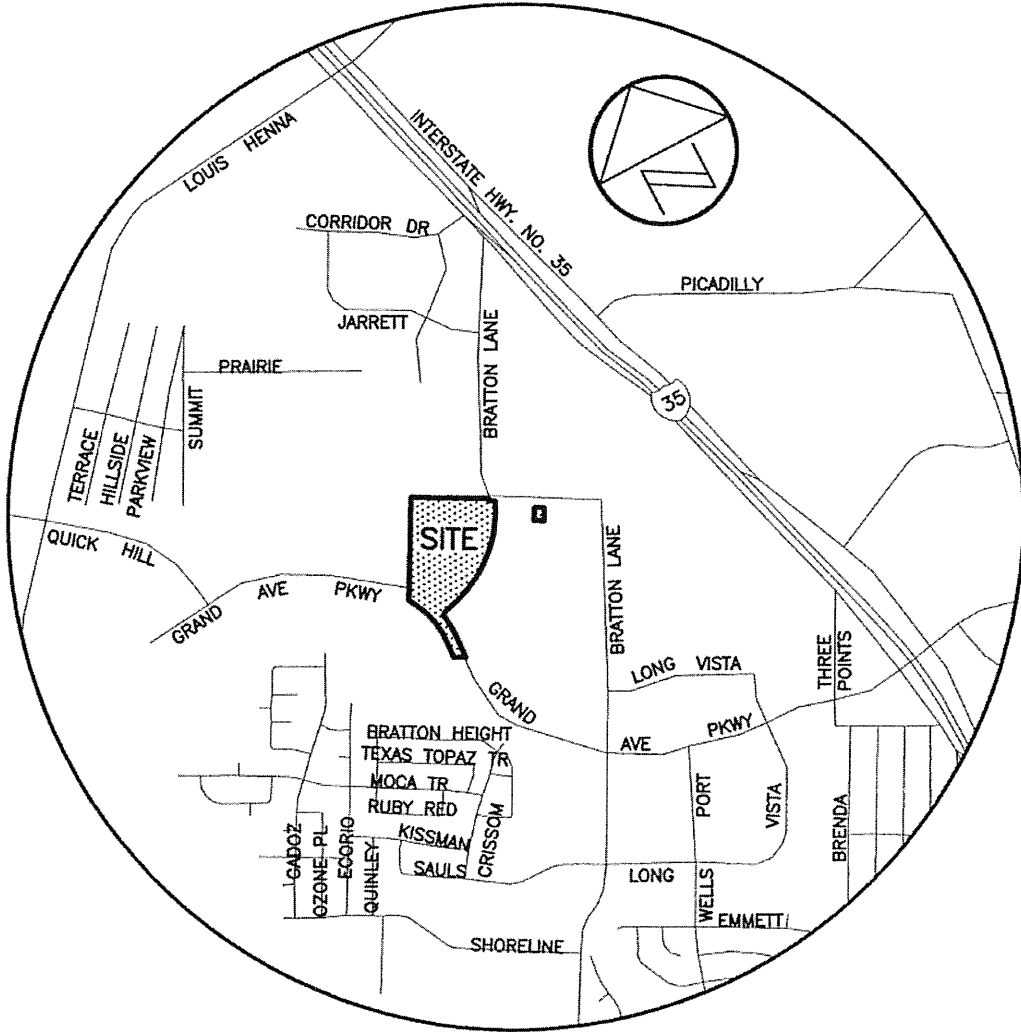

VICINITY MAP  
NOT TO SCALE

#11467791  
ZAP