

SUBDIVISION REVIEW SHEET

CASE NO.: C8J-66-029.02.2A

Z.A.P. DATE: 2-16-16

SUBDIVISION NAME: Terrace at Walnut Creek Section One

AREA: 29.4680

LOT(S): 5

OWNER/APPLICANT: JB 290 LTD and Central Texas Regional Mobility Authority
(Edward Butler)

AGENT: LJA Engineering (Paul Vicktorin)

ADDRESS OF SUBDIVISION: 8100-8425 OLD MANOR RD

GRIDS: ML25

COUNTY: Travis

WATERSHED: Walnut Creek

JURISDICTION: 2 Mile ETJ

EXISTING ZONING:

NEIGHBORHOOD PLAN:

PROPOSED LAND USE: Commercial Multi Family

ADMINISTRATIVE WAIVERS: None

VARIANCES: None

SIDEWALKS: Sidewalks will be provided on both sides of all internal streets and the subdivision side of boundary streets.

DEPARTMENT COMMENTS: The request is for approval of the Terrace at Walnut Creek Section One. The proposed plat is composed of 5 lots on 29.4680 acres.

STAFF RECOMMENDATION: The staff recommends disapproval of the plat. This plat does not meet all applicable State and City of Austin LDC requirements.

ZONING AND PLATTING ACTION:

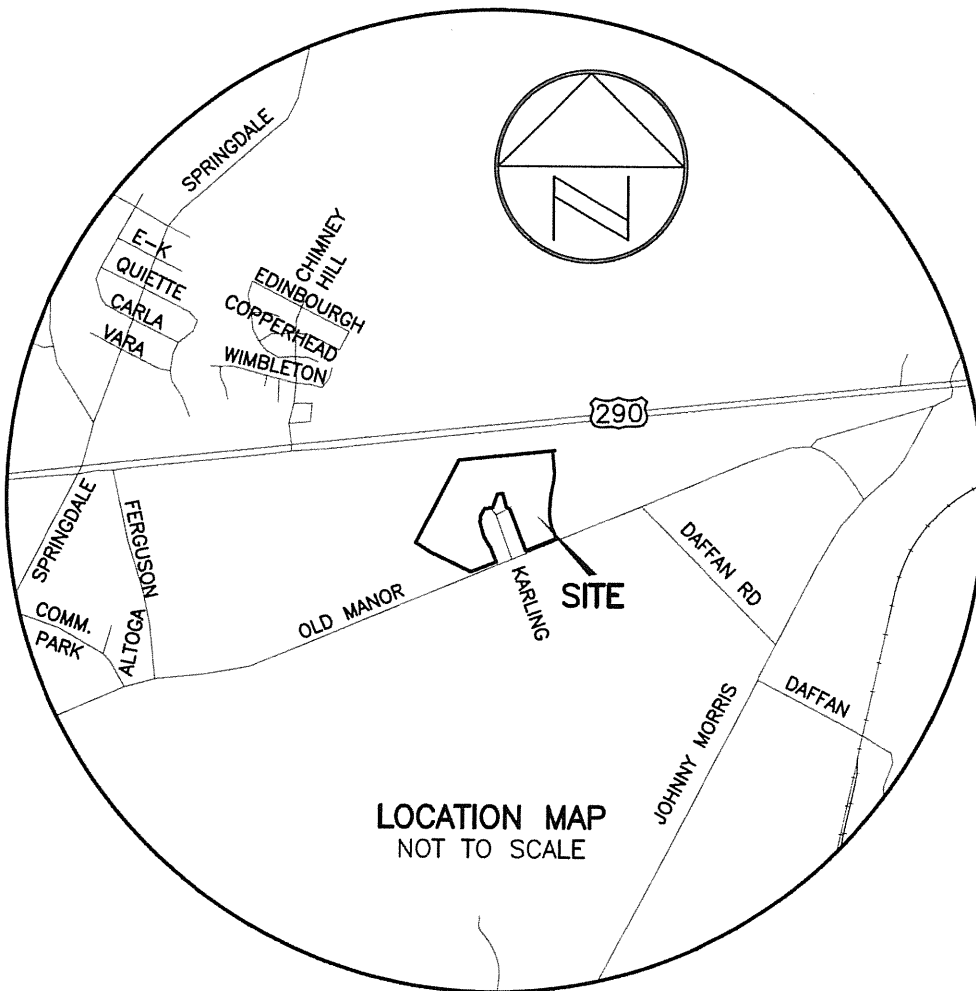

#11472818
ZAP