

**HISTORIC LANDMARK COMMISSION
FEBRUARY 22, 2016
DEMOLITION AND RELOCATION PERMITS
HDP-2016-0022
6014 CITY PARK ROAD**

PROPOSAL

Demolish a house and outbuildings of undetermined age.

ARCHITECTURE

The principal house is a one-story, rectangular-plan, shallow-gabled stone house with single 1:1 fenestration; there is an addition to the left rear of the main house that is also constructed of stone, and extends back from the house. The stone addition has a secondary entry and single 1:1 fenestration. The house also has a wood-frame addition to the right rear of the main house; this addition has a flat roof and is possibly an enclosed rear porch. It has artificial brick siding and single 1:1 windows. There are a couple of stone sheds in the front yard of the house and the ruins of another stone building. There are a number of stone walls on the site.

RESEARCH

Research is very difficult through the ordinary means as this house was built in the county and no records exist from city sources. Staff has begun to search county records for ownership and other information to try and piece together the history of this site, but additional time will be necessary to provide a report on the history and context of this property.

From the appearance of the stonework and window sizes and materials, staff estimates that this house was built in the early 20th century, probably around 1920, but maybe even as late as 1940. There are steel lintels at some of the windows, indicating more modern updates to the house, and the stone has concrete as a mortar compound, so it is doubtful that this house predates the turn of the 20th century, but that is not yet clear.

STAFF COMMENTS



The house does not appear in any City survey.

STAFF RECOMMENDATION

Postpone to March 28, 2016 to determine the history of this property. There is no information in the city directories, as this house was located in the county, and appears to have been abandoned for a long time. Before making a decision about whether to grant a demolition permit to remove the remaining structures, staff recommends allowing more time to determine the history of the property.

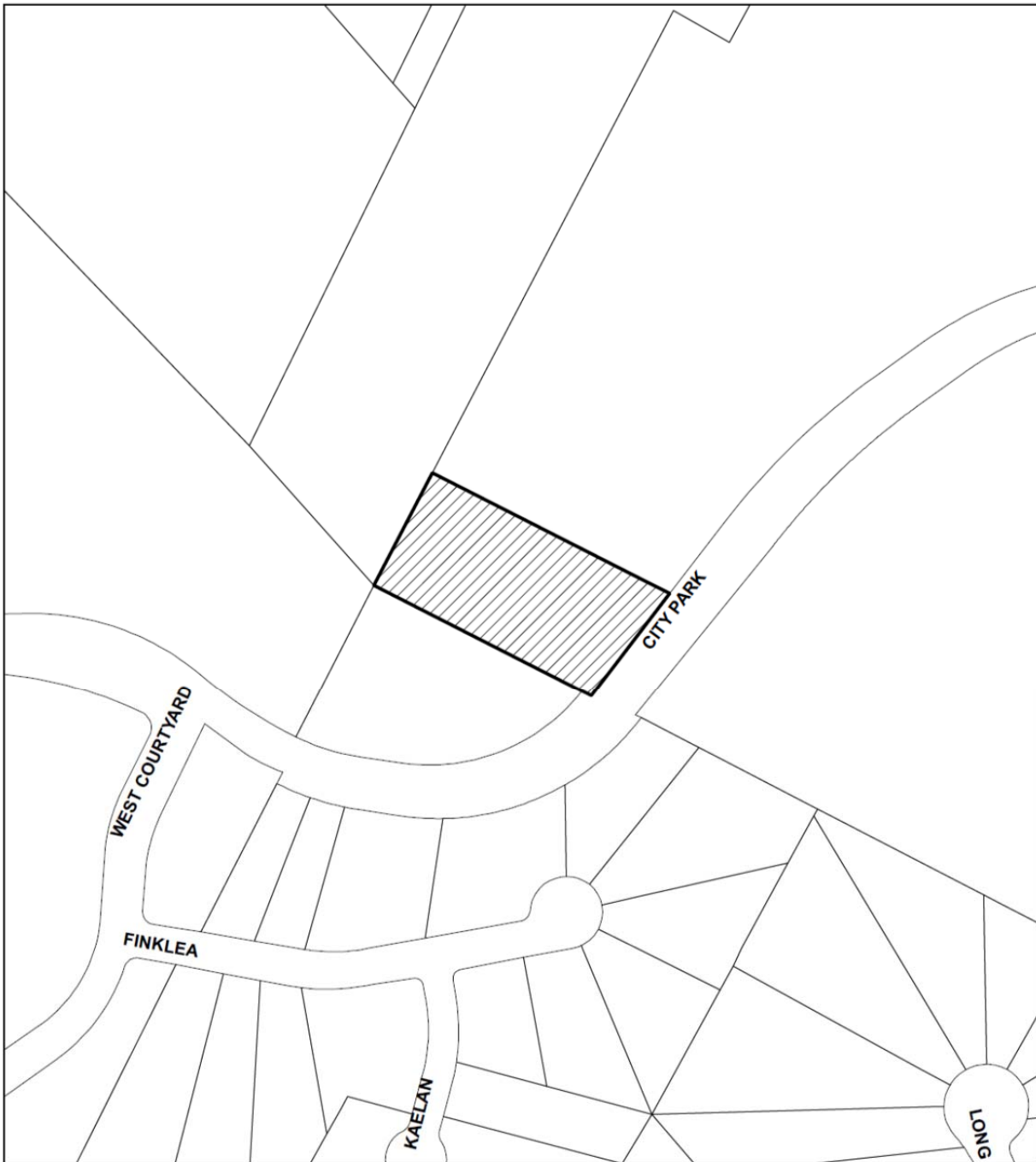
LOCATION MAP



-  SUBJECT TRACT
-  PENDING CASE
-  ZONING BOUNDARY

1" = 208'

NOTIFICATIONS

CASE#: HDP-2016-0022
6014 CITY PARK ROAD

This product is for informational purposes and may not have been prepared for or be suitable for legal, engineering, or surveying purposes. It does not represent an on-the-ground survey and represents only the approximate relative location of property boundaries.

This product has been produced by CTM for the sole purpose of geographic reference. No warranty is made by the City of Austin regarding specific accuracy or completeness.



Photographs of the house and outbuildings taken in February, 2016













