

**SUBDIVISION REVIEW SHEET**

**CASE NO.:** C8J-2016-0040.0A

**Z.A.P. DATE:** 3-15-16

**SUBDIVISION NAME:** Amended Plat, Lots 31 & 32, Long Branch Valley, Section Two

**AREA:** 8.81

**LOT(S):** 2

**OWNER/APPLICANT:** John Dumas

**AGENT:** Dodd Surveying & Mapping Co. Inc.  
(Fred Dodd, Jr)

**ADDRESS OF SUBDIVISION:** 10601 LITTLE THICKET RD

**GRIDS:** WW20

**COUNTY:**

**WATERSHED:** Barton Creek

**JURISDICTION:** 5 Mile ETJ

**EXISTING ZONING:**

**NEIGHBORHOOD PLAN:**

**PROPOSED LAND USE:** SF

**ADMINISTRATIVE WAIVERS:** None

**VARIANCES:** None

**SIDEWALKS:** Sidewalks will be provided on both sides of all internal streets and the subdivision side of boundary streets.

**DEPARTMENT COMMENTS:** The request is for approval of the Amended Plat, Lots 31 & 32, Long Branch Valley, Section Two. The proposed plat is composed of 2 lots on 8.81 acres.

**STAFF RECOMMENDATION:** The staff recommends disapproval of the plat. This plat does not meet all applicable State and City of Austin LDC requirements.

**ZONING AND PLATTING ACTION:**

**AMENDING PLAT**  
**LOTS 31 AND 32, LONG BRANCH VALLEY SECTION TWO,**  
**ACCORDING TO THE PLAT RECORDED IN VOLUME 70, PAGE 93 OF THE PLAT RECORDS OF**  
**TRAVIS COUNTY, TEXAS.**

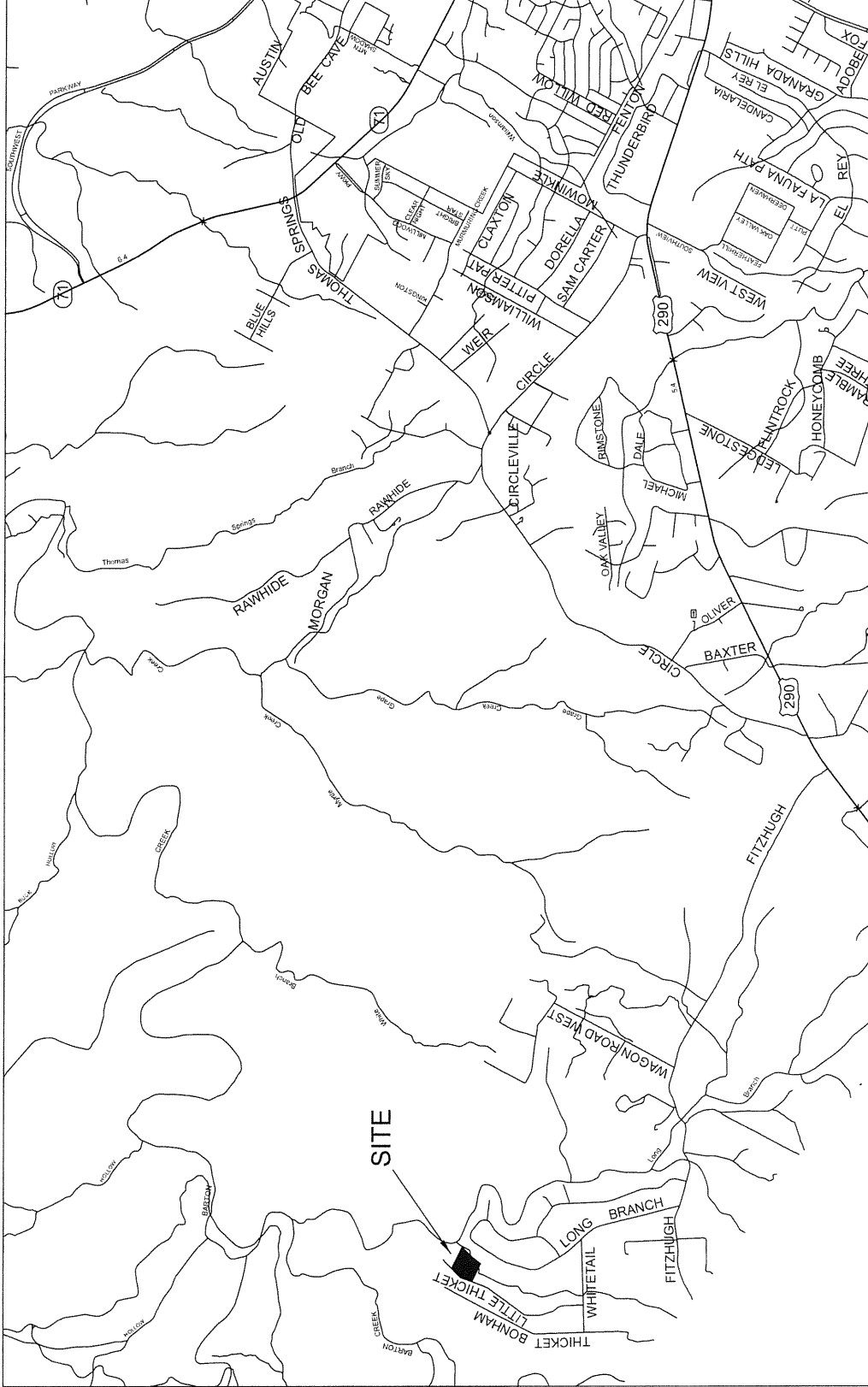

Zap 11488101

**LOCATION MAP**  
 (NOT TO SCALE)

**DODD**  
 SURVEYING & MAPPING CO.  
 PROFESSIONAL LAND SURVEYORS  
 TEXAS FIRM LICENSE NO. 10193745

QUESTIONS, COMMENTS OR TO  
 ORDER A SURVEY EMAIL US AT:  
 INFO@DODDSURVEYING.COM

[WWW.DODDSURVEYING.COM](http://WWW.DODDSURVEYING.COM)

112 W. PECAN STREET  
 PFLUGERVILLE, TX 78660  
 (512) 843-3633