

SUBDIVISION REVIEW SHEET**CASE NO.:** C8-2016-0042.0A**P.C. DATE:** 3-22-16**SUBDIVISION NAME:** Resubdivision of Lot 3C of the Amending Plat of Lots 3A, 3B, & 3C**AREA:** 0.69**LOT(S):** 3**OWNER/APPLICANT:** Bodhi Group, LLC
(Yusuf Johnson)**AGENT:** Land Answers, Inc.
(Jim Wittliff)**ADDRESS OF SUBDIVISION:** 1809 WEBBERVILLE RD**GRIDS:** M23**COUNTY:** Travis**WATERSHED:** Fort Branch**JURISDICTION:** Full Purpose**EXISTING ZONING:****NEIGHBORHOOD PLAN:** MLK-183**PROPOSED LAND USE:** Commercial Multi Family**ADMINISTRATIVE WAIVERS:** None**VARIANCES:** None**SIDEWALKS:** Sidewalks will be provided on both sides of all internal streets and the subdivision side of boundary streets.**DEPARTMENT COMMENTS:** The request is for approval of the Resubdivision of Lot 3C of the Amending Plat of Lots 3A, 3B, & 3C. The proposed plat is composed of 3 lots on 0.69 acres.**STAFF RECOMMENDATION:** The staff recommends disapproval of the plat. This plat does not meet all applicable State and City of Austin LDC requirements.**P.C. ACTION:**

Travis CAD - Map of Property ID 719834 for Year 2015

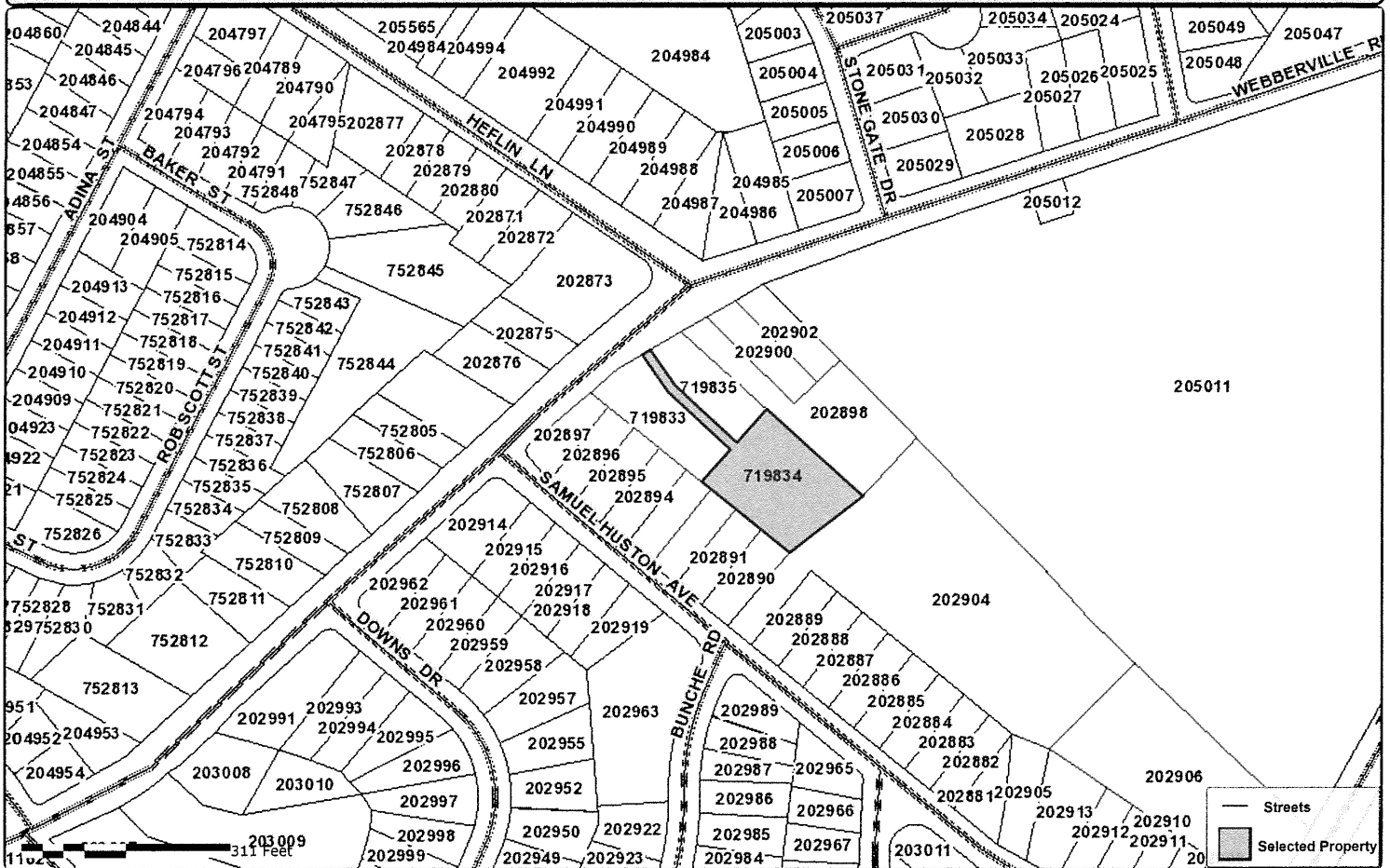

Property Details

Account

Property ID: 719834

Geo ID: 0211220256

Type: Real

Legal Description: LOT 3C BUNCHE ROAD SUBD RESUB OF LOT 3

Location

Situs Address: 1809 WEBBERVILLE RD TX 78721

Neighborhood: E0300REMODEL

Mapsc0: 586M

Jurisdictions: 02, 0A, 2J, 68, 01, 03

Owner

Owner Name: BODHI GROUP LLC

Mailing Address: , 13492 RESEARCH BLVD STE 120-411, AUSTIN, TX 78750

Property

Appraised Value: \$93,750.00

<http://propaccess.traviscad.org/Map/View/Map/1/719834/2015>

powered by:
PropertyACCESS
 www.trueautomation.com

Map Disclaimer: This tax map was compiled solely for the use of TCAD. Areas depicted by these digital products are approximate, and are not necessarily accurate to mapping, surveying or engineering standards. Conclusions drawn from this information are the responsibility of the user. The TCAD makes no claims, promises or guarantees about the accuracy, completeness or adequacy of this information and expressly disclaims liability for any errors and omissions. The mapped data does not constitute a legal document.