

SUBDIVISION REVIEW SHEET**CASE NO.:** C8J-2016-0068.0A**Z.A.P. DATE:** 4-19-16**SUBDIVISION NAME:** Paladino Ridge**AREA:** 4.99**LOT(S):** 1**OWNER/APPLICANT:** Christopher Paladino**AGENT:** Jones Carter Inc.
(Stephen Barger)**ADDRESS OF SUBDIVISION:** 11735 LIME CREEK RD**GRIDS:** B40**COUNTY:****WATERSHED:** Lake Travis**JURISDICTION:** 5 Mile ETJ**EXISTING ZONING:****NEIGHBORHOOD PLAN:****PROPOSED LAND USE:** SF**ADMINISTRATIVE WAIVERS:** None**VARIANCES:** None**SIDEWALKS:** Sidewalks will be provided on both sides of all internal streets and the subdivision side of boundary streets.**DEPARTMENT COMMENTS:** The request is for approval of the Paladino Ridge. The proposed plat is composed of 1 lot on 4.99 acres.**STAFF RECOMMENDATION:** The staff recommends disapproval of the plat. This plat does not meet all applicable State and City of Austin LDC requirements.**ZONING AND PLATTING ACTION:**

Property Search Results > Property ID 746073 PALADINO CHRISTOPHER D & for Year 2016

New Search

Details Map

Help

Account Property ID: 746073 Geo. ID: 0183470549 Type: Real Legal Description: ABS 2236 SUR 193 T C R R CD ACR 4.9890	Location Site Address: 11735 LIME CREEK RD TX 78641 Neighborhood: Land Region 130 Mapco: 401V Jurisdictions: 68, GA, 2J, 03, 69, 71	Owner Owner Name: PALADINO CHRISTOPHER D & Mailing Address: PAMELA K PALADINO, 1802 PURPLE SAGE DR, , CEDAR PARK, TX 78613-1563	Property Appraised Value: N/A
---	--	--	---

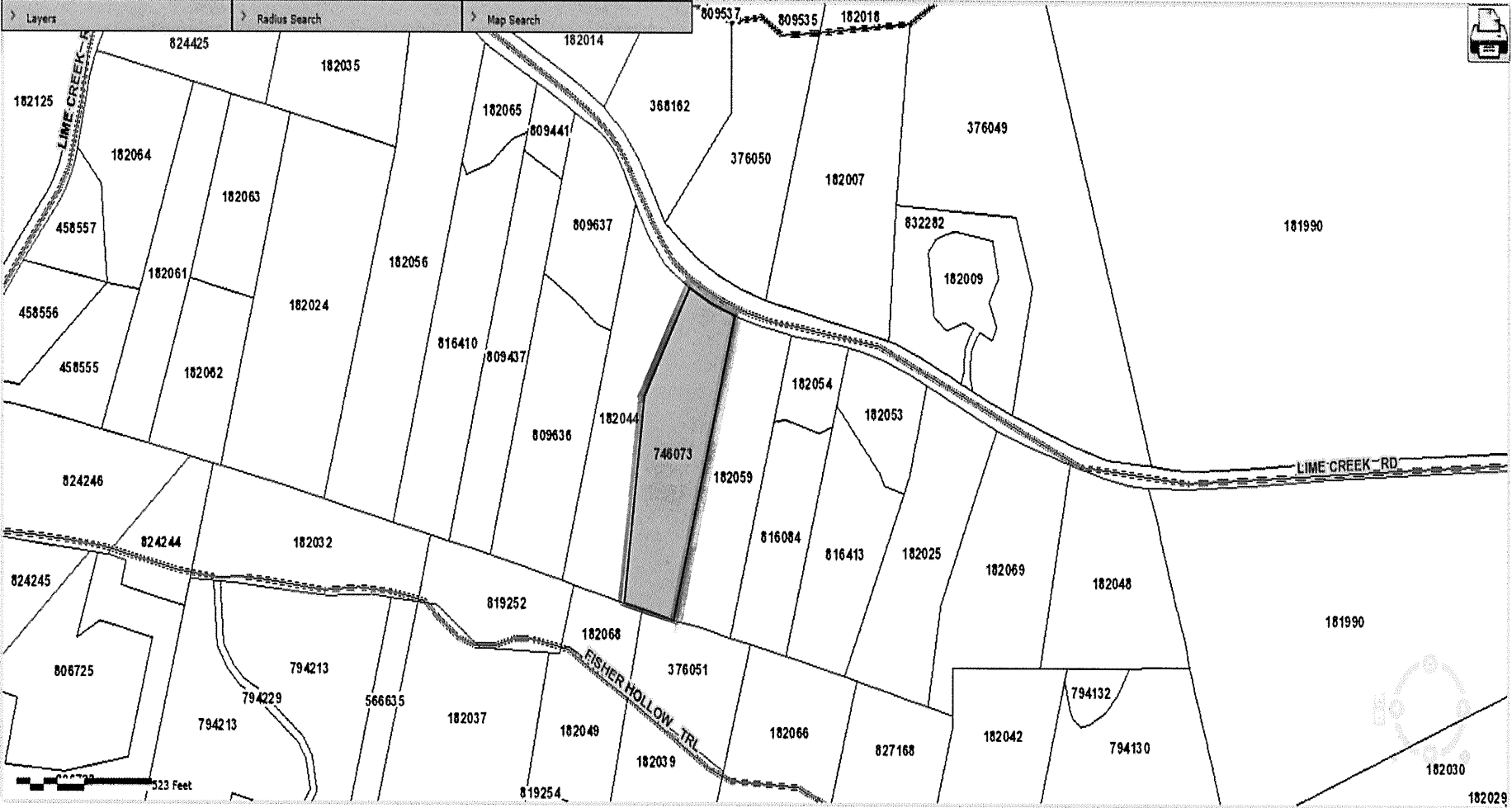

ZAP
11507508