



Austin Energy's District Cooling Program

Resource Management Commission
May 17, 2016

Jim Collins, Director
On-Site Energy Resources





District Cooling



- An underground network of pipes providing chilled water to meet the cooling needs of multiple buildings
- Gathering load generates superior energy savings, reliability and quality than stand-alone systems
- District Cooling Program has connected 68 customers
- Over 18.6 million square feet of facilities (i.e. 165 City Halls)



Keeping Austin Cool

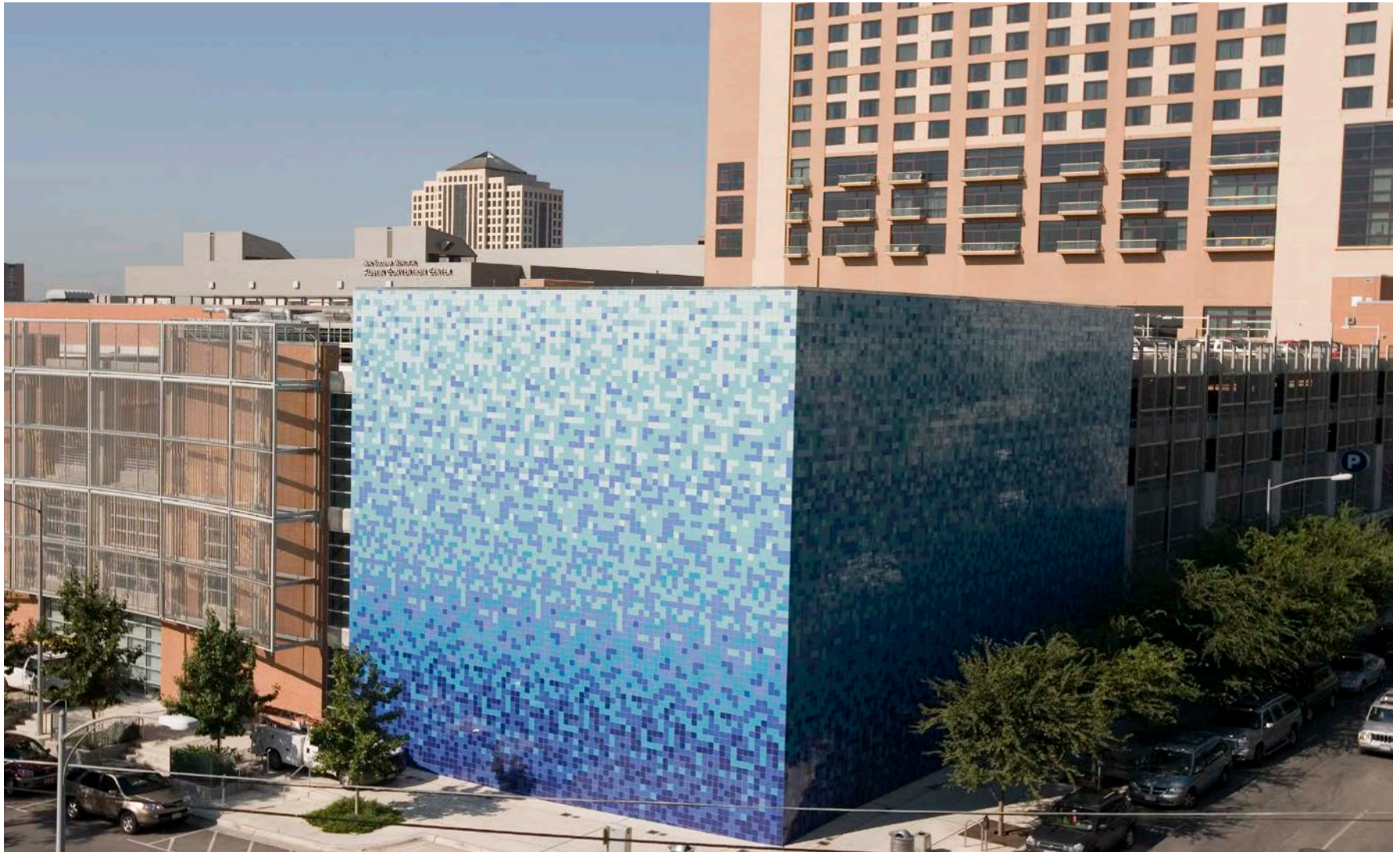



Peak Demand Management

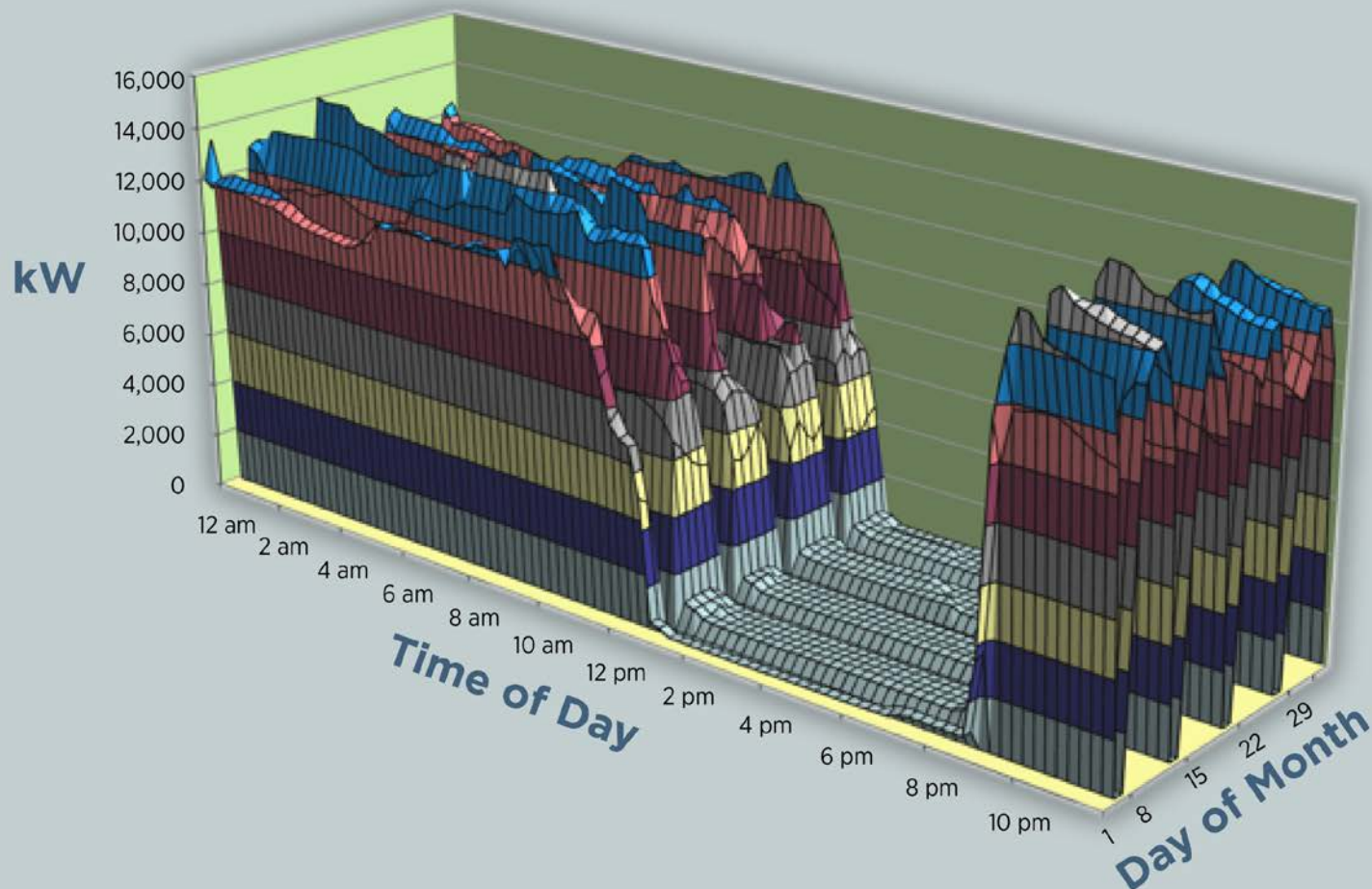



Benefits

For District Cooling Customers:

- Reduces capital costs and frees up building space
- Must make financial sense over a stand-alone system
- Extraordinary reliability by design
- User-friendly system means low risk to customers

For the Community and Austin Energy:

- Supports compact and connected economic development
- Creates a long-term revenue stream
- Supports Austin Energy Resource, Generation and Climate Protection Plan to 2025
- Shifting peak electric demand means Electric Reliability Council of Texas (ERCOT) market and regulatory savings or avoided costs

Downtown District Cooling

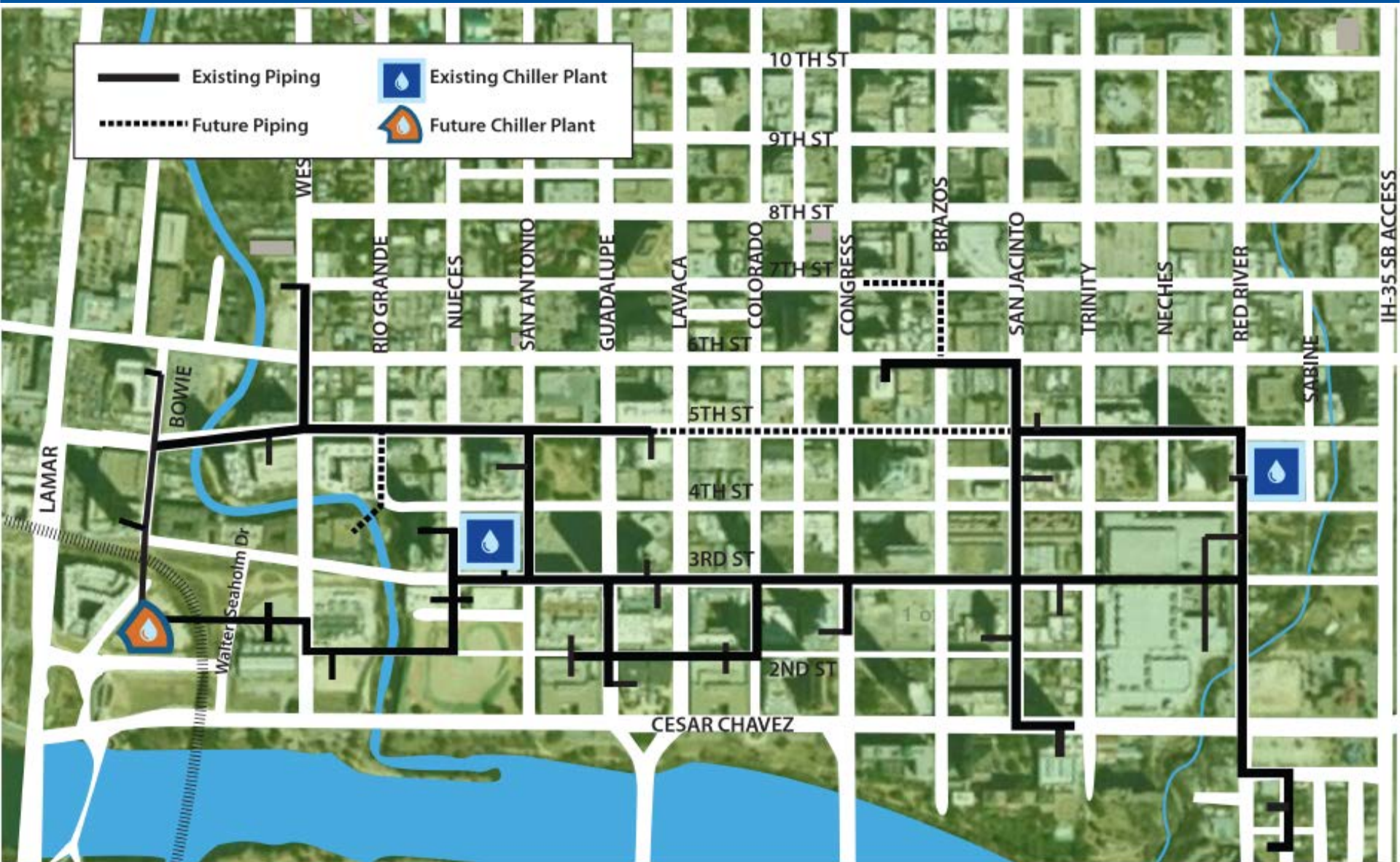



District Cooling Plant Locations

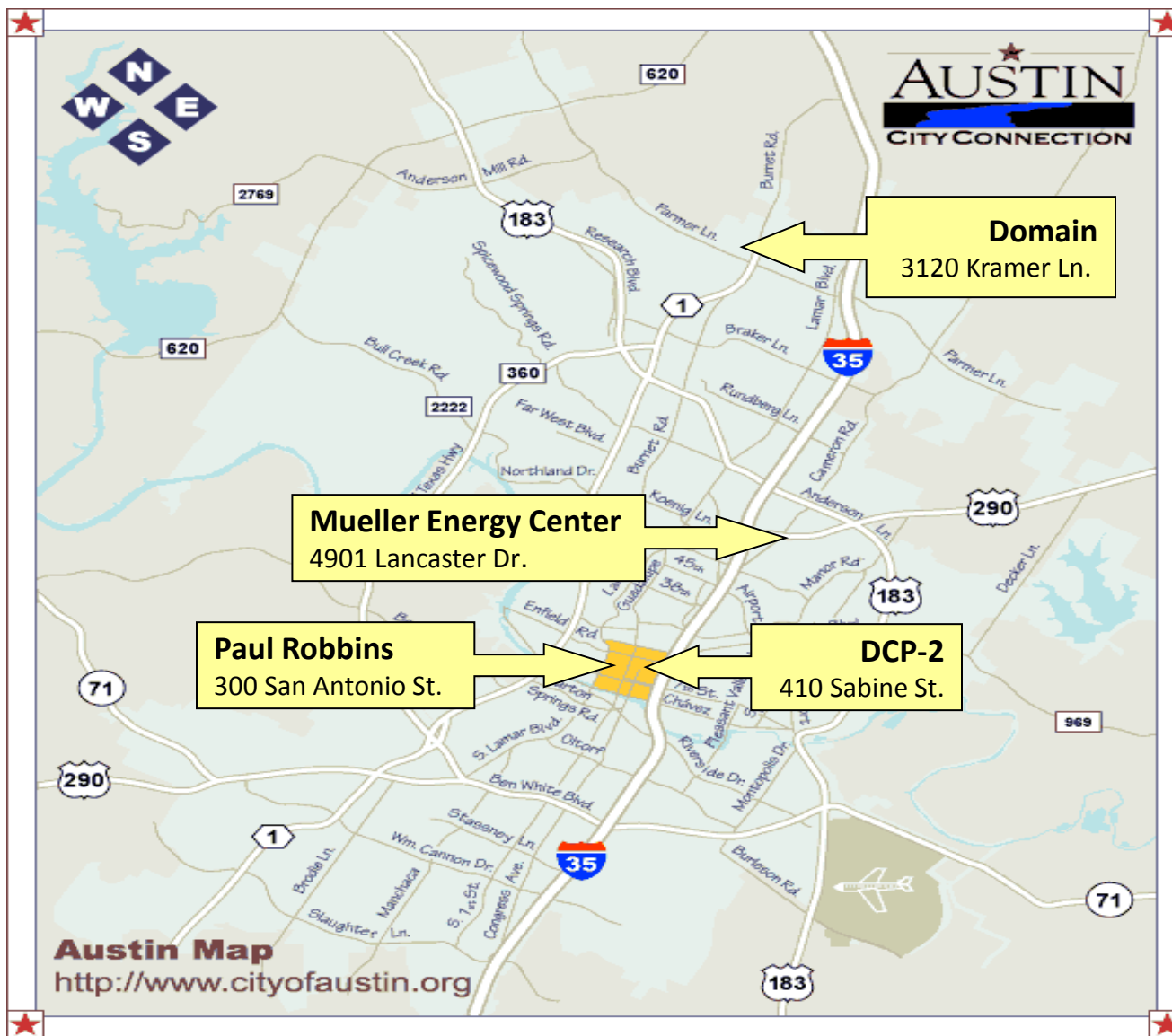



District Cooling

Program Recap

- 68 customers connected to District Cooling systems
- Sound financial model / Cost recovery from Chilled Water Customers
- Providing 15MW of electric demand management toward 2025 goal of 20MW

Potential Expansion

- Expansion within existing plants
- Additional plants
 - Mueller expansion
 - Downtown expansion on Crescent Property
 - New satellite locations in support of Imagine Austin Plan
Austin Community College/Highland Mall, South Central Waterfront, Central Health, and Innovation District



Thank you,

Questions?