

**HISTORIC LANDMARK COMMISSION
MAY 23, 2016
DEMOLITION AND RELOCATION PERMITS
HDP-2016-0296
607 ACADEMY DRIVE**

PROPOSAL

Demolish a ca. 1931 house.

ARCHITECTURE

One-and-a-half story rectangular-plan cross-gabled frame Tudor Revival-styled cottage with a front-gabled independent porch on brick posts; single and paired 1:1 fenestration; prominent knee braces at the deep eaves; synthetic siding.

RESEARCH

The house appears to have been built in 1931 by Harry G. Malmberg, a widower who had an auto garage near the UT campus on 31st Street. Malmberg and his son, Morgan, lived here until around 1936. The house was then a rental property until around 1960. Tenants included two state legislators: Leonard Westfall, a state representative, and G. Hobart Nelson, a state senator, in the mid-1930s; Christian H. Langdeau, an accountant, and his wife, Juanita, a sales clerk at a downtown ladies' hat shop, in the late 1930s, road contractor Lynn D. Pickett and his wife, Oneta, in the 1940s, and a cook at the Night Hawk Café in the late 1950s.

Sam Goldstein purchased the house around 1960, and lived here until around 1980. Goldstein was a mechanic at an auto body shop before he moved into the house, then worked as the manager of a used car lot in the early 1960s, and for the State Board of Insurance as a reproduction operator, through the late 1970s.

STAFF COMMENTS

The house is listed in the Comprehensive Cultural Resources Survey (1984) but without a priority for research.

STAFF RECOMMENDATION

Encourage rehabilitation and adaptive re-use to the greatest extent possible; while modified, the house is a good example of the prevailing Tudor Revival-style architecture that defines Travis Heights. If the Commission votes to release the permit, then staff recommends completion of a City of Austin Documentation Package, consisting of photographs of all elevations, a dimensioned sketch plan, and a narrative history, for archiving at the Austin History Center.

LOCATION MAP

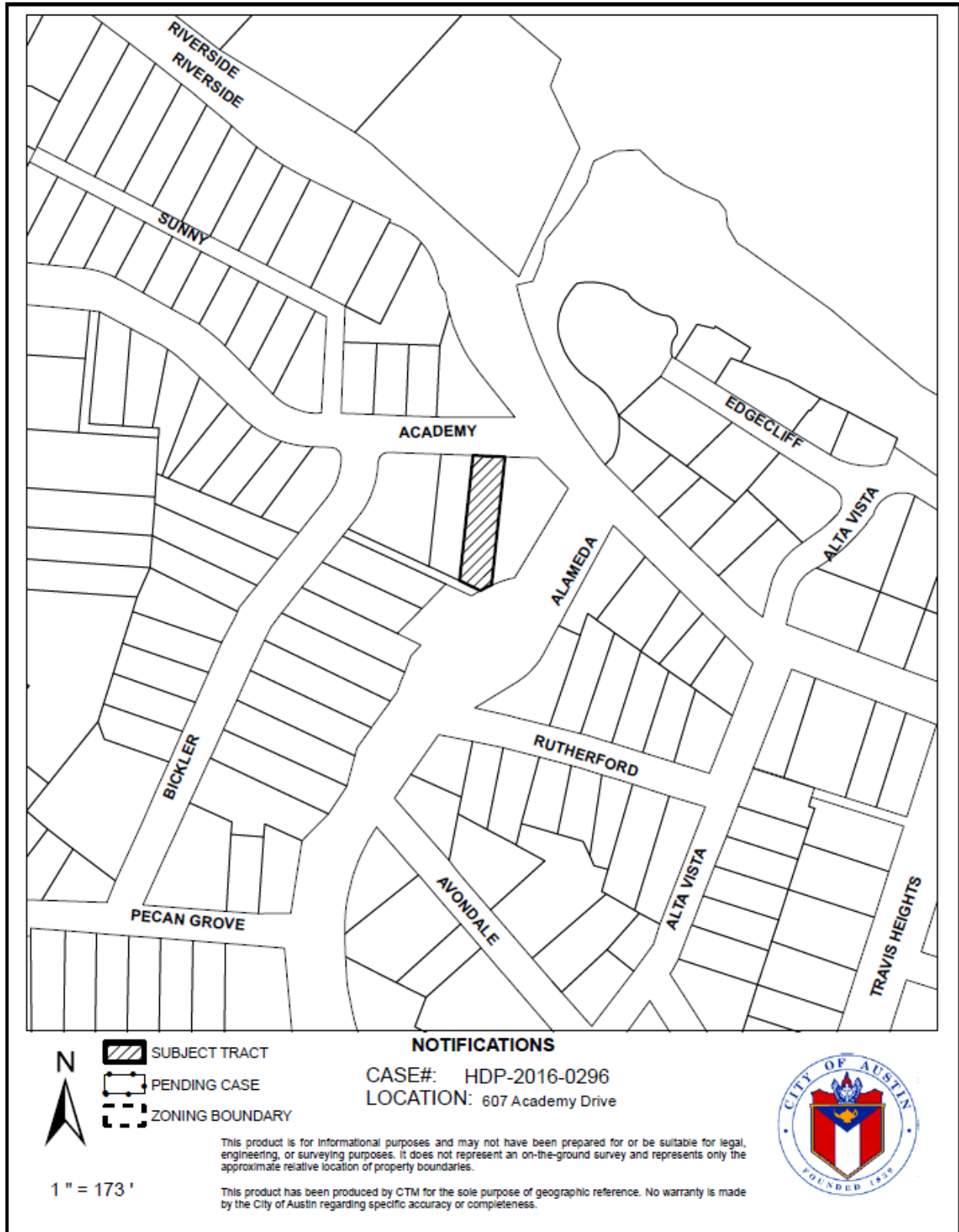

607 Academy Drive
ca. 1931



OCCUPANCY HISTORY
607 Academy Drive

City Directory Research, Austin History Center
By City Historic Preservation Office
August, 2011

| | |
|---------|---|
| 1992 | Clifford A. Wilkes, owner Operations systems specialist, University of Texas |
| 1985-86 | William T. Buida, owner Employed by the State of Texas |
| 1981 | William T. Buida, renter No occupation listed |
| 1977 | Sam E. Goldstein, owner Reproduction operator, State Board of Insurance |
| 1972 | Sam E. Goldstein, owner Reproduction operator, State Board of Insurance |
| 1969 | Sam E. Goldstein, owner Reproduction operator, State Board of Insurance |

- 1965 Sam E. Goldstein, owner
Reproduction operator, State Board of Insurance
- 1961 Sam E. Goldstein, owner
Manager, Pony Hibbs Used Cars, 3409 E. 5th Street.
- 1957 E.J. Nut, owner
Not listed in the directory.
- 1953 B.B. and Tommie Hill, renters
Assistant manager, Driskill Hotel
- 1949 Oneta Pickett, renter
Nurse
- 1947 Lynn D. and Oneta Pickett, renters
Contractor (at the house).
- 1944-45 D. Len and Oneta Pickett, renters
Road worker
- 1941 William F. and Kelly M. Jones, renters
Mechanic, Central Freight Lines, 401 Colorado Street.
- 1939 Christian H. and Juanita Langdeau, renters
Christian: Accountant
Juanita: Saleswoman, Rhealee Hat Shop, 706 Congress Avenue.
- 1937 G. Hobart and Aileen Nelson, renters
State Senator
- 1935 Leonard and Nora Westfall, renters
State representative
- Harry G. Malmberg, renter
Auto repair, 104 E. 31st Street.
- 1932-33 Harry G. Malmberg, renter
Proprietor, Malmberg's Mechanical Service, 120 W. 31st Street.
- 1930-31 The address is not listed in the directory.
NOTE: Harry G. Malmberg is listed at 505 W. 31st Street; he had an auto repair business at 3016 Guadalupe Street.

BIOGRAPHICAL NOTES:

Harry G. Malmberg (ca. 1931 – ca. 1934)

H.G. Malmberg appears in the 1930 U.S. Census as the renter of the house at 105 E. 1st Street in Austin. He was a 30-year old widower who had been born in Texas to Swedish-born parents. He was a mechanic in an auto shop. He had a son, Morgan, 12, who had been born in Texas.

The 1920 U.S. Census shows Harry and Dora Malmberg as the renters of the house at 2105 E. 1st Street in Austin. Harry Malmberg was 23, had been born in Texas to Swedish-born parents, and was the proprietor of an auto garage. Dora Malmberg was 22, had been born in Texas, and had no occupation listed. They had a son, Morgan, 2.

His 1917 World War I draft registration card shows that Harry Gunner Malmberg was born in Georgetown, Texas in 1896. He was living at 2105 E. 1st Street in Austin and was an auto mechanic. He was tall, with a medium build, hazel eyes, and brown hair.

HARRY G. MALMBERG
 Harry G. Malmberg, 52, died in San Antonio Wednesday. He was a former resident of Austin but had lived in San Antonio for the past six years. He had been an automobile mechanic for 35 years. Survivors include one son, Morgan C. Malmberg of San Antonio; one brother, Eric Malmberg of Austin, and two sisters, Mrs. A. W. Berg and Mrs. S. Paulson, both of Austin. Funeral service will be held at the Hyllin-Manor Funeral Home Thursday at 5:30 p.m. with the Rev. Joe Love of the East Avenue Baptist Church officiating. Burial will be in Austin Memorial Park. Pallbearers will be Roger Wesson, Raymond Riggs, Elmer Paulson, Tony Malmberg, Harry Malmberg, and Dayton Hibler.

Obituary of Harry Malmberg
 Austin American, June 15, 1950

D. Lynn and Oneta Pickett (ca. 1943 – ca. 1950)

D.L. and Oneta Pickett appear in the 1940 U.S. Census as the renters of a duplex at 3701 Kerbey Lane in Austin. D.L. Pickett was 32, had been born in Texas, and was a purchasing agent for the LCRA. Oneta Pickett was 31, was born in Texas, and had no occupation listed. They had lived in rural Lampasas County, Texas.

PICKETT, Oneta, 79, of Austin died Thursday. Services 2 p.m. today at Kempner Cemetery in Kempner. (Hylltin-Manor)

Death notice for Oneta Pickett
 Austin American-Statesman, October 10, 1987

Sam E. Goldstein (ca. 1960 – ca. 1980)

Samuel E. (Sam) Goldstein

Samuel E. (Sam) Goldstein, 59, of Austin died Wednesday, March 10, 1993.

Funeral services will be held 2:00 PM Monday in the Colonial Chapel of Cook-Walden Funeral Home. Interment will be in Cook-Walden Capital Parks Cemetery.

Mr. Goldstein is survived by sister, Janell Hepler of Decatur, Alabama; brothers, Earl Goldstein of Bastrop, Texas, Skippy Goldstein of Bastrop, Texas, Larry Goldstein of Austin, Texas, Jerry Goldstein of Cedar Creek, Texas; numerous nieces and nephews; and many, many friends.

Arrangements by Cook-Walden Funeral Home, Lamar location.

Obituary of Samuel E. Goldstein
Austin American-Statesman, March 13, 1993

Unless the Plumbing is done in strict accordance with City Ordinances, do not turn on the water.

PERMIT FOR WATER SERVICE

AUSTIN, TEXAS No A 211-55C 13.

M. H. G. Malmberg Address 601 Academy

Plumber J. J. Smith Size of Tap 1/2 Date 3-31-31

SW-II

Date of Connection 4/1/31

Size of Tap Made 3/4

Size Service Made 3/4

Size Main Tapped 6

From Front Prop. Line to Curb Cock 12'

From Prop. Line to Curb Cock 12'

Location of Meter at curb

Type of Box 20"

Depth of Main in St. 18"

Depth of Service Line 9"

From Curb Cock to Tap on Main 9"

Checked by Engr. Dept. 5-4-31-31

INDEXED

Foreman's Report

| No. | Fittings | Size |
|-----|-----------|------|
| 1 | Curb Cock | 3/4" |
| 1 | Elbow | 3/4" |
| 1 | Bushing | 3/4" |
| 1 | Pipe | 3/4" |
| 1 | Nipples | 3/4" |
| 1 | Plug | 3/4" |
| 1 | Tee | 3/4" |
| 1 | Stop | 3/4" |
| 1 | Box | 3/4" |
| 1 | Lid | 3/4" |
| 1 | Valves | 3/4" |

Foreman's Signature [Signature]

Req. No. 7623

Water service permit to Harry G. Malmberg for this house (1931)

SANITARY SEWER SERVICE PERMIT
Austin, Texas

Nº 71548

SW
II

Received of Date

Address 607 Academy Dr.

Amount \$

Builder or Owner Plumber

Lot 24 Block Subdivision Plat No.

| | | |
|---|---|-------|
| Date of Connection <u>5-6-31</u> | No. Fittings Pipe Pipe Wyes Bends Reducers Plugs Sand Gravel Remix Stoppers Castings Other Labor: Total | Price |
| By City <u>76 1/2' S/SPL of Riverside</u> | | Size |
| By Plumber <u>Dr. in Academy</u> | | 4" |
| Checked By | | |
| Size Main Depth | | |
| Main Assign. | | |
| Stub Depth Prop. Line | | |
| Stub Location | | |
| Book No. <u>B-360</u> | | |
| Paving Cut No. | | |

Sanitary sewer service permit for this address (1931)