



LITTLE STACY PARK

IMPROVEMENTS

PARD Land, Facilities & Programming | June 13, 2016



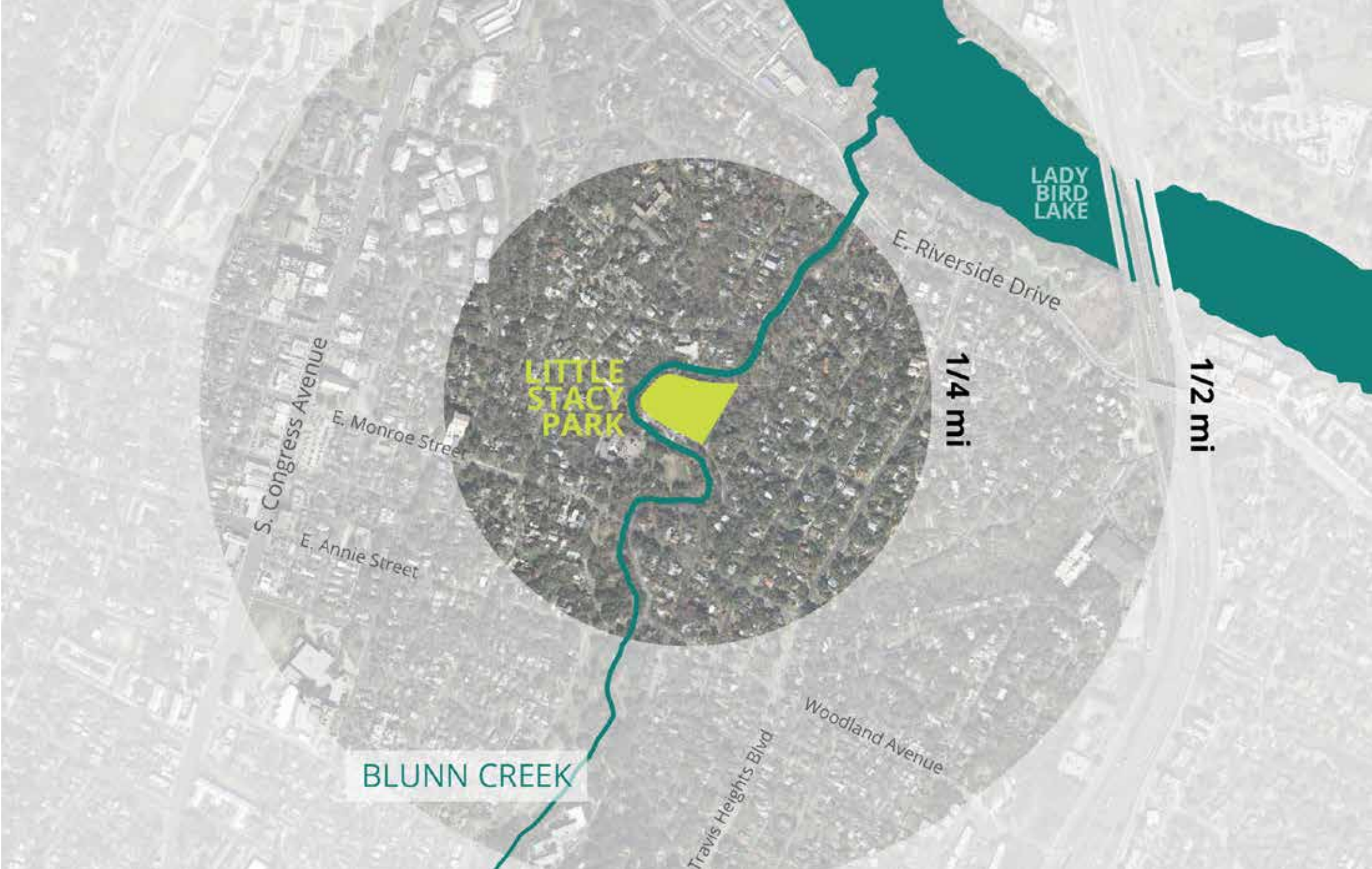

SITE CONTEXT



STORMWATER



EGRESS PATH



COURT SURFACE CRACKING



ACCESSIBILITY



ACCESSIBILITY VIOLATIONS

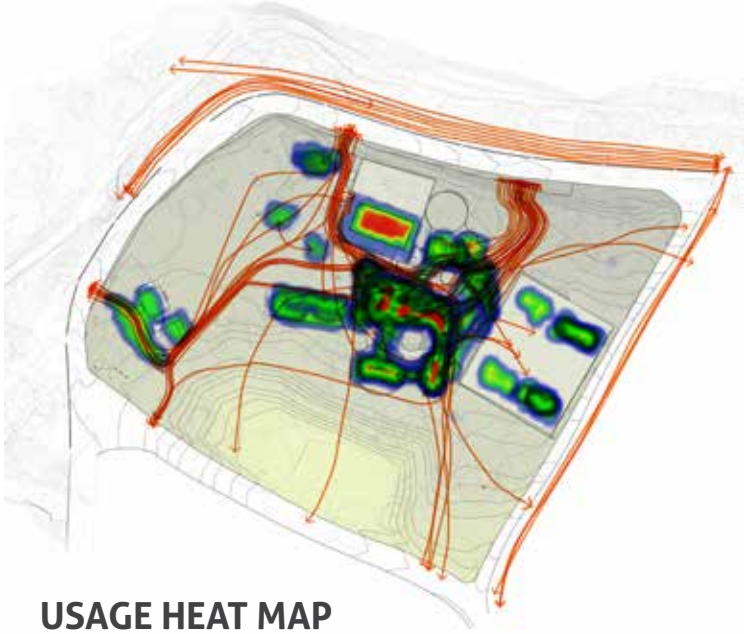

USAGE HEAT MAP

SITE CONTEXT



THREE CONCEPTS

The design team presented three concepts to neighborhoods stakeholders, ranging from “natural” areas and kid-based programs to formal paths, adult activities and water features.

Stakeholders overwhelmingly supported a “light touch” on the site.

STAKEHOLDER INPUT

WHAT WE HEARD

- Mark and celebrate park entrances
- Manage stormwater with raingardens
- Maintain central play area for kids of all ages
- Resurface two tennis courts
- Improve accessibility throughout the site
- Maintain lawn for open use
- Minimize impervious surface
- Preserve WPA-era design

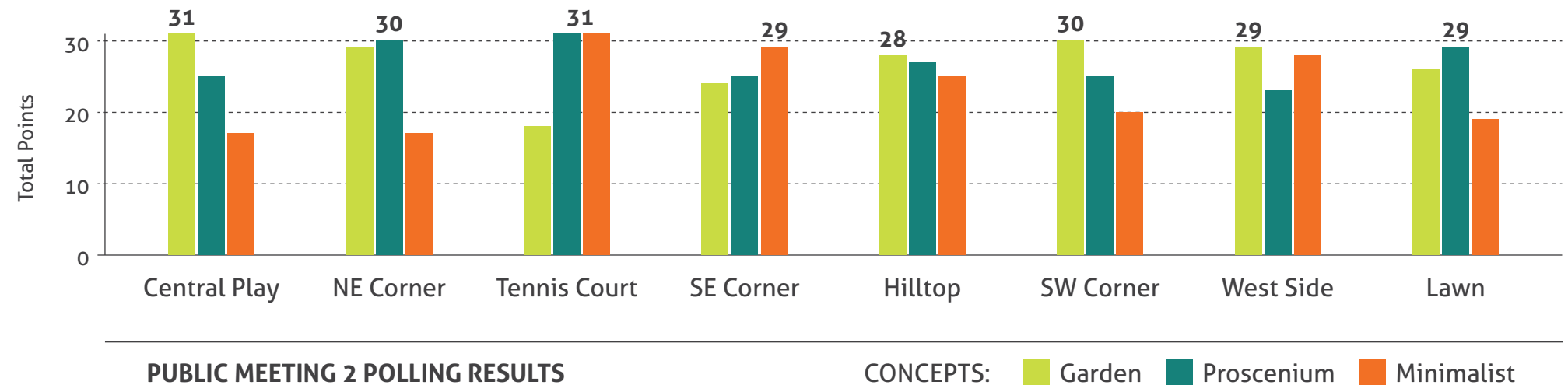

STAKEHOLDER INPUT



PUBLIC PARTICIPATION

- Three public input meetings drawing over 50 participants
- Online survey
- Three presentations to the SRCC Neighborhood Association
- Coordination with Watershed Department and PARD Aquatics Division
- Letter of support from SRCC

STAKEHOLDER INPUT



PROPOSED SITE PLAN

PREFERRED DESIGN



NORTHEAST ENTRY



SOUTHWEST ENTRY



PICNIC AREA

PREFERRED DESIGN



DEMOLITION PLAN

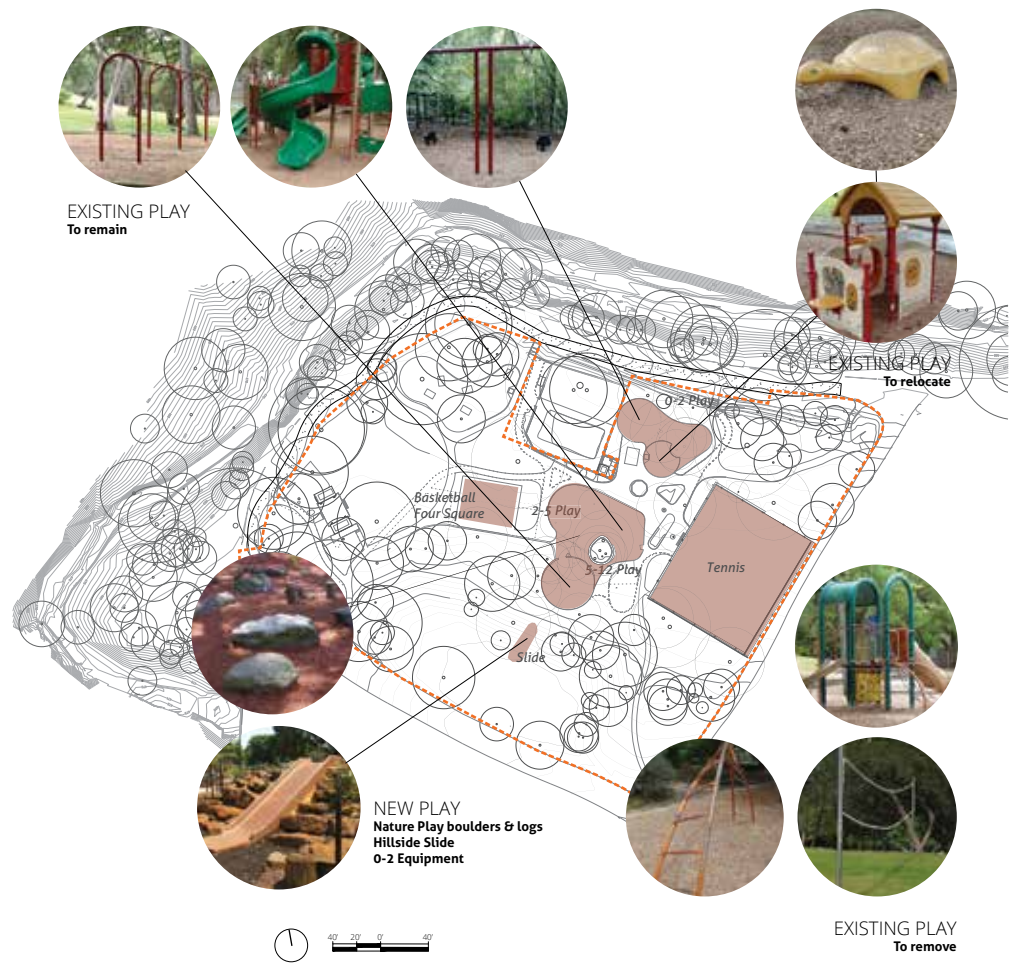

SPORTS & PLAY EQUIPMENT PLAN

PREFERRED DESIGN



LEGEND

- UNIT OF CONSTRUCTION
- 30 GAL. MONUMENTAL
- 30 GAL. TREES (S.D.)
- 30 GAL. TREES (MOUNTAIN LURE)
- 30 GAL. TREES (S.D.)
- 30 GAL. TREES (S.D.)
- 30 GAL. TREES (S.D.)

asakura
robinson

ILLUSTRATIVE PLAN
1 MAY 2019

PREFERRED DESIGN



COORDINATION
WITH WATERSHED

PICNIC AREA

RAINGARDENS

GREAT LAWN

SHELTER HOUSE
PLINTH EXPANSION

IMPROVED PATHS

RECONFIGURED
SPORTS COURT

PEDESTRIAN
PATH LIGHTING

ADD & MAINTAIN
PLAY EQUIPMENT

REPAIR
TENNIS COURTS

ADA PARKING

ENTRY SIGNAGE

ESTABLISH
NEW TREES

AMENDED SITE PLAN



LEGEND	
	LIMIT OF CONSTRUCTION
	30' GAL. HYDRANT PLUMB
	30' GAL. FIRE HYDRANT
	30' GAL. TRAIL MOUNTAIN LIGHT
	30' GAL. STREET LIGHT
	30' GAL. JUNCTION
	30' GAL. SIGN

dSakura
robinson

PREFERRED DESIGN

City of Austin, Parks and Recreation Department

Gary Gregson, Project Coordinator

gary.gregson@austintexas.gov

512-974-9475

Asakura Robinson

Brendan Wittstruck, Assistant Project Manager

brendan@asakurarobinson.com

512-351-9601



CONTACT