

SUBDIVISION REVIEW SHEET

Total Vacation of Plat

CASE NO.: C8s-72-342

Z.A.P. DATE: January 3, 2017

SUBDIVISION NAME: Sutherland Addition - Final Plat

AREA: 14.27 Acres

LOT(S): 3 Total Lots

OWNER/APPLICANT: Austin Ethos Land Partners

AGENT: Urban Design
(John Noell P. E.)

ADDRESS OF SUBDIVISION: Bluff Springs Road

GRIDS: D-10-11

COUNTY: Travis

WATERSHED: Onion Creek

JURISDICTION: 2-Mile ETJ

EXISTING ZONING: N/A

MUD: N/A

PROPOSED LAND USE: No land use stated on original subdivision.

ADMINISTRATIVE WAIVERS: N/A

VARIANCES: None

SIDEWALKS: N/A

DEPARTMENT COMMENTS: The request is for approval of a total vacation of the Sutherland Addition final plat located in the City of Austin's 2 Mile ETJ. The owner of this final plat wishes to vacate entire subdivision. The property is being replatted with a new subdivision named Marbella Section 3. The Marbella final plat will consist of 3 multi-family lots and will be approved administratively. Water and wastewater will be provided by the City of Austin.

Staff has not received any inquiries from anyone on this proposed subdivision.

STAFF RECOMMENDATION: This total vacation request of plat meets all applicable state, county, and City of Austin Title 30-Land Developments Code requirements and staff recommends approval.

ZONING AND PLATTING COMMISSION ACTION:

CASE MANAGER: Jose Luis Arriaga
Email address: joe.arriaga@traviscountytx.gov

PHONE: 854-7562

LOCATION MAP (NTS)

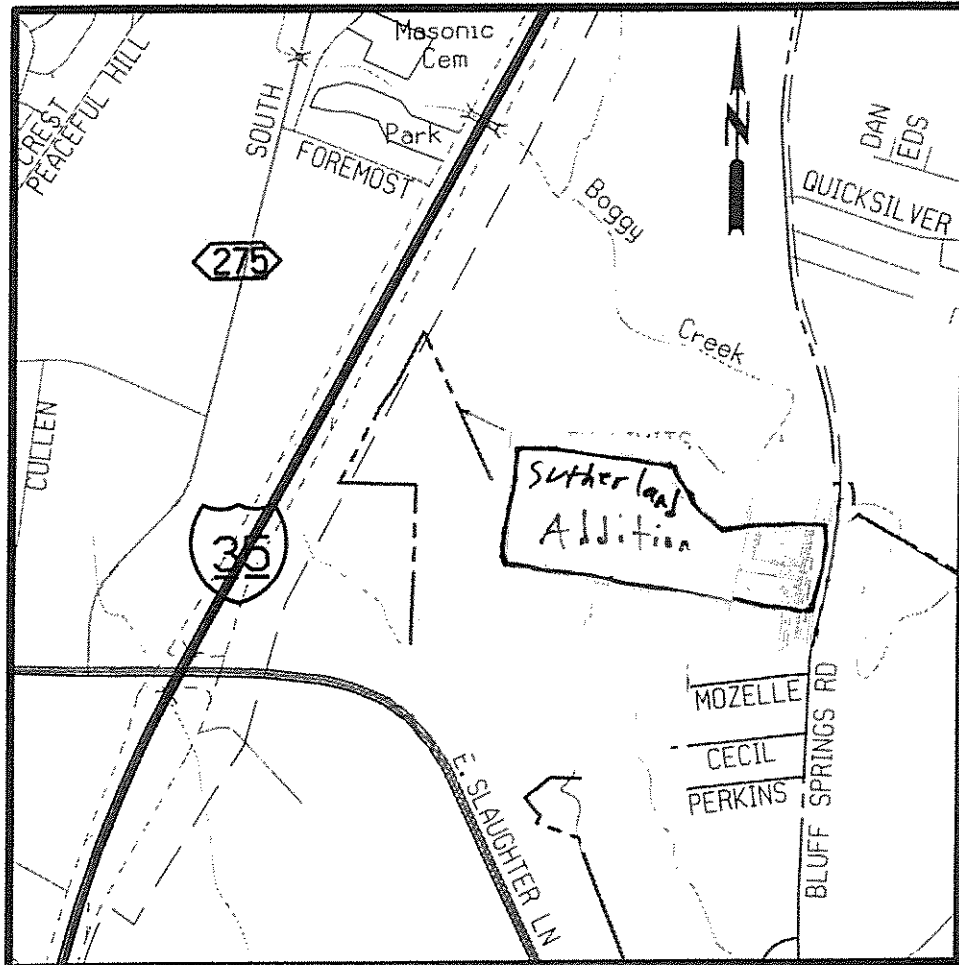

SUTHERLAND ADDITION

SCALE 1"=100'

TURNERSON
Vol. 2778 Pg. 437

LEGEND
* Iron Pin Found
o Iron Pin Set

CURVE DATA
1
I 6°22'
R 1828.02'
T 101.67
A 203.13'
C 203.02'
2
I 6°25'
R 1843.02'
T 102.50'
A 204.80
C 204.69

E. F. Gloyne, et al
Vol. 4235 A 509

8040' to intersection
of Bluff Springs Rd.
Pasha-Lothair Hwy.

BLUFF SPRINGS ROAD



STATE OF TEXAS
COUNTY OF TRAVIS

KNOW ALL MEN BY THESE PRESENTS:

THAT I THOMAS S. SUTHERLAND OWNER OF 14.27 ACRES OF LAND OUT OF THE SANTIAGO DEL VALLE GRANT IN TRAVIS COUNTY, TEXAS AS CONVEYED TO US BY DEED RECORDED IN VOLUME 2780 PAGE 80 OF THE DEED RECORDS OF TRAVIS COUNTY, TEXAS DO HEREBY SUBDIVIDE SAID TRACT OF LAND IN ACCORDANCE WITH THE PLAT SHOWN HEREON SUBJECT TO ANY EASEMENTS OR RESTRICTIONS HERETOFORE GRANTED TO BE KNOWN AS SUTHERLAND ADDITION AND I DO HEREBY DEDICATE TO THE PUBLIC THE USE OF STREETS AND EASEMENTS AS SHOWN HEREON

WITNESS MY HAND THIS THE 5th DAY OF October, 1972 A.D.

Thomas S. Sutherland
THOMAS S. SUTHERLAND

STATE OF TEXAS
COUNTY OF Travis

AND ACKNOWLEDGED TO ME THAT HE EXECUTED THE SAME FOR THE PURPOSES AND CONSIDERATIONS THEREIN EXPRESSED,
GIVEN UNDER MY HAND AND SEAL OF OFFICE THIS THE 5th DAY OF October, 1972 A.D.

APPROVED FOR ACCEPTANCE November 21, 1972, A.D.

Richard E. Lillie
NOTARY PUBLIC IN AND FOR TRAVIS COUNTY, TEXAS

Richard E. Lillie
DIRECTOR OF PLANNING - RICHARD E. LILLIE

ACCEPTED AND AUTHORIZED FOR RECORD BY THE CITY PLANNING COMMISSION, CITY OF AUSTIN, TEXAS, Nov 21 1972

CHAIRMAN Barford Stewart
FILED FOR RECORD AT 10 35 O'CLOCK a. M. THE 27 DAY OF November, 1972, A.D.

SECRETARY Jean Allen Mather
Doris Hampshire
DORIS HAMPSHIRE, CLERK COUNTY COURT, TRAVIS COUNTY, TEXAS

Barford Stewart
DEPUTY

STATE OF TEXAS
COUNTY OF TRAVIS

10-25-72-12