

SUBDIVISION REVIEW SHEET**CASE NO.:** C8-2017-0011**Z.A.P. DATE:** 2-7-17**SUBDIVISION NAME:** Parmer Business Park Preliminary Plan**AREA:** 11.85**LOT(S):** 1**OWNER/APPLICANT:** N/A**AGENT:** Stantec Consulting Services Inc

(Johnah Mankovsky)

ADDRESS OF SUBDIVISION: 500 E PARMER LN**GRIDS:** MN34**COUNTY:****WATERSHED:** Walnut Creek**JURISDICTION:****EXISTING ZONING:****NEIGHBORHOOD PLAN:****PROPOSED LAND USE:** Streets & Drainage**ADMINISTRATIVE WAIVERS:** None**VARIANCES:** None**SIDEWALKS:** Sidewalks will be provided on both sides of all internal streets and the subdivision side of boundary streets.**DEPARTMENT COMMENTS:** The request is for approval of the Parmer Business Park Preliminary Plan. The proposed plat is composed of 1 lot on 11.85 acres.**STAFF RECOMMENDATION:** The staff recommends disapproval of the plat. This plat does not meet all applicable State and City of Austin LDC requirements.**ZONING AND PLATTING ACTION:**

ZAP 11660570

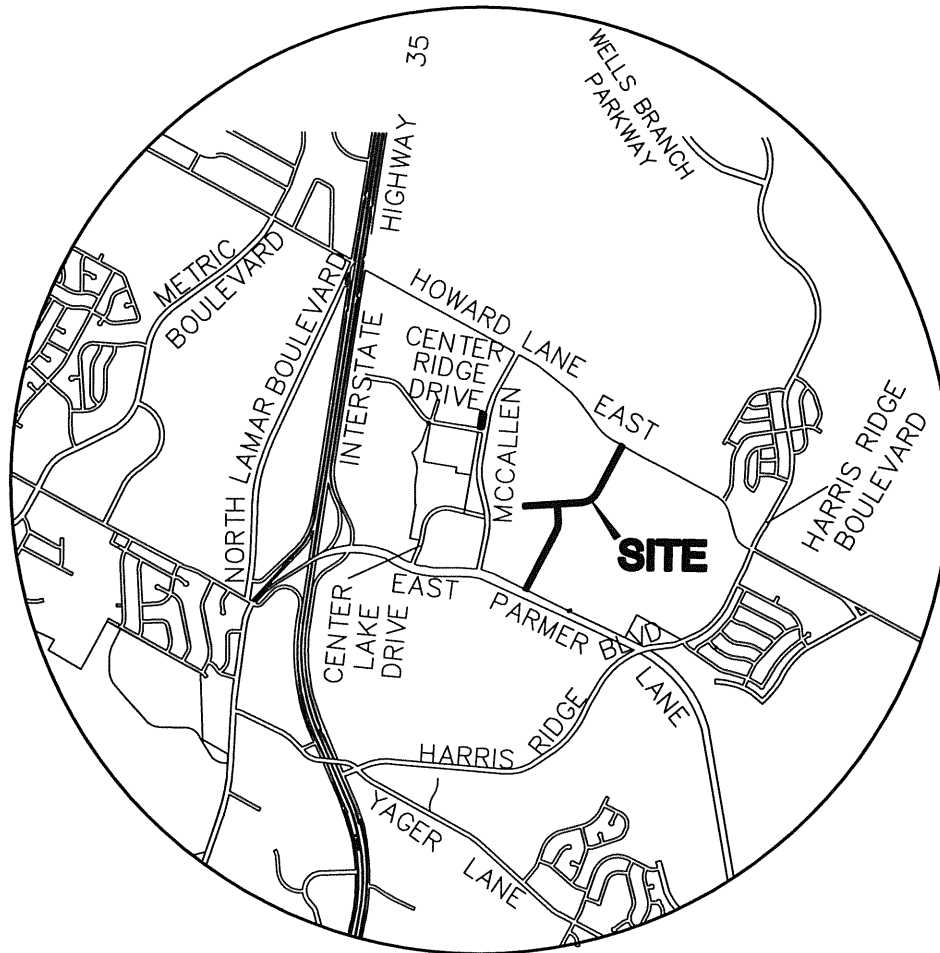

SITE LOCATION

NOT TO SCALE



Stantec

221 West Sixth Street, Suite 600
Austin, Texas 78701
Tel. (512) 328-0011 Fax (512) 328-0325
TBPE # F-6324 TBPLS # F-10194230
Copyright © 2016

PARMER BUSINESS PARK
PRIVATE DRIVE

KARLIN MCCALLEN PASS, LLC

PROJECT
LOCATION MAP

DATE: 11-09-2016

SCALE: N.T.S.

DRAWN BY: RCS

FILE: V:\2220\active\222010025\civilcad\CD Exhibits\SITE LOCATION

PROJECT No. 222010025