

SUBDIVISION REVIEW SHEET**CASE NO.:** C8J-06-0232.02.3A**ZAP DATE:** March 21, 2017**SUBDIVISION NAME:** Bellingham Meadows Ph. I & II (Small Lot Subdivision)**AREA:** 12.15**LOT(S):** 74**OWNER/APPLICANT:** RSI Communities Teas
(Angelica Andersson)**AGENT:** Cunningham -Allen
(Curtis Morriss)**ADDRESS OF SUBDIVISION:** Farmhaven Road**GRIDS:** R29**COUNTY:** Travis**WATERSHED:** Gilleland Creek**JURISDICTION:** Full Purpose**EXISTING ZONING:** N/A**MUD:** N/A**NEIGHBORHOOD PLAN:** N/A**PROPOSED LAND USE:** SF, ROW**ADMINISTRATIVE WAIVERS:****VARIANCES:** None**SIDEWALKS:** Sidewalks will be provided on both sides of all internal streets and the subdivision side of boundary streets.**DEPARTMENT COMMENTS:** The request is for approval of the Bellingham Meadows Ph. I & II (Small Lot Subdivision). The proposed plat is composed of 74 lots on 12.15 acres.**STAFF RECOMMENDATION:** The staff recommends disapproval of the plat. This plat does not meet all applicable State and City of Austin LDC requirements.**PLANNING COMMISSION / ZONING AND PLATTING ACTION:**

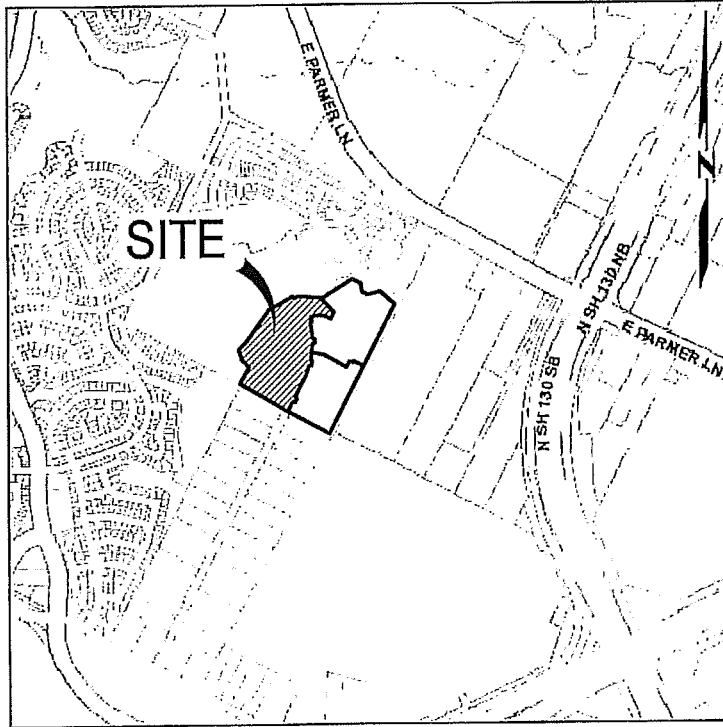

VICINITY MAP

SCALE: NTS

ZAP
11686847