

SUBDIVISION REVIEW SHEET

CASE NO.: C8-2017-0035.0A

P.C. DATE: March 21, 2017

SUBDIVISION NAME: Lot 27, block 2 Allandale North Section and lot 33 A Block L;
Amended Plat Of

AREA: 0.60

LOT(S): 2

OWNER/APPLICANT: AG
(Amanda Grubb)

AGENT: Hector Avila

ADDRESS OF SUBDIVISION: 1802 PALMWOOD CV

GRIDS: MK30

COUNTY:

WATERSHED: Shoal Creek

JURISDICTION:

EXISTING ZONING:

NEIGHBORHOOD PLAN: Crestview/Wooten Combined

PROPOSED LAND USE: SF

ADMINISTRATIVE WAIVERS: None

VARIANCES: None

SIDEWALKS: Sidewalks will be provided on both sides of all internal streets and the subdivision side of boundary streets.

DEPARTMENT COMMENTS: The request is for approval of the Lot 27, block 2 Allandale North Section and lot 33 A Block L; Amended Plat Of. The proposed plat is composed of 2 lots on 0.60 acres.

STAFF RECOMMENDATION: The staff recommends disapproval of the plat. This plat does not meet all applicable State and City of Austin LDC requirements.

PLANNING COMMISSION ACTION:

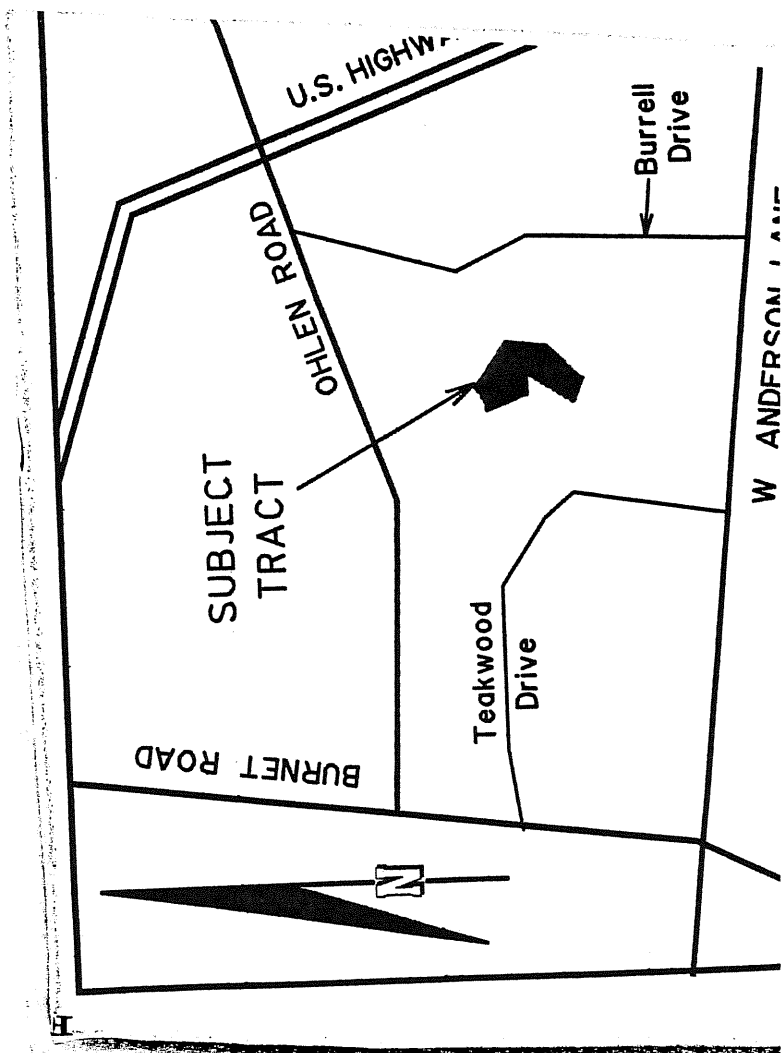

PC

11681226