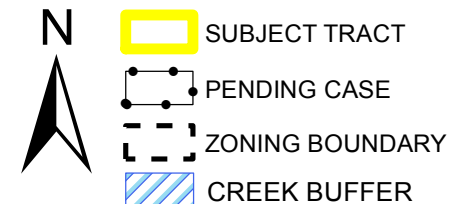

EXHIBIT A - AERIAL



ZONING CASE#: C14-85-288.22 (RCA)
 LOCATION: 7919 W. SH 71
 SUBJECT AREA: 7.65 ACRES
 GRID: B20
 MANAGER: ANDREW MOORE



This map has been produced by the Communications Technology Management Dept. on behalf of the Planning Development Review Dept. for the sole purpose of geographic reference. No warranty is made by the City of Austin regarding specific accuracy or completeness.