

**SUBDIVISION REVIEW SHEET****CASE NO.:** C8-2017-0101.0A**P.C. DATE:** May 23, 2017**SUBDIVISION NAME:** Kylee Addition**AREA:** 11.7**LOT(S):** 10**OWNER/APPLICANT:** (Interest Partners)**AGENT:** Enum Properties  
(Lisa Gray)**ADDRESS OF SUBDIVISION:** 7715 Del Wau Lane**GRIDS:** MN22**COUNTY:** Travis**WATERSHED:** Colorado River**JURISDICTION:** Full-Purpose**EXISTING ZONING:** N/A**MUD:** N/A**NEIGHBORHOOD PLAN:** N/A**PROPOSED LAND USE:** SF**ADMINISTRATIVE WAIVERS:****VARIANCES:** None**SIDEWALKS:** Sidewalks will be provided on both sides of all internal streets and the subdivision side of boundary streets.**DEPARTMENT COMMENTS:** The request is for approval of the Kylee Addition. The proposed plat is composed of 10 lots on 11.7 acres.**STAFF RECOMMENDATION:** The staff recommends disapproval of the plat. This plat does not meet all applicable State and City of Austin LDC requirements.**PLANNING COMMISSION / ZONING AND PLATTING ACTION:**

Kyle Addition  
7715 Delwau Ln

117164191  
2A8

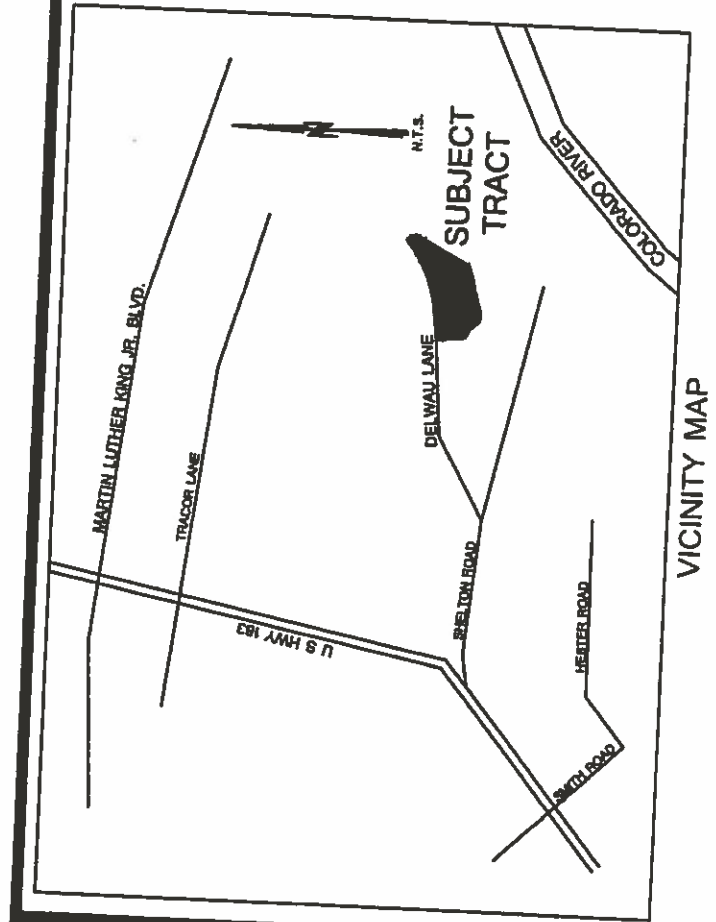

K