

SUBDIVISION REVIEW SHEET

CASE NO.: C8-2017-0130.1A**Z.A.P. DATE:** October 3, 2017**SUBDIVISION NAME:** Bellingham Meadows Phase II Section I Final Plat**AREA:** 23.443 acres**LOTS:** 91**APPLICANT:** RSI Communities-Texas
(Angelica Andersson)**AGENT:** Cunningham-Allen, Inc.
(Curtis L. Morriss, P.E.)**ADDRESS OF SUBDIVISION:** Boyce Lane & E. Parmer Lane**WATERSHED:** Gilleland Branch**COUNTY:** Travis**EXISTING ZONING:** I-SF-4A**JURISDICTION:** Full Purpose**PROPOSED LAND USE:** Single Family**VARIANCE:** none**STAFF RECOMMENDATION:** Staff recommends approval of the final plat, the plat meets all applicable State and City of Austin Land Development Code requirements.**DEPARTMENT COMMENTS:** The request is for the approval of the Bellingham Meadows Phase II Section 1 final plat composed 91 lots on 23.443 acres. The applicant proposes to subdivide the property for residential uses, ponds, open space, and roads. The developer will be responsible for all cost associated with required improvements.**CASE MANAGER:** Cesar Zavala**PHONE:** 512-974-3404**E-mail:** cesar.zavala@austintexas.gov

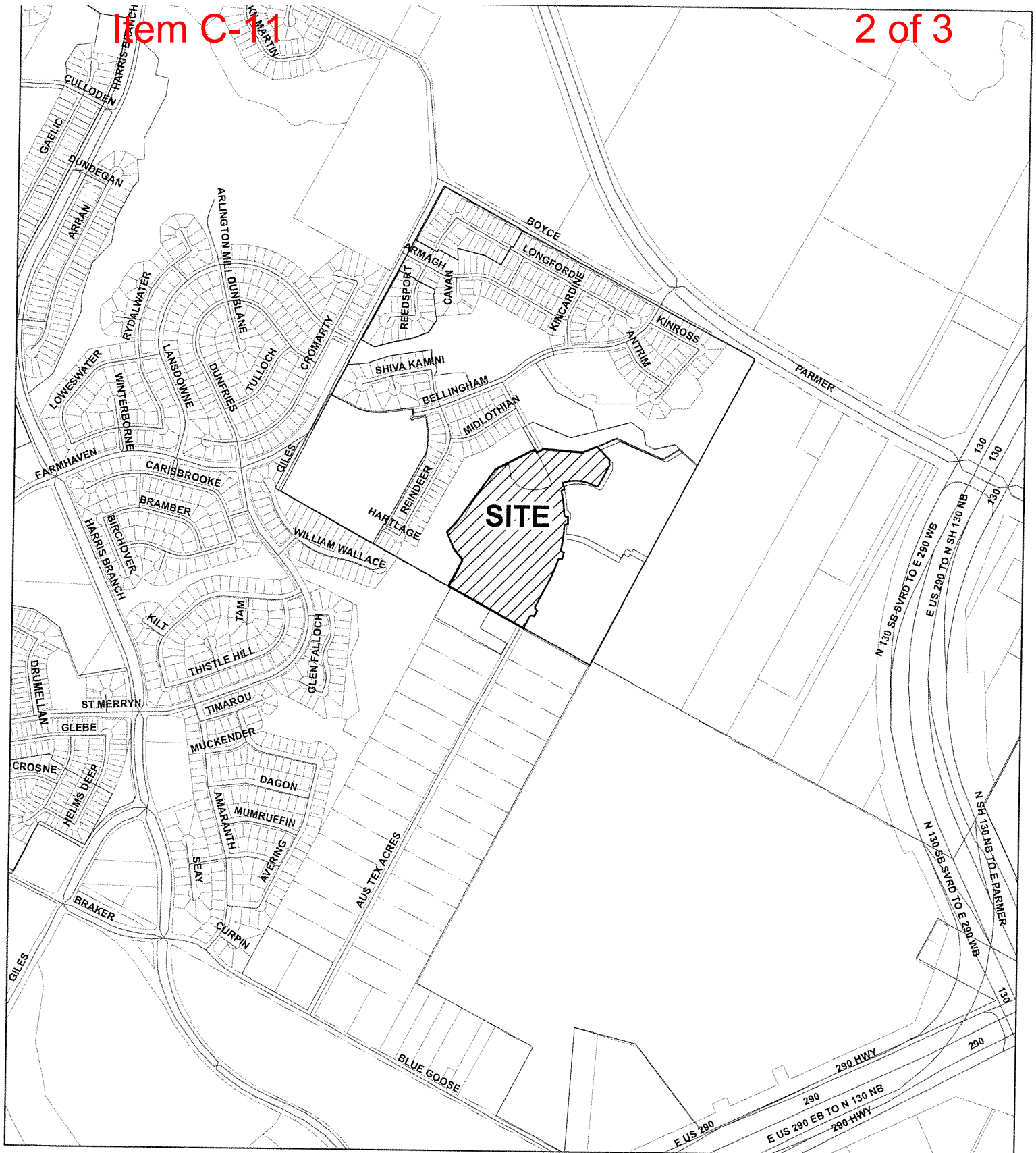

CASE#: C8-2017-0130.1A
ADDRESS: BOYCE LANE & E. PARMER LANE
PROJECT: BELLINGHAM MEADOWS PHASE II SECTION 1
CASE MANAGER: CESAR ZAVALA

This map has been produced by site plan review for the sole purpose of geographic reference. No warranty is made by the City of Austin regarding specific accuracy or completeness.

