



Recent photos of the new fence at 2801 Down Cove

iMessage
Thu, Jul 27, 1:20 PM

Love your new fence! A friend would like to know who your fence contractor is. I'm your neighbor behind Tommie's house.

Thu, Jul 27, 7:14 PM

I am really excited about the fence. I will send my contact. Thanks! Robbie

8/2/11

Hi Neighbors,

We are Kathy & Roger. we live directly across from your side yard (2639 BHD). Saw some "City of Austin Code Compliance" guys taking pix of your new, gorgeous fence. I spoke w/ them and they said someone complained. Was not us! We love it - refreshing to see something different & beautiful craftsmanship. told the guys that I like it

very much, even asked the installer & his daughter for bid on our fence.

Hope it all works out - new fence is beautiful!!

Thanks!!

- Kathy & Roger

Neighborhood support.



The arrow is going from our property at 2801 Down Cove to the Gus Fruh entrance of the Barton Creek Greenbelt. This is less than 450' away from the property.

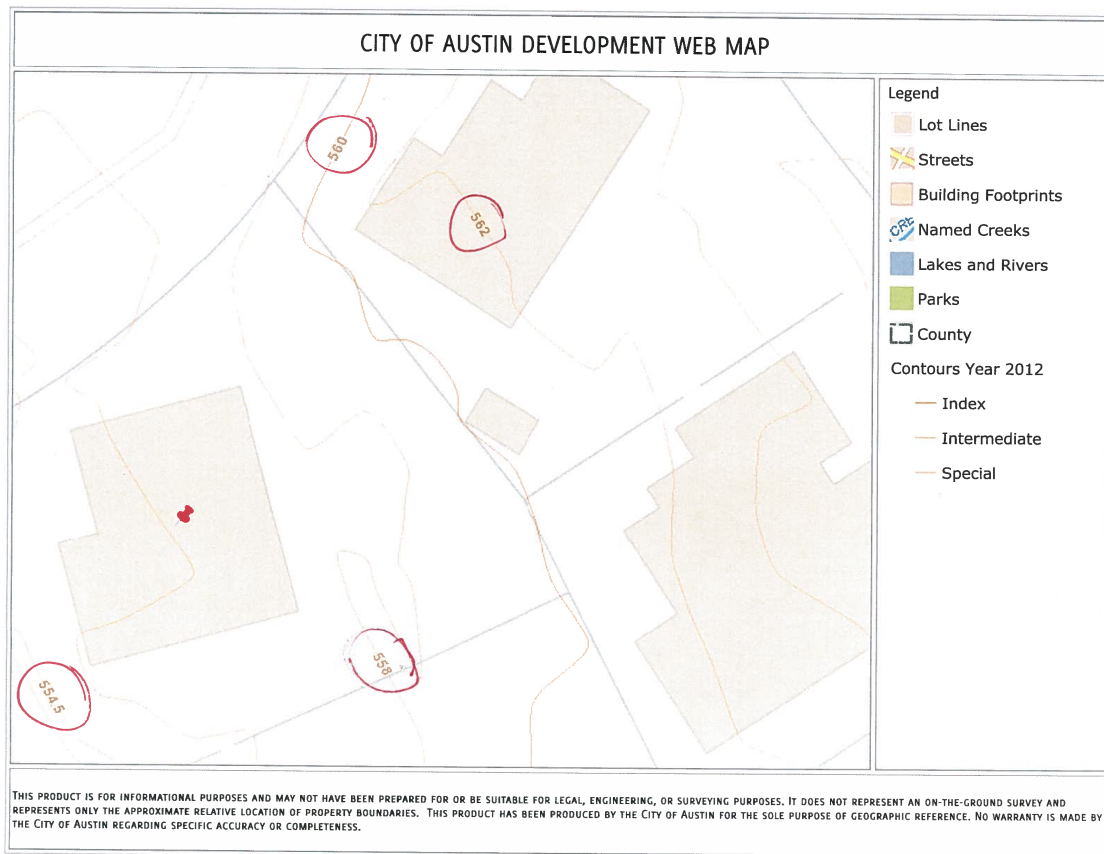

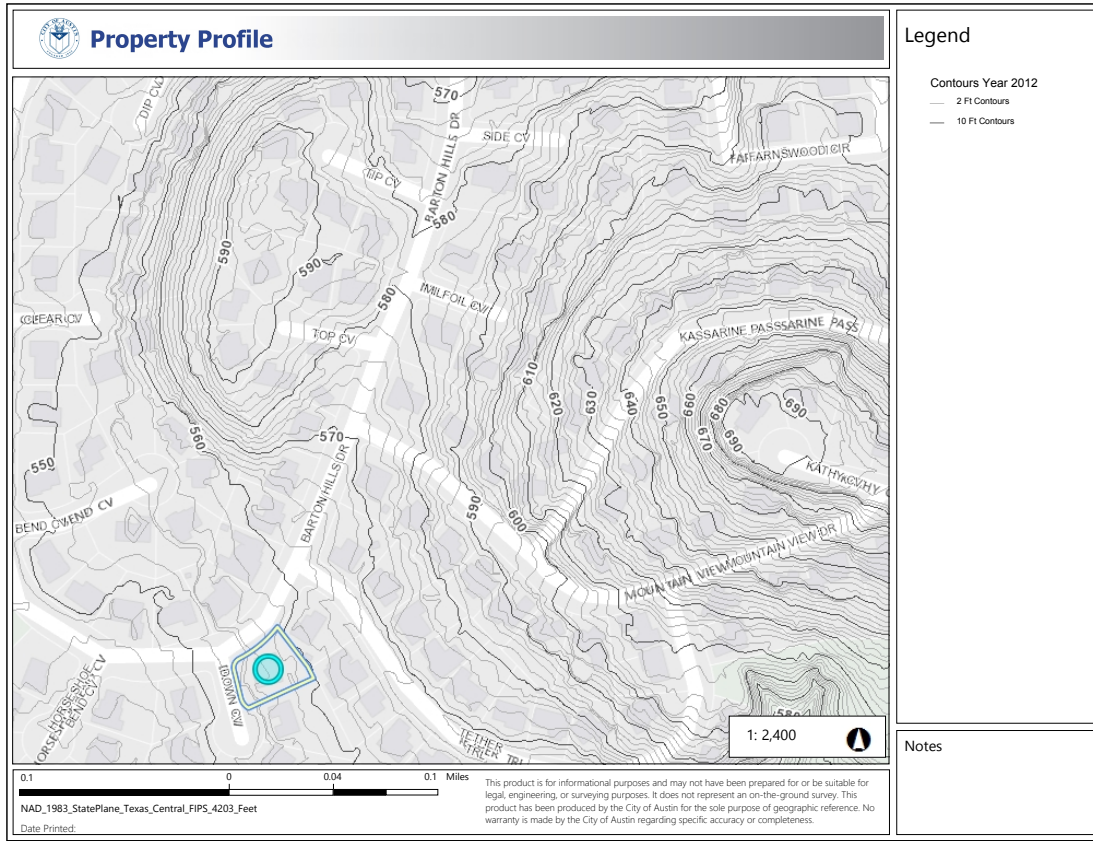

The topographical map shows that our property sits at 554.5' where as a few blocks away, with a straight shot view of our property, the elevation reaches over 580'. The neighbor that we share a fence with is at 562'.

We have plans for landscaping in front of the fence as soon as we know what the Board's decision is. Our children helped pick the plants that will be added to the front yard (Lantana, Pride of Barbados, Plumbago and Jasmine). We have put forth a lot of thought and effort into trying to create a safe and aesthetically pleasing area, not only for our family but to all of our neighbors and visitors to the area and we hope that the Board will grant the variance requested today.

Thank you! The Moseley Family