

SUBDIVISION REVIEW SHEET**CASE NO.:** C8-2018-0099.0A**ZAP DATE:** July 17, 2018**SUBDIVISION NAME:** 9921-1/2 E US 290 HWY SERVICE ROAD EB**AREA:** 66.3**LOT(S):** 5**OWNER/APPLICANT:** Decker Land Holdings LP
(Don Glatthorn)**AGENT:** Stantec Consulting Services, Inc.
(Augustine Verrengia)**ADDRESS OF SUBDIVISION:** 9921-1/2 East US 290 Highway Service Road, East Bound**DISTRICT NUMBER:** N/A**GRIDS:** MR28**COUNTY:** Travis**WATERSHED:** Gilleland Creek**JURISDICTION:** Full-Purpose**EXISTING ZONING:** Vacant**MUD:** N/A**NEIGHBORHOOD PLAN:** N/A**PROPOSED LAND USE:** Commercial**ADMINISTRATIVE WAIVERS:** N/A**VARIANCES:** None**SIDEWALKS:** Sidewalks will be provided on both sides of all internal streets and the subdivision side of boundary streets.**DEPARTMENT COMMENTS:** The request is for approval of the 9921-1/2 E US 290 HWY SERVICE ROAD EB plat. The proposed plat is composed of 5 lot(s) on 66.3 acres.**STAFF RECOMMENDATION:** The staff recommends disapproval of the plat. This plat does not meet all applicable State and City of Austin LDC requirements.**PLANNING COMMISSION / ZONING AND PLATTING ACTION:**

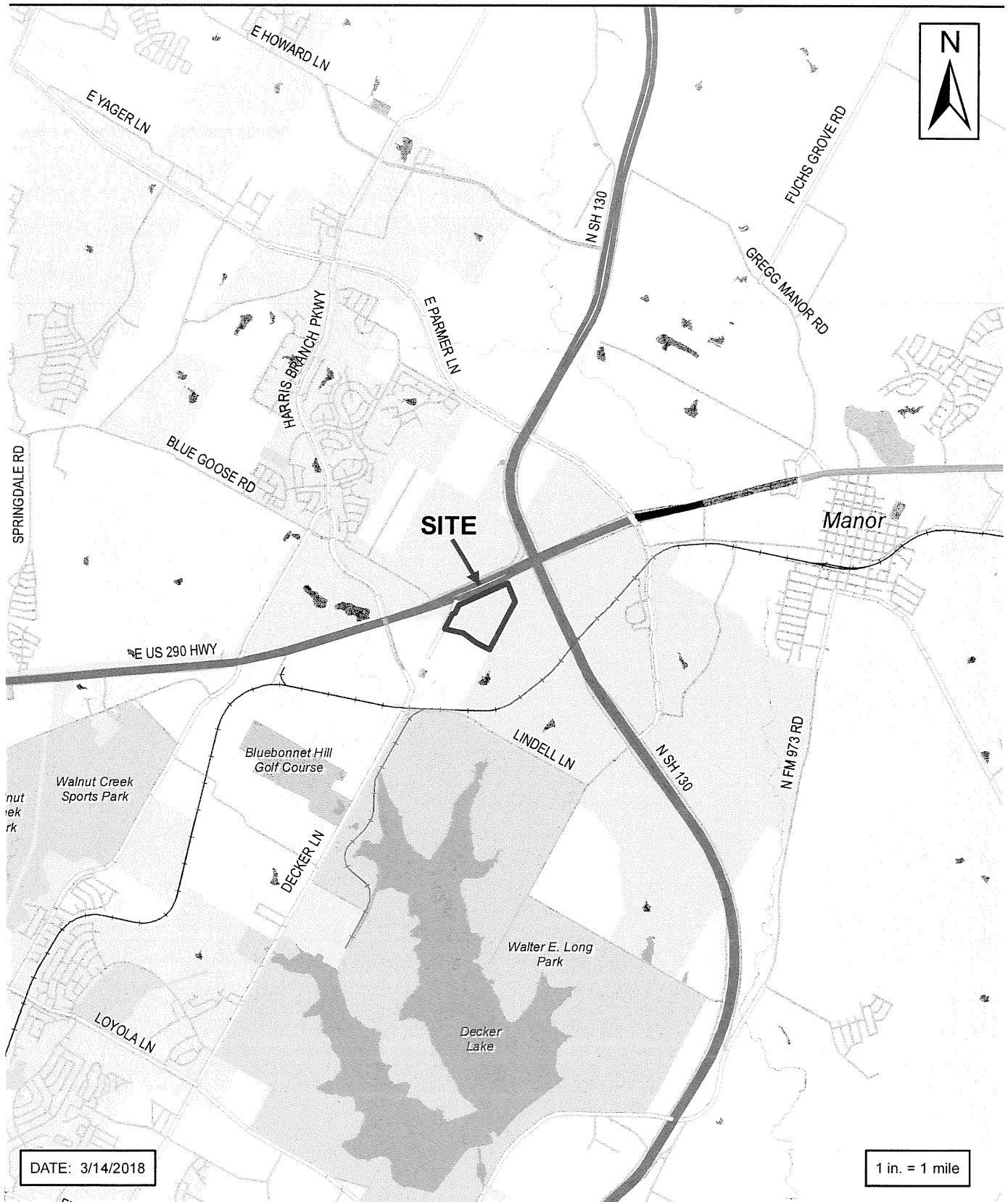

This exhibit is for graphical representation only and is based on the best information available and is subject to change without notice.

KITCHELL EAST
AUSTIN, TRAVIS COUNTY, TEXAS

PROJECT: 222011115

Stantec
1905 Aldrich St., Suite 300
Austin, Texas 78723
www.stantec.com

Tracking # 11971021