

12th Street Bridge at Shoal Creek

12th Street Bridge over Shoal Creek was damaged by a vehicle in June 2018. As a result, two sets of rails fell to the ground, as shown in Figure 1. Temporary water barriers have been installed for public safety, as shown in Figure 2.

A brief background of previous bridge railing colors, concrete work, and paintings are summarized below.

This railing is a standard section that has been installed at multiple locations throughout the city. Figures 3 and 4 show that the concrete surfaces and railings have been tagged and painted over numerous times in previous years: Figure 3 is a picture from November 2001, showing silver paint (galvanized) on railing and gray concrete, whereas figure 4, a Google Street View from August 2013, shows green paint on railing with painted/tagged concrete pedestals.

Construction plans from November 2001 and revision plans from April 2002 can be found in Figures 5 and 6, respectively. These plans indicate that railing posts were retrofitted in 2002. We propose repairing damaged posts and railings with in-kind material and repainting them to look similar to the original silver color.



Figure 1. Damaged Rail



Figure 2. Temporary Barriers



Figure 3. Silver Painted Rail with Gray Concrete (Dated November 16, 2001)



Figure 4. Google Street View (Dated August 2013)

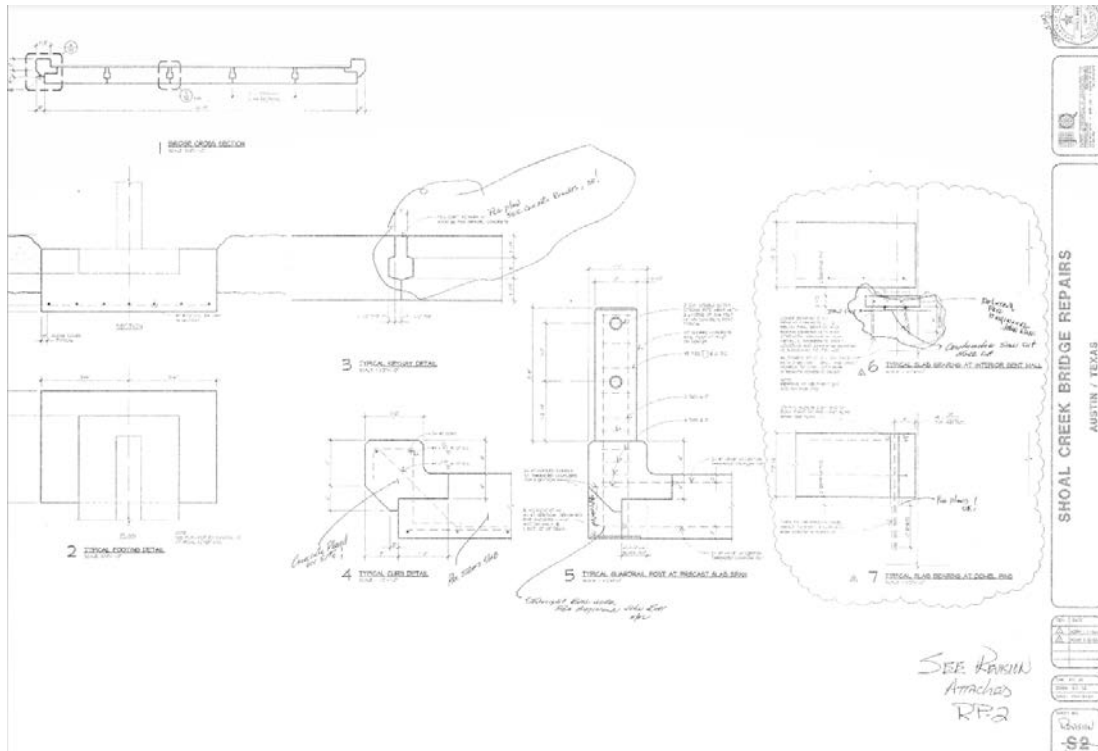

Figure 5. Construction Plan (Dated November 2001)

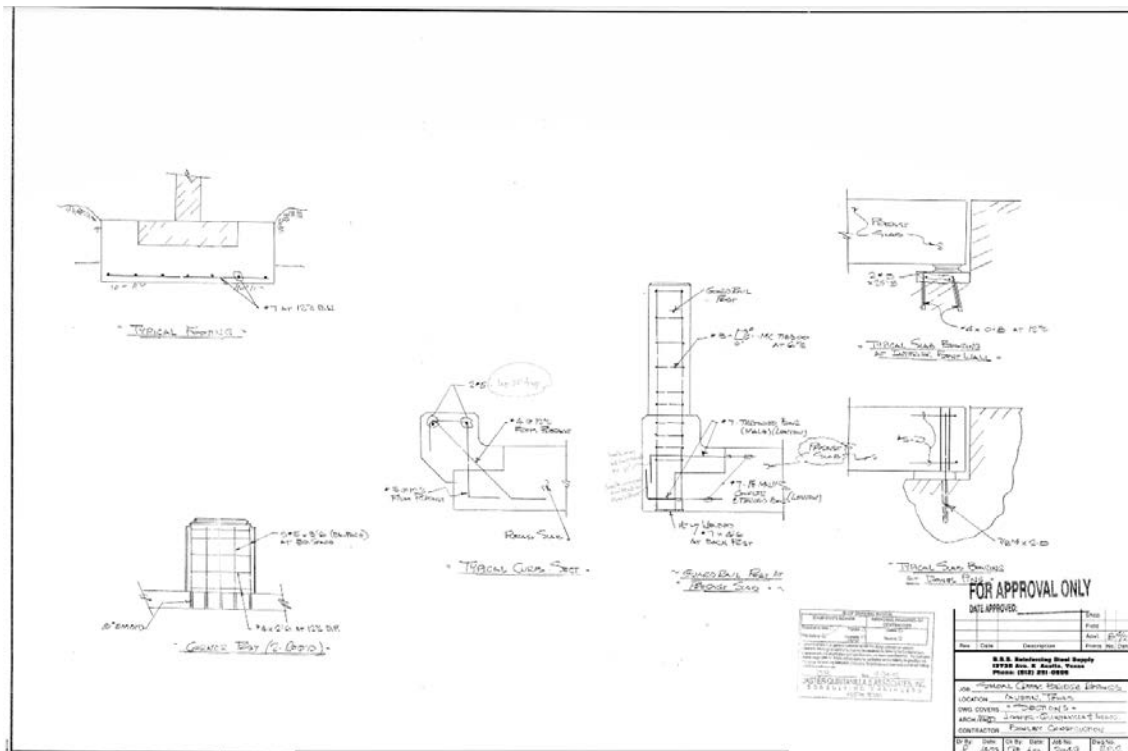

Figure 6. Revision of Construction Plan (Dated April 2002)