

Waterloo Park Design Update

Design Commission | August 28, 2018



ABOUT WALLER CREEK

WALLER CREEK CONSERVANCY IS A 501(C)(3) NON-PROFIT COMMUNITY PARTNER TO THE CITY OF AUSTIN IN THE REVITALIZATION OF THE 1.5-MILE STRETCH OF WALLER CREEK AND THE SURROUNDING DISTRICT.



PUBLIC
PRIVATE
PARTNERSHIP

In 2014, the City of Austin and the Waller Creek Conservancy executed a *Joint Development Agreement* outlining roles and responsibilities:

CoA responsibilities:

- Waller Creek Flood Control Tunnel construction and operation
- Maintenance and management of water systems
- Funding for infrastructure and improvements at City standards

WCC responsibilities:

- Lead role on design and construction of public spaces and parks
- Funding for improvements at a higher level than what the City can provide alone
- Maintenance and operation of public spaces following capital improvements and for providing funding beyond City budget

A CHAIN OF PARKS

35 ACRES OF RESTORED AND IMPROVED PUBLIC OPEN SPACE

THE DELTA

PALM PARK

THE REFUGE

WATERLOO PARK



A CONTINUOUS, ACCESSIBLE TRAIL ALONG THE RESTORED CREEK

A NEW PARKS DISTRICT FOR AUSTIN

NATURE. CULTURE. COMMUNITY.



CURRENT PROGRAMS & INITIATIVES



ARTS



ENVIRONMENT



HEALTH



HISTORY

PROGRAMS & EVENTS

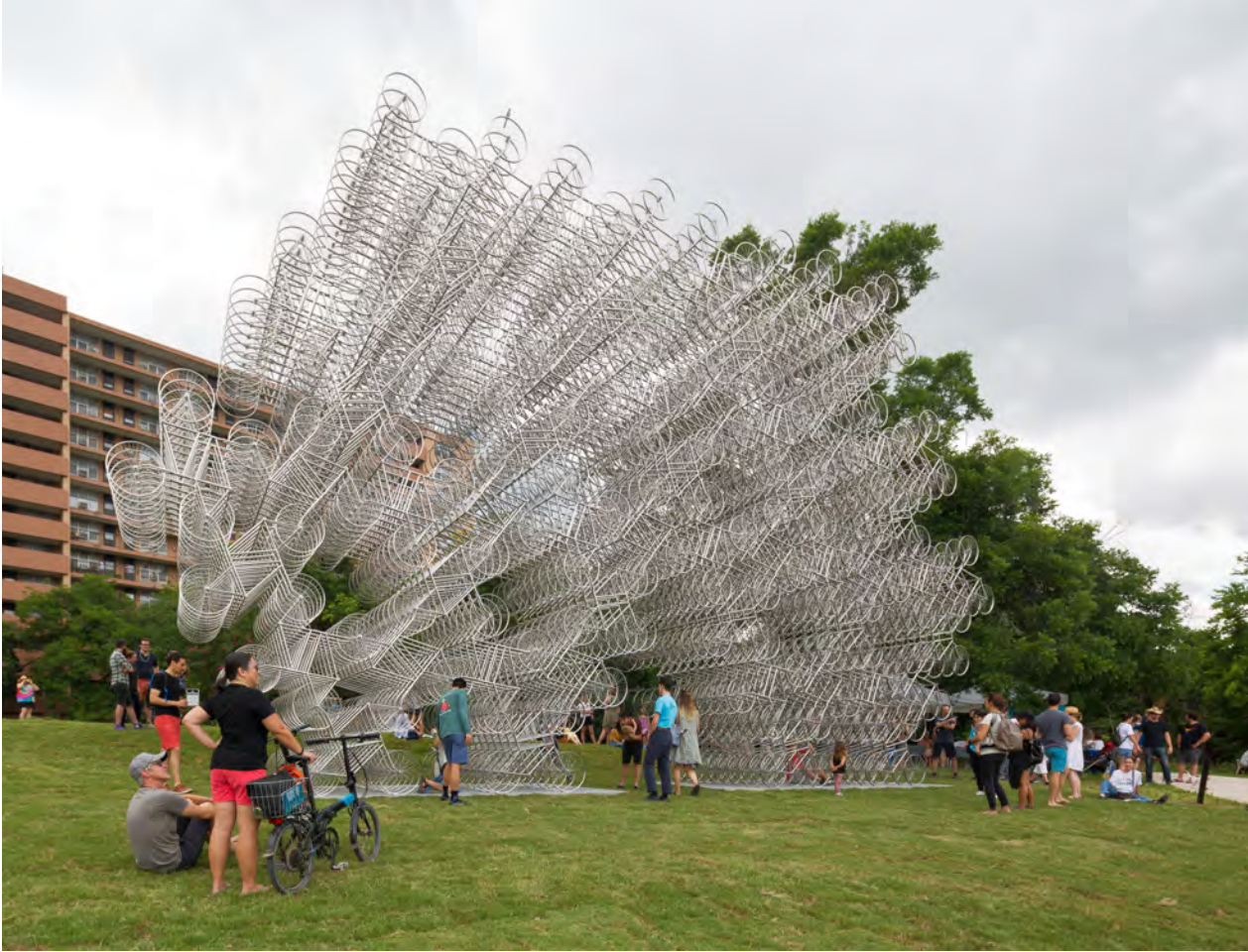

COMMUNITY ENGAGEMENT



Engagement Overview

2012: Design Competition: Led to selection of MVVA and TPP.

Included public meetings, feedback surveys, and design displays around the community

2015: Public meetings in August & online survey

Project overview with feedback for all park spaces

2016: Two Rounds of public meetings in May and September & online survey

Focused on programming in parks, using Palm Park as case study

2017: Town hall in Feb & public meetings in May & online survey

Explored important parks themes including: trails, lighting, and activities

2018: Two rounds of public meetings in February and June & online survey

Focused on food and concession services in parks: focus on Waterloo food program

2018: Aug/Sept - "Road Trip" Tabling at community events all over the City

General feedback including program, history, and how people use parks

2013-present: Presentations to dozens of neighborhood groups, organizations, businesses, educational institutions and more.

Project Update: Waterloo Park

WATERLOO PARK MOODY AMPITHEATER



Waterloo Park





Restoration and Nature



Playscapes



Food and Concessions



Moody Amphitheater

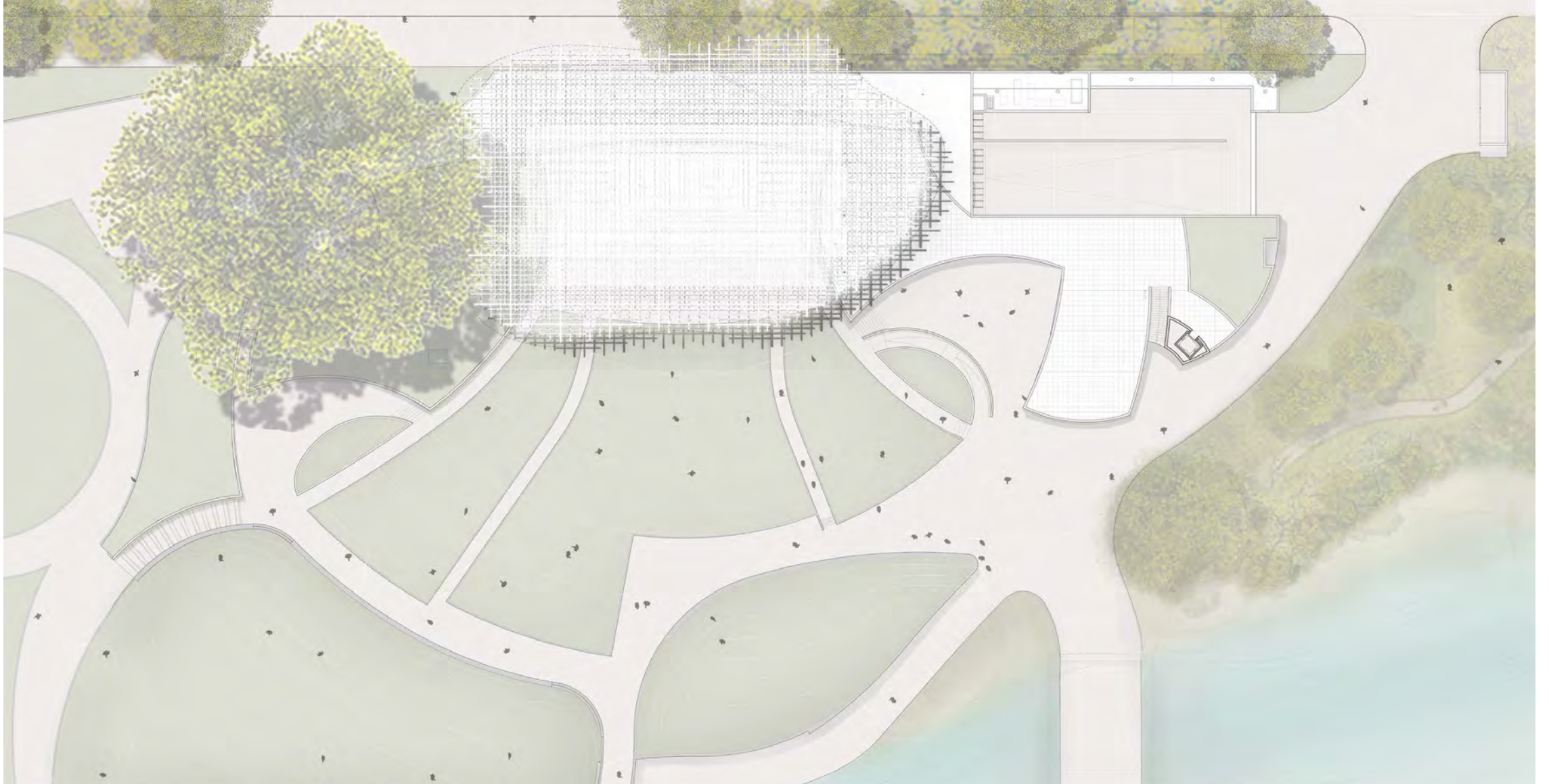



West Elevation: from Trinity St.

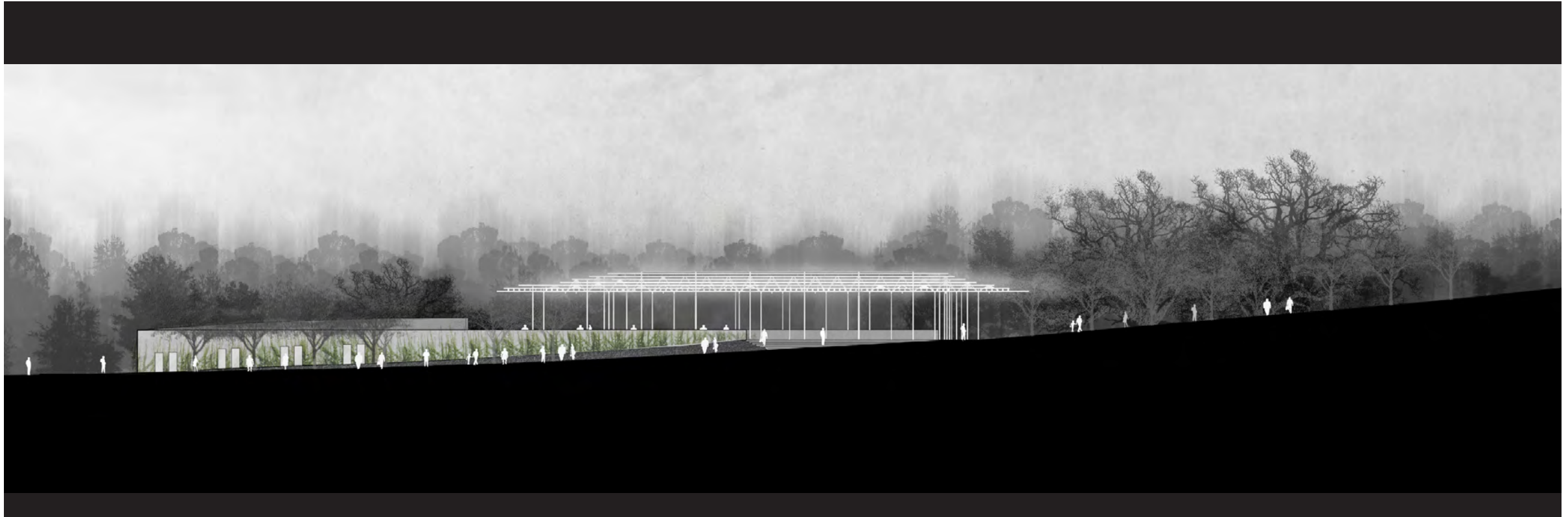

East Elevation: from Park

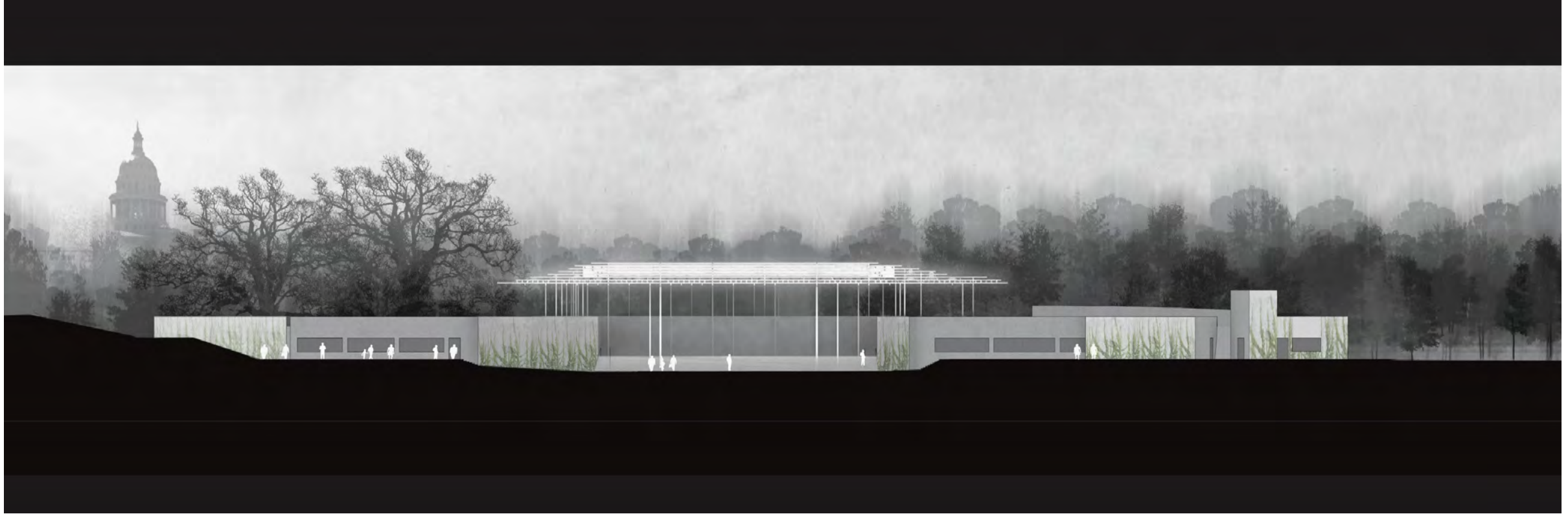

Section



Moody Amphitheater



WATERLOO PARK SCHEDULE

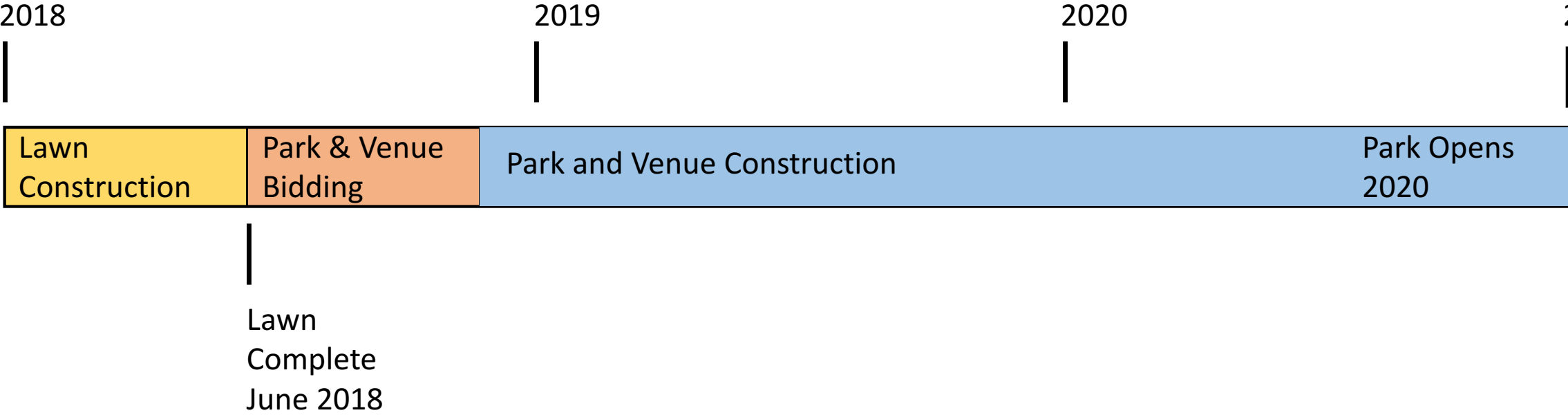

Questions?