

SUBDIVISION REVIEW SHEET**CASE NO.:** C8-2018-0152.0A**PC DATE:** September 25, 2018**SUBDIVISION NAME:** Hyde Park Amended Plat of Lots A & B Resub of Lots 17-24 Blck 21**AREA:** 0.3988**LOT(S):** 2**OWNER/APPLICANT:** W. Amon & Carol Cohen Burton Jr.**AGENT:** Masterplan (Karen Wunsch)**ADDRESS OF SUBDIVISION:** 4204 Avenue G**GRIDS:** K25**COUNTY:** Travis**WATERSHED:** Waller Creek**JURISDICTION:** Full-Purpose**EXISTING ZONING:** SF-3-HD-NCCD-NP**MUD:** N/A**NEIGHBORHOOD PLAN:** Hyde Park**PROPOSED LAND USE:** Single Family**ADMINISTRATIVE WAIVERS:****VARIANCES:** None**SIDEWALKS:** Sidewalks will be provided on both sides of all internal streets and the subdivision side of boundary streets.**DEPARTMENT COMMENTS:** The request is for approval of the Hyde Park Amended Plat of Lots A & B Resub of Lots 17-24 Blck 21 Final Plat. The proposed plat is composed of 2 lots on 0.3988 acres.**STAFF RECOMMENDATION:** The staff recommends disapproval of the plat. This plat does not meet all applicable State and City of Austin LDC requirements.**PLANNING COMMISSION / ZONING AND PLATTING ACTION:**

Tracking # 12029437

Legend

Jurisdiction

- FULL PURPOSE
- LIMITED PURPOSE
- EXTRATERRITORIAL JURISDICTION
- 2 MILE ETJ AGRICULTURAL AGR
- OTHER CITY LIMITS
- OTHER CITIES ETJ
- TCAD Parcels

Notes

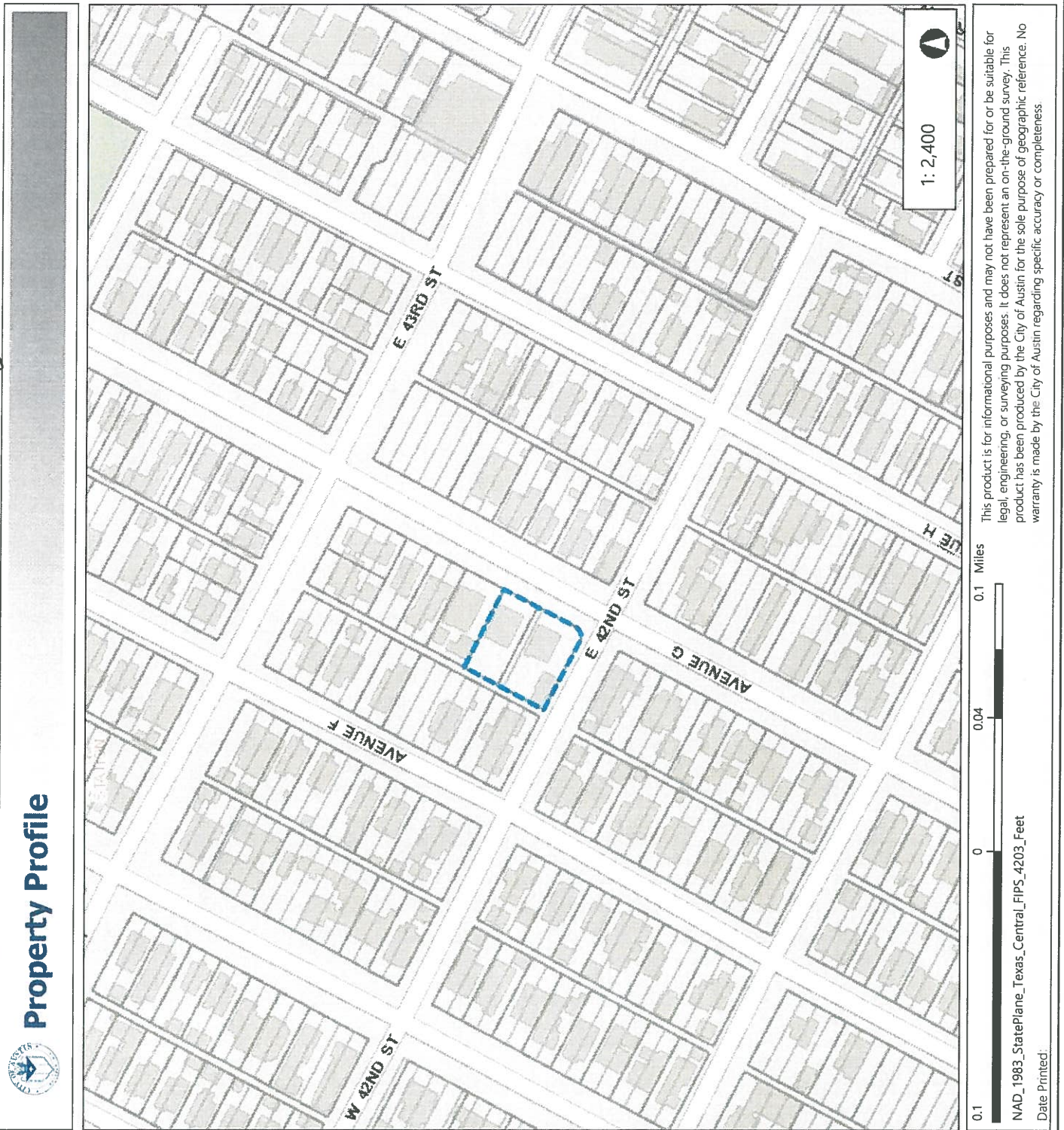

This product is for informational purposes and may not have been prepared for or be suitable for legal, engineering, or surveying purposes. It does not represent an on-the-ground survey. This product has been produced by the City of Austin for the sole purpose of geographic reference. No warranty is made by the City of Austin regarding specific accuracy or completeness.

0.1 Miles

0.04

0

NAD_1983_StatePlane_Texas_Central_FIPS_4203_Feet

Date Printed:

Property Profile

