

C:\Users\rlaufst\Documents\BIM\LOCAL\17062_ElizabethNey\2017_Central_rlaufst.rvt
10/4/2018 11:30:02 AM
LGA 3.0

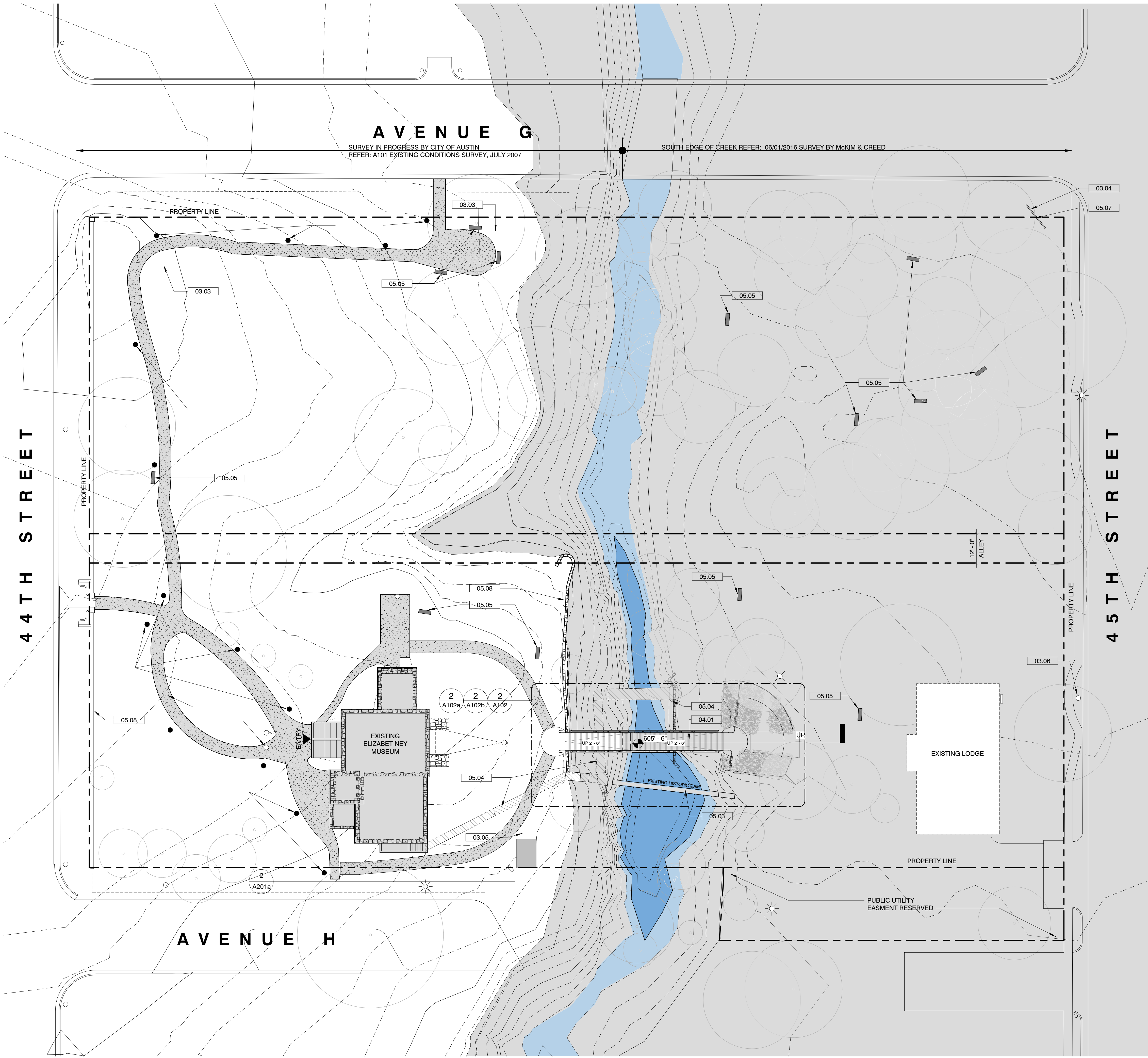

Site Lighting - General Notes

- Existing Lighting: There are very few existing site lights, and therefore the site gets very dark at night. General Security lighting shall be installed for the distinct and separate functional areas as defined below.
- Path Lighting: The Museum would like to conduct evening events on site and provide lighted access to 44th Street.
- Art Lighting: Art Pieces are currently installed around the site. Lighting for permanent and temporary art is desired.
- Gravel Area Lighting: The Lighting in this area must be studied and increased where necessary for security. A path from this area to the building must be lite.
- Event Lighting: A permanent solution for short term event lighting must be designed in North Lawn to provide flexibility for events.

SCOPE NOTES 01.00 - HISTORIC PRESERVATION OCA

No.	Keynote Text
-----	--------------

NO SITE SCOPE, REFER: HISTORIC PRESERVATION DRAWINGS

SCOPE NOTES 02.00 - SITE SECURITY JIG

No.	Keynote Text
-----	--------------

NO SITE SCOPE, REFER: ELECTRICAL DRAWINGS

SCOPE NOTES 03.00 - SITE LIGHTING - JIG

No.	Keynote Text
03.03	PROPOSED QUAD WP/WR POWER OUTLET.
03.04	PROPOSED GROUND BASED SPOT LIGHTS.
03.05	EXISTING ELECTRICAL PANEL, REFER. ELECTRICAL DRAWINGS.
03.06	EXISTING POWER POLE.

REFER: ELECTRICAL DRAWINGS

SCOPE NOTES 04.00 - BRIDGE - LG

No.	Keynote Text
04.01	PROPOSED ADA COMPLIANT BRIDGE.

SCOPE NOTES 05.00 - SITE IMPROVEMENTS - D+C

No.	Keynote Text
05.03	EXISTING HISTORIC STONE DAM TO REMAIN.
05.04	EXISTING BRIDGE, PATH, GUARDRAILS AND ABUTMENTS TO BE DEMOLISHED. GRADE SITE TO MATCH ADJACENT.
05.05	EXISTING STONE BLOCKS/BENCHES TO REMAIN.
05.07	EXISTING MUSEUM STREET SIGNAGE TO REMAIN.
05.08	EXISTING STONE SITE WALL TO REMAIN.

REFER: CIVIL DRAWINGS

SITE PLAN LEGEND

- 100 YR. FLOOD PLAIN
- EXIST. DECOMPOSED GRANITE
- NEW DECOMPOSED GRANITE
- SITE WORK TO BE DEMOLISHED

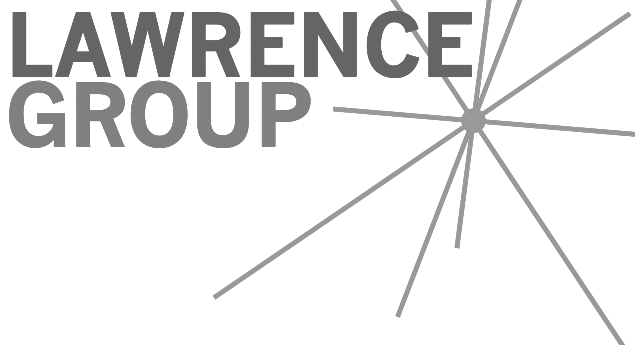

Austin Charlotte New York St. Louis

Office: 900 E. 6th St., Suite 105
Austin, TX 78702
p 512.391.1932
f 512.391.1920

Project Team:
Historic Preservation O'Connell Architecture
1405 W. 10th Street
Austin, TX 78703
p 512.751.1374
Tore O'Connell
MEP Jose I. Guerra, Inc.
2401 S. IH 35
Austin, TX 78741
p 512.445.2090
Debra Sharpe
Structural Structures
8929 N. Lamar Blvd.
Austin, TX 78752
p 512.499.0919
Dante Angelini
Civil Doucet & Associates
7401 TX-71 West, Ste 160
Austin, TX 78735
p 512.583.2623
Tom Curran

Professional Seal:

THIS DOCUMENT IS RELEASED
FOR THE PURPOSE OF

INTERIM REVIEW ONLY

EARL SWISHER, AIA
TEXAS LICENSE NO. 16683

THE DRAWING SHALL NOT BE USED
FOR CONSTRUCTION, BIDDING, OR
PERMIT PURPOSES.

Project Title:

60% DESIGN / DESIGN DEVELOPMENT
Elisabet Ney Museum
BUILDING RESTORATION & SITE IMPROVEMENTS
304 E. 44th St. Austin, TX 78751

The Professional Architect's seal affixed to this sheet applies only to the material and items shown on this sheet. All drawings, instruments or other documents not exhibiting this seal shall not be considered prepared by this architect, and this architect expressly disclaims any and all responsibility for such plans, drawings or documents not exhibiting this seal.

This drawing and details on it are the sole property of the architect and may be used for this specific project only. It shall not be loaned, copied or reproduced, in whole or part, or for any other purpose or project without the written consent of the architect.

No.	Description	Date

Sheet Title:

ARCHITECTURAL SITE PLAN

Project Number: 17062
Drawn By: NF
Issue Date: 10/04/18
Sheet Number: A101