

**HISTORIC LANDMARK COMMISSION
OCTOBER 22, 2018
DEMOLITION AND RELOCATION PERMITS
HDP-2018-0543
1105-09 N. IH-35**

PROPOSAL

Demolish a ca. 1965 former supermarket and a ca. 1972 former drug store.

ARCHITECTURE

The ca. 1965 former grocery store is a one-story, rectangular-plan, barrel-vaulted roofed masonry commercial building with a plate-glass storefront. The building reflects the corporate identity for Safeway supermarkets of the era. The ca. 1972 former drug store is a one-story, rectangular-plan, flat-roofed masonry commercial building with a stepped parapet and a plate-glass storefront.

RESEARCH

This land was the site of the original campus of Samuel Huston College in Austin. The land was purchased by benefactors for Samuel Huston College in 1880; the school remained on this site until it merged with Tillotson College in 1952 and the original site was sold.

What became Samuel Huston College started with the Methodist Episcopal church desire to construct a college for African-American students in Texas. The school was initially established in Dallas in 1878, but moved to Austin in 1880 with the purchase of this property. Although the school experienced starts and stops in the early years of its existence, it opened permanently in 1900 with Reuben S. Lovinggood as the president. Samuel Huston College was intended to be a liberal arts school, with emphasis on training teachers for the many new grade schools for African-Americans at the time. The school was named for an Iowa farmer, Samuel Huston, who donated property to the school. In 1952, Samuel Huston College merged with Tillotson College, another African-American college dating from the 1870s, and moved to the Tillotson campus on Chicon Street. The buildings on the Samuel Huston College were razed and the land sold. It remained vacant for many years through the construction of IH-35 over what was then East Avenue, until the construction of the Safeway supermarket here in 1965. The drug store to the south followed in 1972.

STAFF COMMENTS

Although neither of these buildings qualify as historic landmarks, the site is very significant as the original site of Samuel Huston College, and should have an archeological assessment to determine the existence of artifacts from the Samuel Huston College era or before.

STAFF RECOMMENDATION

Release the permit with the condition that the applicant conduct an archeological investigation of the site to ensure that any artifacts or other buried materials are excavated and preserved to provide information about the lifeways of the people associated with Samuel Huston College, located here from the late 19th century until 1952.

LOCATION MAP

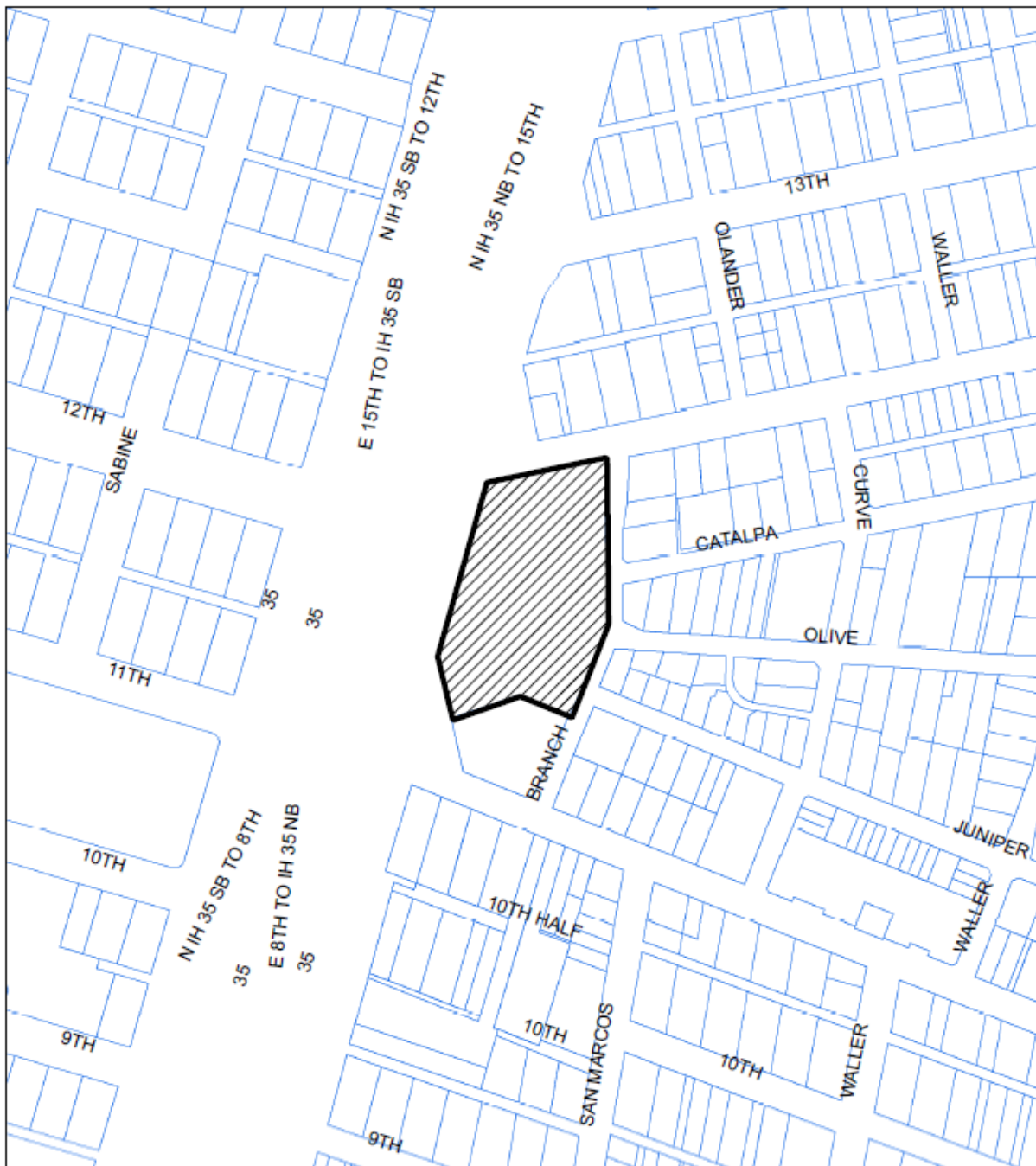

Subject Tract



Base Map

CASE#: HDP-2018-0543

LOCATION: 1105 N IH 35 SVRD NB

This product is for informational purposes and may not have been prepared for or be suitable for legal, engineering, or surveying purposes. It does not represent an on-the-ground survey and represents only the approximate relative location of property boundaries.

This product has been produced by the Planning and Development Review Department for the sole purpose of geographic reference.

1105-09 North IH 35
ca. 1965 for 1109 N. IH-35; ca. 1972 for 1105 N. IH-35



The ca. 1965 Safeway grocery store, 1109 N. IH-35



Ca. 1972 Eckerd's Pharmacy (later CVS), 1105 N. IH-35

OCCUPANCY HISTORY

1105-09 North IH 35

City Directory Research, Austin History Center
By City Historic Preservation Office
October, 2018

1992	1105: Eckerd Drugs 1107: State Support Center 1109: The address is not listed in the directory.
1985-86	1105: Eckerd Drugs 1107: The address is not listed in the directory. 1109: Safeway Stores, groceries
1981	1105: Eckerd Drugs 1107: The address is not listed in the directory 1109: Safeway Stores, groceries
1977	1105: Eckerd Drugs 1107: The address is not listed in the directory. 1109: Safeway Stores, groceries
1973	1105: Ward's Cut-Rate Drugs 1107: The address is not listed in the directory. 1109: Safeway Stores, groceries
1968	1105: The address is not listed in the directory. 1107: The address is not listed in the directory. 1109: Safeway Stores, groceries
1966	1105: The address is not listed in the directory. 1107: The address is not listed in the directory. 1109: Safeway Stores, groceries
1965	None of the addresses are listed in the directory.

SANITARY SEWER SERVICE PERMIT
Austin, Texas

Nº 61505

Received of MA 1105 N IH 35 Date 12-14-71
 Address 1105 N IH 35
 Amount 9-100
 Builder or Owner MA Plumber Maged Maal
 Lot 32 Block 32 Subdivision Samuel Houston Plat No. 32

Date of Connection 1-11-72
 By City 2" INTO MH 1431 IN BRANCH
 By Plumber BUENTELLO
 Checked By BUENTELLO
 Size Main 8" CONC Depth + 4'
 Main Assign. 5' EYUR
 Stub Depth 3 1/2' Prop. Line 3 1/2'
 Stub Location in Branch St
 Book No. A-6451 anywhere
 Paving Cut 11-9-71 No. 1104

No. Fittings	Size	Price
20	Pipe 6" P.C.C.	8.60
	Pipe	
	Wyes	
	Bends	
	Reducers	
	Plugs	
	Sand	
	Gravel	
	Remix	
	Stoppers	
	Castings	
	Other	
	BACKHOLE	6.00
	Labor: 18 HRS	40.50
	TRUCK	3.00
	FOREMAN	3.95
	Total	62.05

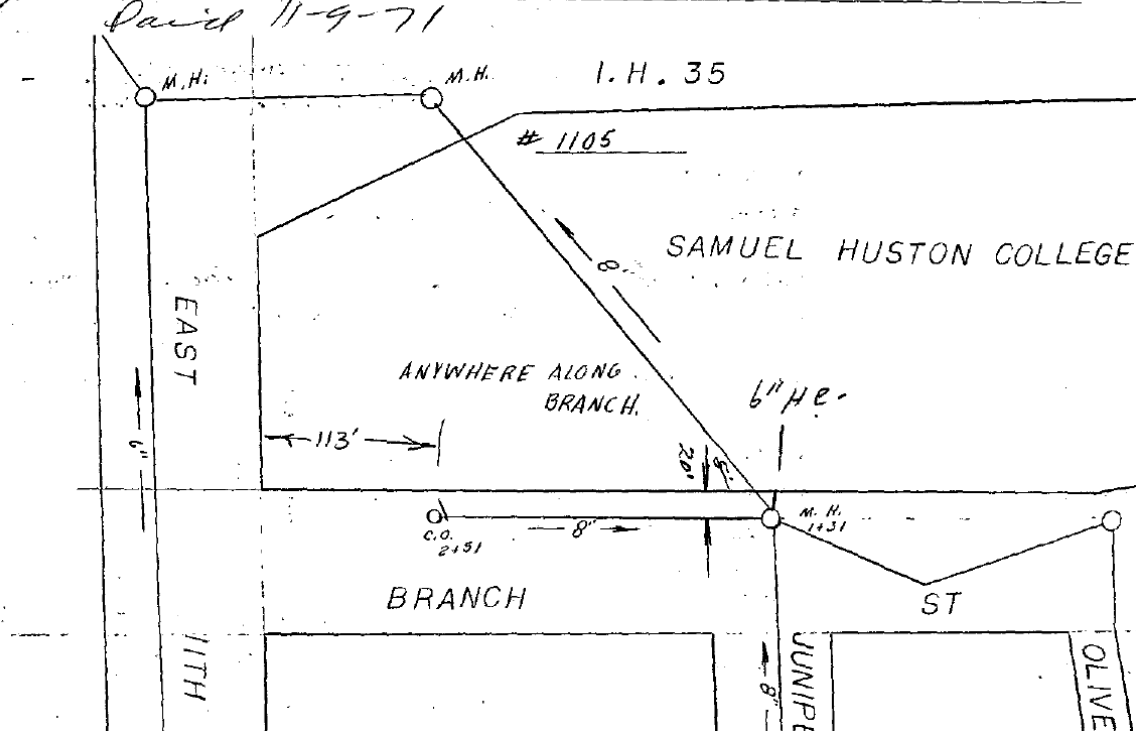

Sewer service permit, 1105 N. IH-35 (1971)

The old Eckerd Drugs became a CVS Pharmacy in 2004.

1109 North IH-35

New Safeway Store Opens Here Monday

A new Safeway store, featuring some 19,000 square feet of sales area, will open its doors for the first time Monday.

Located at 1109 Interregional, the store is the second of three new stores opening in Austin in 1965.

Included in the complex will be a spacious non-foods department, occupying 6,000 square feet. The convenient shopping facility contains numerous home and yard needs.

The interior of the store is set off with exposed laminated beams and decorated in custom shades of pink, red, green, blue and gold. Other features include automatic entrance and exit doors, seven check-stands, and a glass front with covered entrance.

The new store manager will be J. W. Dunn, who has served the company as manager of its East Sixth Street store seven

years. Other department heads are James Burnett, assistant manager; Claude Gann, meat department manager; Robert Spruill, produce; and James Walker, non-foods manager.

Parking facilities are provided for 148 cars.

Facilities in the various departments include 65-foot refrigerated cases for meat; 60-foot refrigerated produce and 72-foot dry produce displays; 124 feet of frozen food display; and dairy products with 65 feet of display.

The third of the new stores, located at Burnet Road and Whatley, is scheduled for a December opening.

There are as many as eight Selective Service boards in a county and as many as five counties in a board, depending upon the population of the area.

News story on the opening of the Safeway grocery store at 1109 N. IH-35
Austin American-Statesman, November 21, 1965



American-Statesman/UPI

New Safeway

Bill Dunn, left, manager, and James Burnett, assistant manager, stand in front of their new Safeway store at 1109 North Interregional. The new store opened for business Monday. Dunn lives at Route 5, Box 77, and Burnett lives at 1909 Ridgescreek.

Manager Bill Dunn and assistant manager James Burnett outside of the new Safeway grocery store at 1109 N. IH-35

Austin American-Statesman, November 25, 1965

Handwritten: TAP 37500

SANITARY SEWER SERVICE PERMIT
Austin, Texas

Nº 45018

Received of SAFEMAN STORES Date 10-12-65
 Address 1109 N. INTERREGIONAL
 Amount SEVENTY FIVE
 Builder or Owner HOUSTON COLLEGE Plumber Dunbar
 Lot FR. 3.5210 Block --- Subdivision UNPLOTED Plat No. 32

Date of Connection	By City	By Plumber	Checked By	Size Main	Depth	Main Assign.	Stub Depth	Prop. Line	Stub Location	Book No.	Paving Cut	No. Fittings	Size	Price
<u>10-18-65</u>	<u>28' N of MH. 74042</u>		<u>SWISHER</u>	<u>8"</u>	<u>±4'</u>	<u>11' NYER</u>			<u>To be C 74042</u>	<u>B-937</u>	<u>OK 10-11-65 JC</u>	33	Pipe 50" L 6"	4400
													Wyes	
													11' Bends CONG. 100	
													Reducers	
													Plugs	
													Sand	
													Gravel	
													Remix	
													Stoppers	
													Castings RAFTERS	300
													1 Other TAP	100
													1 SOIL BEND 6"	100
													Labor: 32 hr	4080
													TRUCK	150
													FOREMAN	246
													Total	9470

Sewer service permit, 1109 N. IH-35 (1965)

Samuel Huston College (ca. 1880 – ca. 1952)

Samuel Huston College was established in Dallas in 1876 by the Methodist Episcopal Conference for the education of African-American students. In 1878, the school moved to Austin, where it first held classes in a church. Approximately 6 acres of land on Robertson Hill was acquired for the original campus in 1880. The school closed in the 1890s due to financial difficulties, but reopened in 1900 on the Robertson Hill site. Several prominent buildings, including Burrowes Hall, the main building, and the Eliza Dee Home for girls, were constructed on the campus. Samuel Huston College merged with Tillotson College in 1952; the buildings were demolished and the school moved to the Tillotson College site on Chicon Street. The new school was known as Huston-Tillotson College.

Samuel Huston College was named for Samuel Huston, a farmer from Marengo, Iowa, who donated property to the school. Burrowes Hall, the main building on the old Samuel Huston College campus, was dedicated to another major benefactor, E.T. Burrowes, of Maine.

The school depended upon the generosity of many Austinites of both races, for its survival. When the school first opened, there was no furniture, books, or other supplies. Austin citizens of both races donated money, goods, and services to the struggling institution until it was stable. The first president was Reuben S. Lovinggood, a native of South Carolina, who came to Austin to oversee the administration of the school after teaching and leading in the Birmingham, Ala. public schools and Wiley University.

Samuel Huston College was a liberal arts school, with a particular emphasis on training teachers for the segregated schools of Texas and the South. Women were trained in domestic science at the Eliza Dee Home on the campus.

No Sanborn maps show the buildings on the old Samuel Huston College campus.



BURROWES HALL, SAMUEL HUSTON COLLEGE



Eliza Dee Home, Samuel Huston College