



MEMORANDUM

\*\*\*\*\*

TO: James Shieh, Chair  
Planning Commission Members

FROM: Wendy Rhoades   
Planning and Zoning Department

DATE: November 6, 2018

RE: **C14-2015-0062.01 – Met Campus PDA Amendment**  
Request for Indefinite Postponement by the Applicant

\*\*\*\*\*

The Applicant requests an indefinite postponement of the above-referenced rezoning Planned Development Area (PDA) Amendment case. Please refer to attached correspondence.

Attachment: Map of Property

**Rhoades, Wendy**

---

**From:** Victoria <Victoria@throwerdesign.com>  
**Sent:** Tuesday, November 06, 2018 10:34 AM  
**To:** Rhoades, Wendy  
**Cc:** Ron Thrower  
**Subject:** Met Center PDA - C14-2015-0062.01

Wendy –

We are seeking an indefinite postponement for this PDA amendment and will follow-up at a later date for moving forward.

Thank you,

**Victoria Haase**

*Thrower Design*

510 South Congress Avenue, Suite 207

Mail: P.O. Box 41957

Austin, Texas 78704

512-476-4456

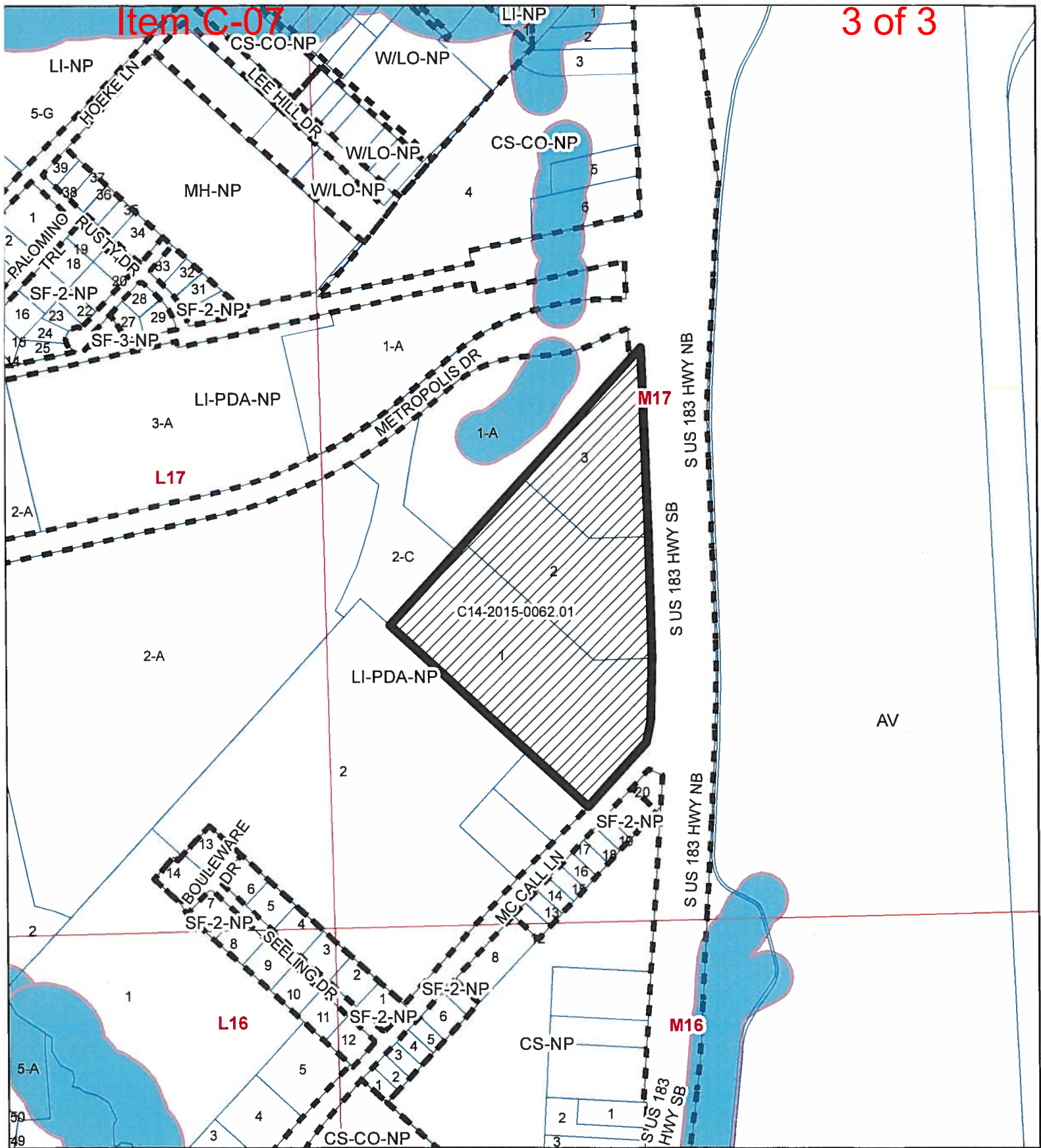

N



1" = 500'



SUBJECT TRACT



PENDING CASE



ZONING BOUNDARY



CREEK BUFFER

# MET CAMPUS PDA AMENDMENT

Exhibit A

ZONING CASE#: C14-2015-0062.01

LOCATION: 2900-3024 US 183 SB

SUBJECT AREA: 22.61 ACRES

GRID: M17

MANAGER: WENDY RHOADES

This map has been produced by the Communications Technology Management Dept. on behalf of the Planning Development Review Dept. for the sole purpose of geographic reference. No warranty is made by the City of Austin regarding specific accuracy or completeness.

