

REFERENCE PLANS FOR LOCATION OF GRAVEL SUMP AT WATER FOUNTAIN STATION

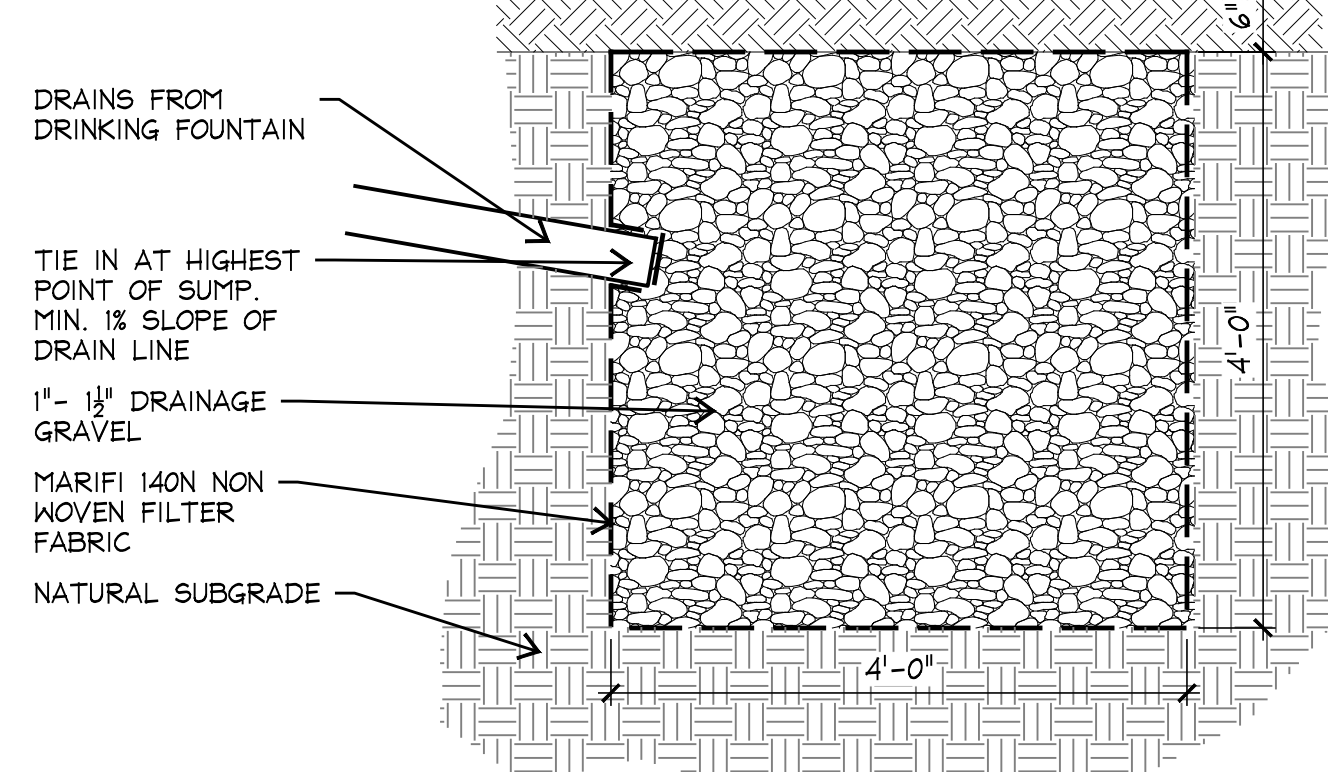

6 GRAVEL SUMP SECTION

SCALE: 3/4"=1'-0"

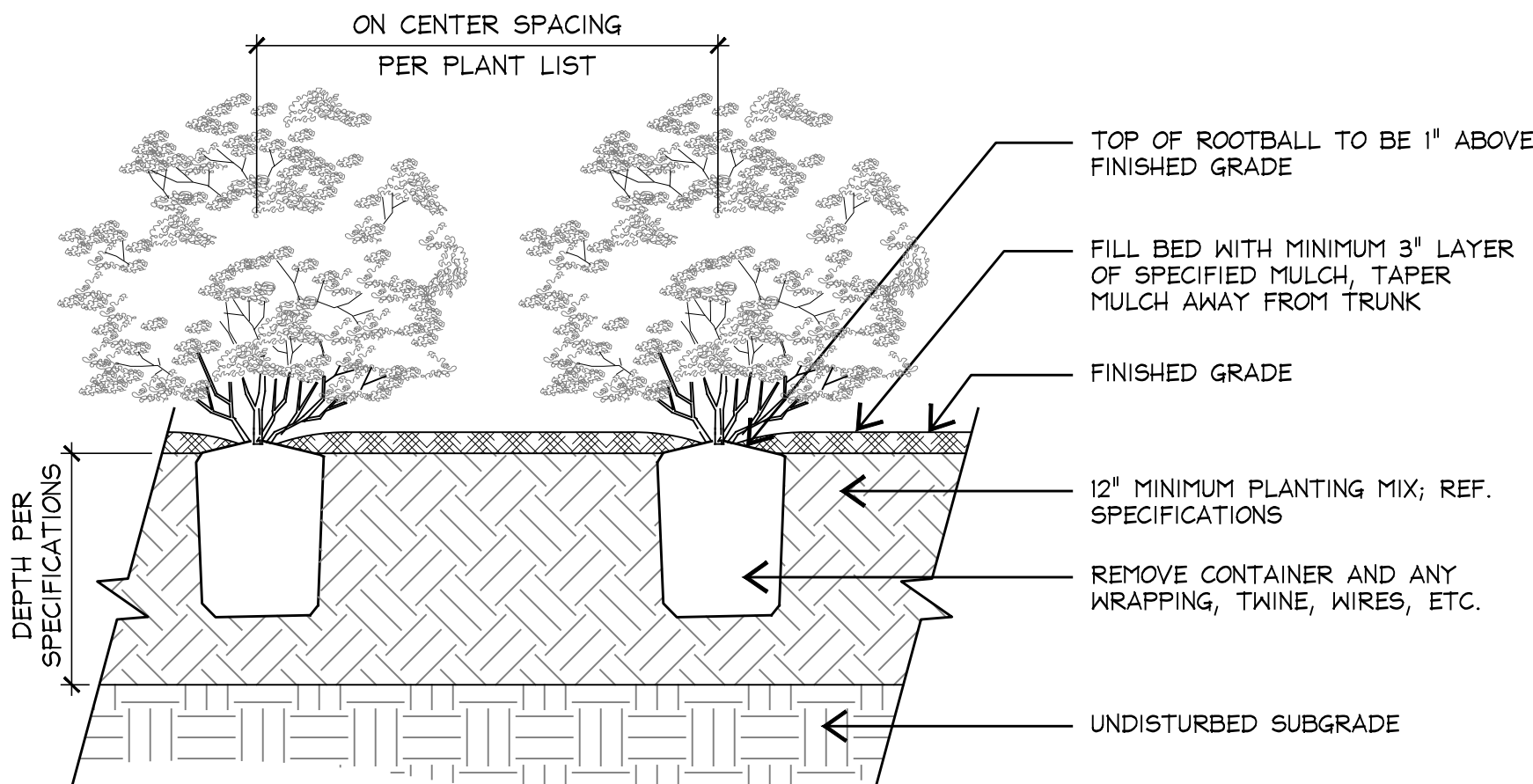

5 SHRUB BED PLANTING SECTION

NOT TO SCALE

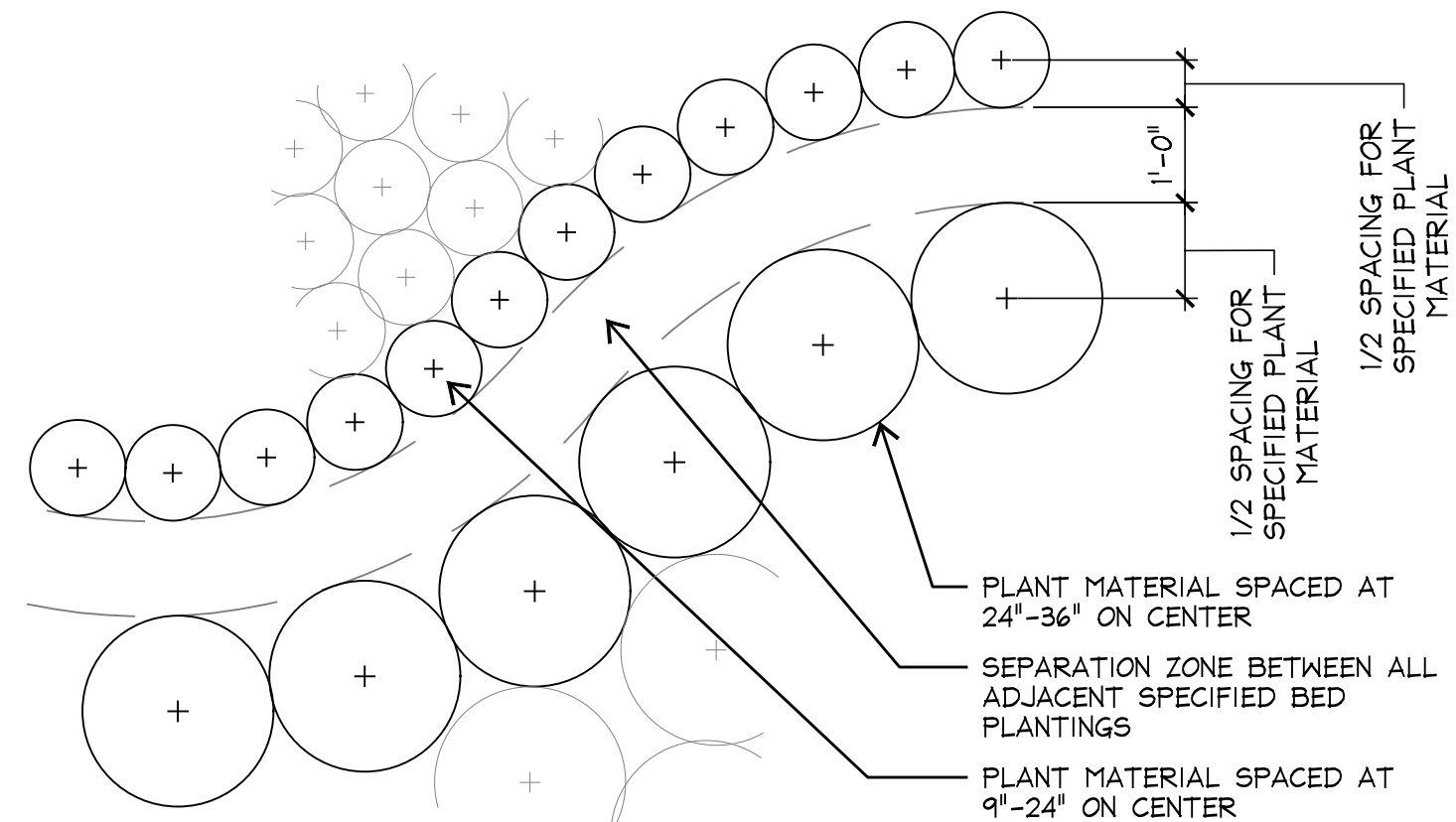

NOTE: THIS DETAIL IS DRAWN TO SHOW THE INTENDED PLANTING LAYOUT OF ADJACENT SHRUB BEDS ALONG CURVES. CONTRACTOR TO PLANT ALL PERIMETER OF BED AREAS AS SHOWN AND THEN PLANT THE REMAINDER OF THE BED TRIANGULARLY AT THE SPECIFIED SPACING.

4 CURVED BED LAYOUT PLAN

NOT TO SCALE

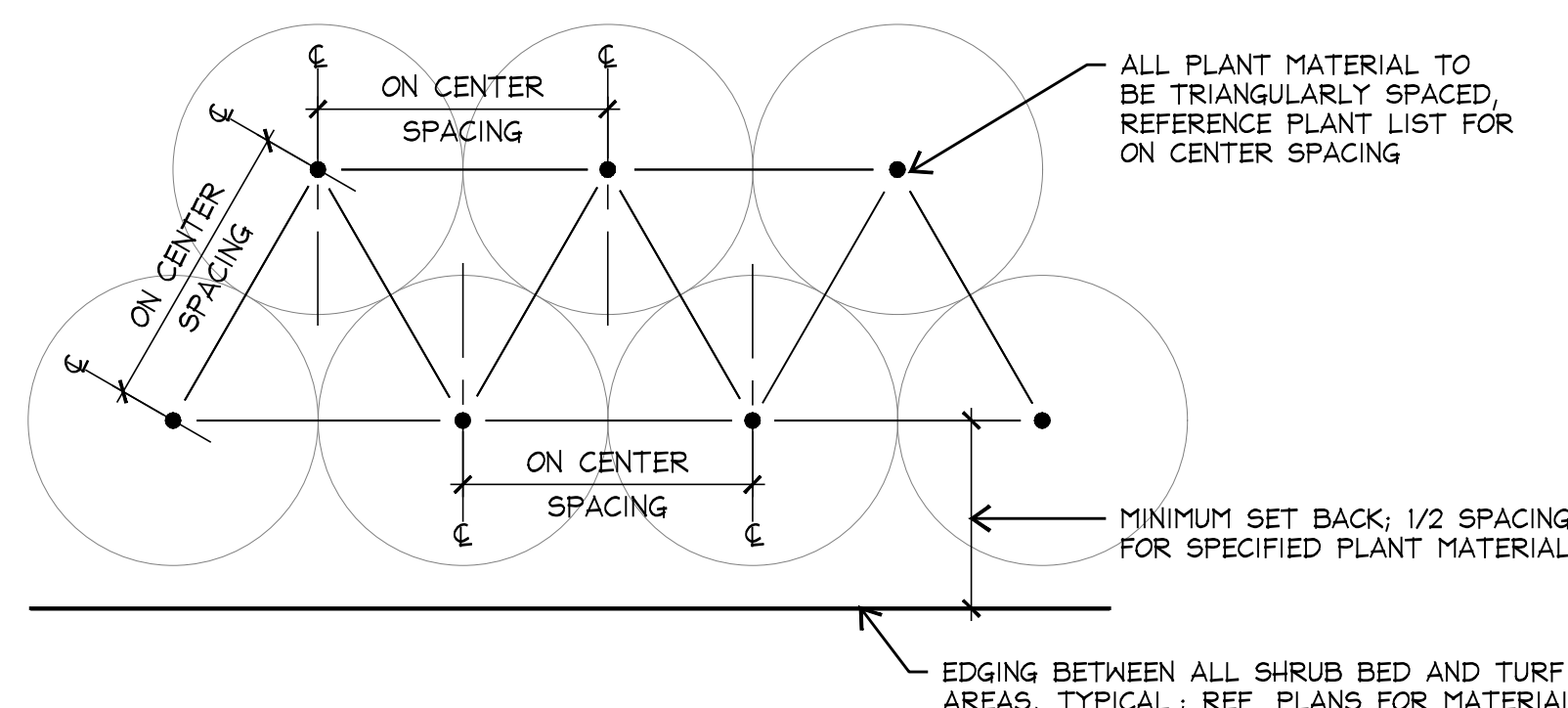

3 PLANT SPACING DIAGRAM PLAN

NOT TO SCALE

POST AND TIES ARE TO BE ESTABLISHED WITHOUT HARMING THE TREE (E.G. NON-BINDING STRAPS, POSTS ESTABLISHED OUTSIDE OF ROOTBALL) BUT ENSURE THAT ALL STAKING MATERIAL IS REMOVED AFTER ONE YEAR.
SEE ANSI A300 (PART 1) FOR ADDITIONAL INFORMATION REGARDING PRUNING STANDARDS
SEE ANSI 260.1 FOR NURSERY STANDARDS

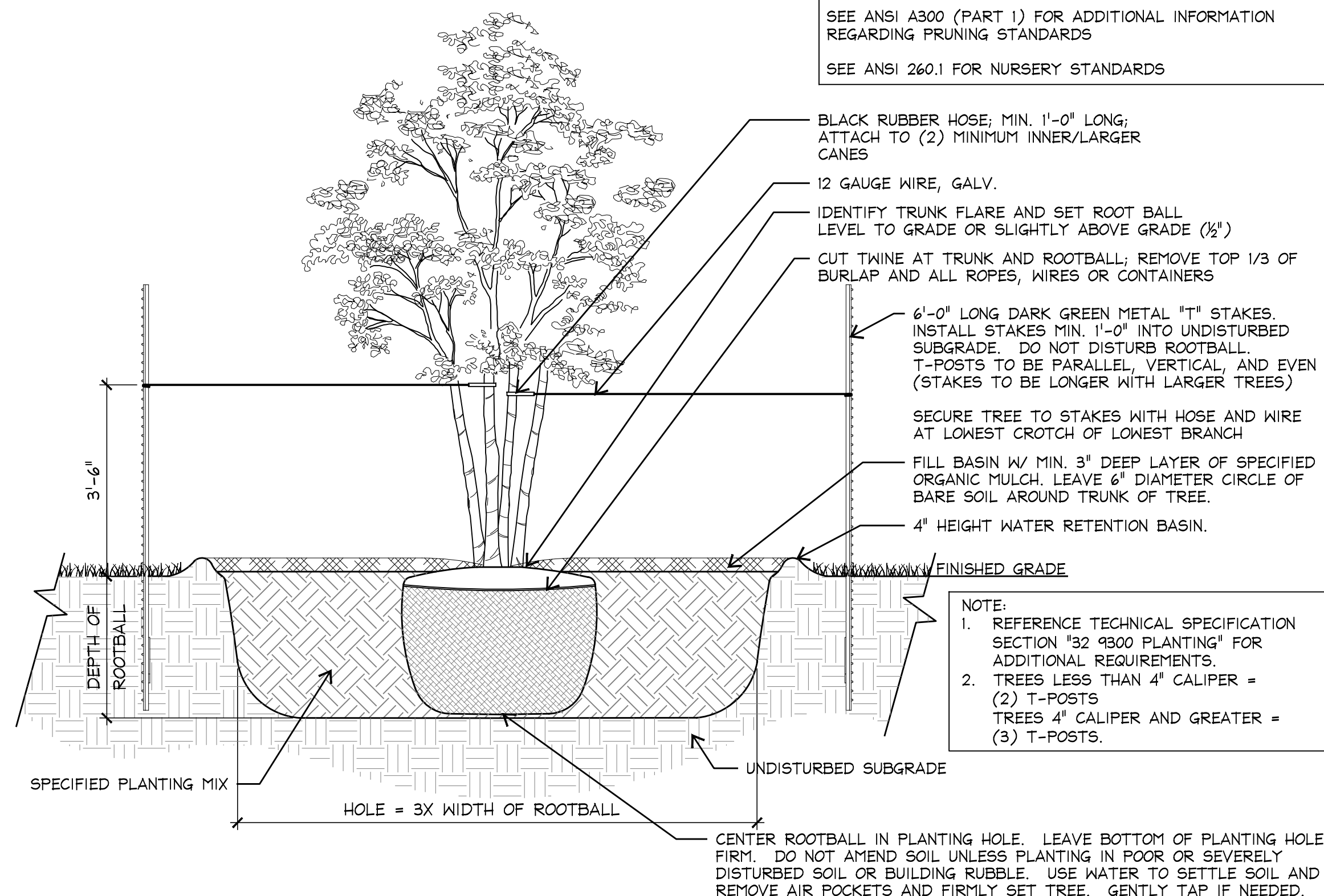

NOTE:
1. REFERENCE TECHNICAL SPECIFICATION SECTION "32 9300 PLANTING" FOR ADDITIONAL REQUIREMENTS.
2. TREES LESS THAN 4" CALIPER = (2) T-POSTS
TREES 4" CALIPER AND GREATER = (3) T-POSTS.

2 TREE PLANTING - MULTI TRUNK SECTION

NOT TO SCALE

POST AND TIES ARE TO BE ESTABLISHED WITHOUT HARMING THE TREE (E.G. NON-BINDING STRAPS, POSTS ESTABLISHED OUTSIDE OF ROOTBALL) BUT ENSURE THAT ALL STAKING MATERIAL IS REMOVED AFTER ONE YEAR.
SEE ANSI A300 (PART 1) FOR ADDITIONAL INFORMATION REGARDING PRUNING STANDARDS
SEE ANSI 260.1 FOR NURSERY STANDARDS

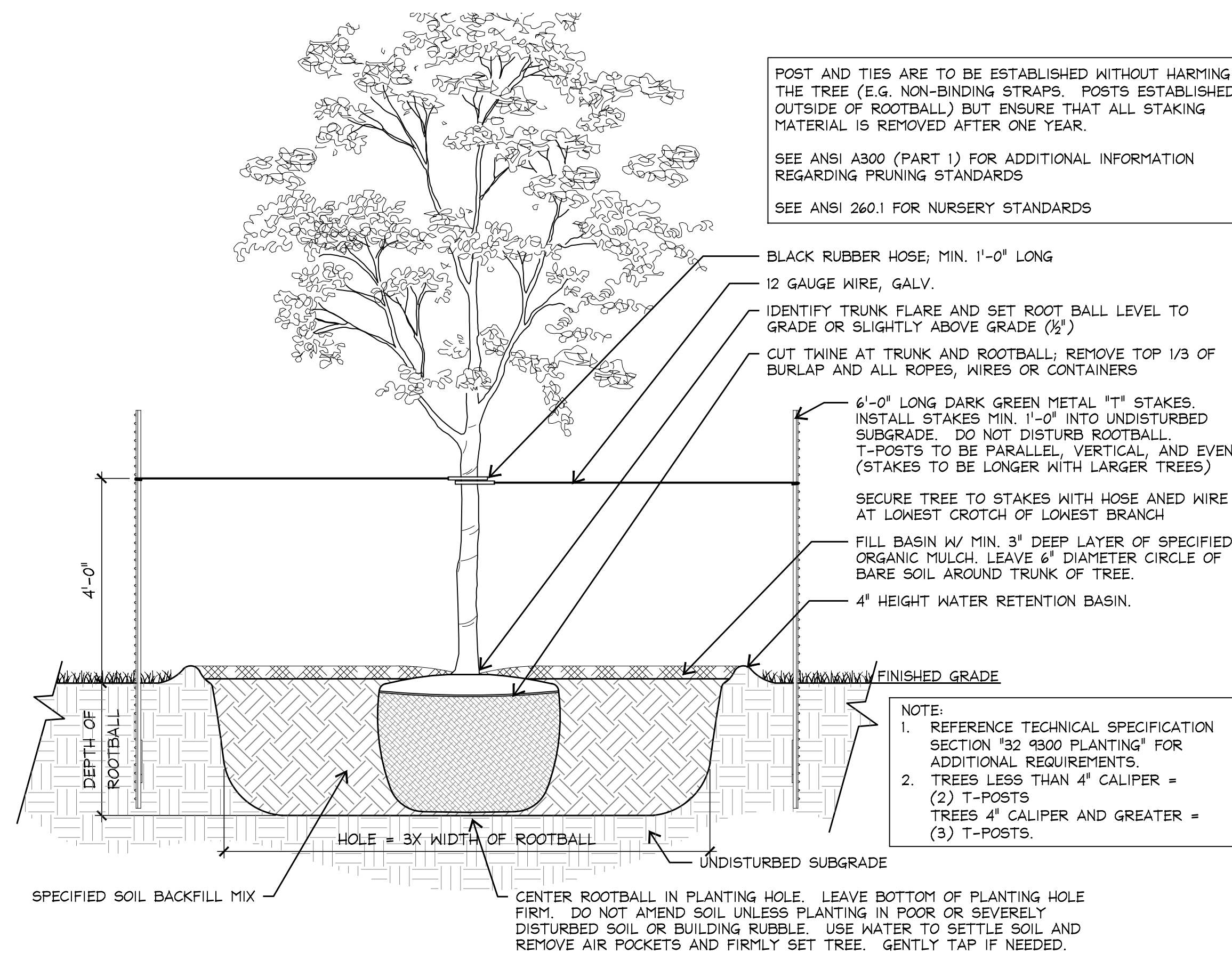

NOTE:
1. REFERENCE TECHNICAL SPECIFICATION SECTION "32 9300 PLANTING" FOR ADDITIONAL REQUIREMENTS.
2. TREES LESS THAN 4" CALIPER = (2) T-POSTS
TREES 4" CALIPER AND GREATER = (3) T-POSTS.

1 TREE PLANTING - STANDARD TRUNK SECTION

NOT TO SCALE

LANDSCAPE NOTES:

- ALL PROPOSED LANDSCAPE AREAS WITHIN PROPERTY LINE TO RECEIVE 100% HEAD TO HEAD IRRIGATION COVERAGE.
- AN UNDERGROUND AUTOMATIC IRRIGATION SYSTEM WILL BE USED TO IRRIGATE NEW LANDSCAPE MATERIAL WITH TURF ZONES SEPARATED FROM PLANTING ZONES. AUTOMATIC IRRIGATION SYSTEMS SHALL COMPLY WITH THE WATER CONSERVATION IRRIGATION SYSTEM REQUIREMENTS, AS REQUIRED IN THE ENVIRONMENTAL CRITERIA MANUAL.
- THE IRRIGATION SYSTEM SHALL BE IN PLACE AND FUNCTIONAL AT THE TIME OF THE LANDSCAPE INSPECTION.
- REFERENCE TREE STAKING DETAIL FOR ALL NEW TREES.
- A MINIMUM OF 6" OF PERMEABLE SOIL IS REQUIRED FOR TURF AND LANDSCAPE AREAS.
- IRRIGATION LINES SHOULD BE TRENCHED SO THAT THERE IS NO DISTURBANCE TO THE CRITICAL ROOT ZONE OF EXIST. TREES.
- PROOF OF PAYMENT OF THE LANDSCAPE INSPECTION FEE IN THE AMOUNT REQUIRED BY C.O.A. WILL BE REQUIRED PRIOR TO FINAL APPROVAL OF THIS SITE PLAN BY ECSD.
- IF ESTABLISHING VEGETATION DURING ANY STAGE OF A DROUGHT, SECTION 6-4-30 MAY REQUIRE A VARIANCE. CONTACT AUSTIN WATER CONSERVATION STAFF AT WATERUSECOMPVAR@AUSTINTEXAS.GOV OR CALL (512) 974-2199.
- THE OWNER WILL CONTINUOUSLY MAINTAIN THE REQUIRED LANDSCAPING IN ACCORDANCE WITH LDC 25-2-984.
- ALL LANDSCAPED AREAS ARE TO BE PROTECTED BY 6 INCH WHEEL CURBS, WHEELSTOPS, OR OTHER APPROVED BARRIERS AS PER ECM 2.4.7. (LDC 25-2-1004(A), ECM 2.4.7(A)).
- AN AREA EQUAL TO AT LEAST 50% OF THE TOTAL REQUIRED LANDSCAPE AREA ON A PROJECT MUST (E.C.M. 2.4.8(A), E.C.M. 2.4.9)
 - BE UNDISTURBED NATURAL AREA(S) OR UNDISTURBED EXISTING TREES WITH NO POTABLE IRRIGATION
 - BE IRRIGATED BY STORMWATER RUNOFF CONVEYED FROM IMPERVIOUS SURFACES ON THE SITE.

IRRIGATION NOTES:

- AUTOMATIC IRRIGATION SYSTEMS SHALL COMPLY WITH TCEQ CHAPTER 344, AS WELL AS THE FOLLOWING REQUIREMENTS:
- THESE REQUIREMENTS SHALL BE NOTED ON THE SITE DEVELOPMENT PERMIT AND SHALL BE IMPLEMENTED AS PART OF THE LANDSCAPE INSPECTION:
 - THE SYSTEM MUST PROVIDE A MOISTURE LEVEL ADEQUATE TO SUSTAIN GROWTH OF THE PLANT MATERIALS;
 - THE SYSTEM DOES NOT INCLUDE SPRAY IRRIGATION ON AREAS LESS THAN TEN (10) FEET WIDE (SUCH AS MEDIANS, BUFFER STRIPS, AND PARKING LOT ISLANDS);
 - CIRCUIT REMOTE CONTROL VALVES HAVE ADJUSTABLE FLOW CONTROLS;
 - SERVICEABLE IN-HEAD CHECK VALVES ARE ADJACENT TO PAVED AREAS WHERE ELEVATION DIFFERENCES MAY CAUSE LOW HEAD DRAINAGE;
 - A MASTER VALVE INSTALLED ON THE DISCHARGE SIDE OF THE BACKFLOW PREVENTER;
 - ABOVE-GROUND IRRIGATION EMISSION DEVICES ARE SET BACK AT LEAST SIX (6) INCHES FROM IMPERVIOUS SURFACES;
 - AN AUTOMATIC RAIN SHUT-OFF DEVICE SHUTS OFF THE IRRIGATION SYSTEM AUTOMATICALLY AFTER MORE THAN A ONE-HALF INCH (1/2") RAINFALL; AND
 - NEWLY PLANTED TREES SHALL HAVE PERMANENT IRRIGATION CONSISTING OF DRIP OR BUBBLERS.
 - THE IRRIGATION INSTALLER SHALL DEVELOP AND PROVIDE AN AS-BUILT DESIGN PLAN TO THE CITY AT THE TIME THE FINAL IRRIGATION INSPECTION IS PERFORMED:
 - UNLESS FISCAL SECURITY IS PROVIDED TO THE CITY FOR THE INSTALLATION OF THE SYSTEM, IT MUST BE OPERATIONAL AT THE TIME OF THE FINAL LANDSCAPE INSPECTION.
 - THE IRRIGATION INSTALLER SHALL ALSO PROVIDE EXHIBITS TO BE PERMANENTLY INSTALLED INSIDE OR ATTACHED TO THE IRRIGATION CONTROLLER, INCLUDING:
 - A LAMINATED COPY OF THE WATER BUDGET CONTAINING ZONE NUMBERS, PRECIPITATION RATES, AND GALLONS PER MINUTE, AND A ZONE MAP WITH THE ISOLATION VALVE LOCATION. (SEE APPENDIX 0 BELOW)
 - THE IRRIGATION INSTALLER SHALL PROVIDE A REPORT TO THE CITY ON A FORM PROVIDED BY AUSTIN WATER CERTIFYING COMPLIANCE WITH SUBSECTION 1 WHEN THE FINAL PLUMBING INSPECTION IS PERFORMED BY THE CITY.

IRRIGATION WATER BUDGET Appendix 0

Zone	Precipitation Rate in./hr.	Gallons per minute (required)	Establishment Schedule (first three months) min./week (optional)	Recommended Seasonal Schedules				Average Gallons/Month
				Winter min./week (optional)	Spring min./week (optional)	Summer min./week (optional)	Autumn min./week (optional)	
1								
2								
3								
4								
5								
6								
7								
8								
9								
10								
11								
12								
13								
14								
15								
16								
17								
18								
19								
20								
21								
22								

Location of emergency system shut-off valve:

FOR CITY USE ONLY:

NEW SHEET

SHEET ___ OF 50

SITE PLAN APPROVAL FILE NUMBER: SPC-02-0034C APPLICATION DATE: _____

APPROVED BY COMMISSION ON: 1-8-2003 UNDER SECTION 142 OF CHAPTER 255 OF THE CITY OF AUSTIN CODE.

EXPIRATION DATE (25-5-81 LDC) CASE MANAGER: _____

PROJECT EXPIRATION DATE (OED #970905-A) N/A DWP? _____ DOZ_Y _____

Director, Development Services Department
RELEASED FOR GENERAL COMPLIANCE: 10-13-03 ZONING: P-NP, CS-1-NP

Rev 1: _____ Correction 1: _____
Rev 2: _____ Correction 2: _____
Rev 3: _____ Correction 3: _____

Final plot must be recorded by the Project Expiration Date, if applicable. Subsequent Site Plans which do not comply with the Code current at the time of filing, and all required Building Permits and/or a notice of construction (if a building permit is not required), must also be approved prior to the Project Expiration Date.

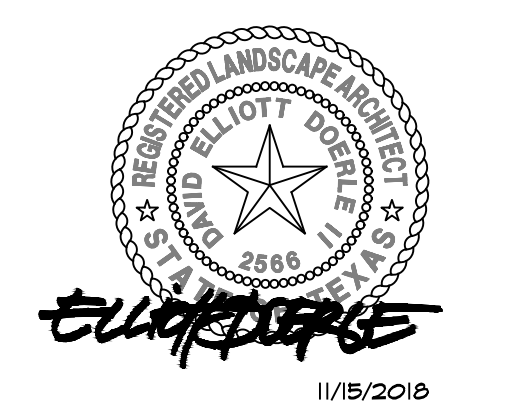

1705 Guadalupe Street, Suite 500
Austin, Texas 78701
(512) 327-1011 Fax: (512) 327-0488
Austin Dallas Fort Lauderdale
Fort Worth Houston San Antonio

Project:
TOWN LAKE PARK
CULTURAL LANDSCAPE
PHASE TWO

ALLIANCE
CHILDREN'S
GARDEN

1006 Barton Springs Rd.
AUSTIN, TEXAS

Project Number:
A13458



Designed: AS

Drawn: CC, BH, NB

Reviewed: MD, JL

Date Issued:
11/15/2018

Revisions:

Sheet Title:
PLANTING
DETAILS & NOTES

Sheet Number: 43 OF 65

L-12

SPC-02-0034C

#NLEB-TLP - Alliance Childrens Garden (A13458)02 Permit\Sheets\A13458-L-6.dwg