

1400 Winstead Ln.

Austin, TX

Inspected Address

City

Zip Code

SCOPE OF INSPECTION

A. This inspection covers only the multi-family structure, primary dwelling or place of business. Sheds, detached garages, lean-tos, fences, guest houses or any other structure will not be included in this inspection report unless specifically noted in Section 5 of this report.

B. This inspection is limited to those parts of the structure(s) that are visible and accessible at the time of the inspection. Examples of inaccessible areas include but are not limited to (1) areas concealed by wall coverings, furniture, equipment and stored articles and (2) any portion of the structure in which inspection would necessitate removing or defacing any part of the structure(s) (including the surface appearance of the structure). **Inspection does not cover any condition or damage which was not visible in or on the structure(s) at time of inspection but which may be revealed in the course of repair or replacement work.**

C. Due to the characteristics and behavior of various wood destroying insects, it may not always be possible to determine the presence of infestation without defacing or removing parts of the structure being inspected. Previous damage to trim, wall surface, etc., is frequently repaired prior to the inspection with putty, spackling, tape or other decorative devices. Damage that has been concealed or repaired may not be visible except by defacing the surface appearance. **The WDI inspecting company cannot guarantee or determine that work performed by a previous pest control company, as indicated by visual evidence of previous treatment; has rendered the pest(s) inactive.**

D. If visible evidence of active or previous infestation of listed wood destroying insects is reported, it should be assumed that some degree of damage is present.

E. If visible evidence is reported, it does not imply that damage should be repaired or replaced. Inspectors of the inspection company usually are not engineers or builders qualified to give an opinion regarding the degree of structural damage. Evaluation of damage and any corrective action should be performed by a qualified expert.

F. **THIS IS NOT A STRUCTURAL DAMAGE REPORT OR A WARRANTY AS TO THE ABSENCE OF WOOD DESTROYING INSECTS.**

G. If termite treatment (including pesticides, baits or other methods) has been recommended, the treating company must provide a diagram of the structure(s) inspected and proposed for treatment, label of pesticides to be used and complete details of warranty (if any). At a minimum, the warranty must specify which areas of the structure(s) are covered by warranty, renewal options and approval by a certified applicator in the termite category. Information regarding treatment and any warranties should be provided by the party contracting for such services to any prospective buyers of the property. The inspecting company has no duty to provide such information to any person other than the contracting party.

H. There are a variety of termite control options offered by pest control companies. These options will vary in cost, efficacy, areas treated, warranties, treatment techniques and renewal options.

I. There are some specific guidelines as to when it is appropriate for corrective treatment to be recommended. Corrective treatment may only be recommended if (1) there is visible evidence of an active infestation in or on the structure, (2) there is visible evidence of a previous infestation with no evidence of a prior treatment.

J. If treatment is recommended based solely on the presence of conducive conditions, a preventive treatment or correction of conducive conditions may be recommended. The buyer and seller should be aware that there may be a variety of different strategies to correct the conducive condition(s). These corrective measures can vary greatly in cost and effectiveness and may or may not require the services of a licensed pest control operator. There may be instances where the inspector will recommend correction of the conducive conditions by either mechanical alteration or cultural changes. Mechanical alteration may be in some instances the most economical method to correct conducive conditions. If this inspection report recommends any type of treatment and you have any questions about this, you may contact the inspector involved, another licensed pest control operator for a second opinion, and/or the Structural Pest Control Service of the Texas Department of Agriculture.

1A. Bill Durtschi, Inc

1B. TPCL 11615

Name of Inspection Company

SPCS Business License Number

1C. 6007 Cary Dr.

Austin

TX

78757

512-970-9301

Address of Inspection Company

City

State

Zip

Telephone No.

1D. Bill Durtschi

1.E

Certified Applicator Technician

☒

☐

(check one)

Name of Inspector (Please Print)

2. N/A

3. Feb. 20, 2019

Case Number (VA/FHA/Other)

Inspection Date

4A. Shailene Smith

Seller ☐ Agent ☐ Buyer ☒ Management Co. ☐ Other ☐

Name of Person Purchasing Inspection

4B. Unknown

Owner/Seller

4C.REPORT FORWARDED TO:

Title Company or Mortgagee ☐ Purchaser of Service ☐ Seller ☐ Agent ☐ Buyer ☒

(Under the Structural Pest Control regulations only the purchaser of the service is required to receive a copy)

The structure(s) listed below were inspected in accordance with the official inspection procedures adopted by the Texas Department of Agriculture Structural Pest Control Service. This report is made subject to the conditions listed under the Scope of Inspection. A diagram must be attached including all structures inspected.

5. House only

List structure(s) inspected that may include residence, detached garages and other structures on the property. (Refer to Part A, Scope of Inspection)

6A.Were any areas of the property obstructed or inaccessible?

Yes ☒

No ☐

(Refer to Part B & C, Scope of Inspection) If "Yes" specify in 6B.

6B.The obstructed or inaccessible areas include but are not limited to the following:

Attic ☒ Insulated area of attic ☒ Plumbing Areas ☒ Planter box abutting structure ☐

Deck ☐ Sub Floors ☐ Slab Joints ☐ Crawl Space ☒

Soil Grade Too High ☐ Heavy Foliage ☐ Eaves ☐ Weepholes ☐

Other ☒ Specify: Conditions and situtations exist that can conceal insect infestation.

7A.Conditions conducive to wood destroying insect infestation:

Yes ☒

No ☐

(Refer to Part J, Scope of Inspection) If "Yes" specify in 7B.

7B.Conducive Conditions include but are not limited to:

Wood to Ground Contact (G) ☐ Formboards left in place (I) ☐ Excessive Moisture (J) ☒

Debris under or around structure (K) ☐ Footing too low or soil line too high (L) ☒ Wood Rot (M) ☐ Heavy Foliage (N) ☒

Planter box abutting structure (O) ☐ Wood Pile in Contact with Structure (Q) ☐ Wooden Fence in Contact with the Structure (R) ☐

Insufficient ventilation (T) ☐ Other (C) ☒ Specify: Wall frame over slab joint

8.Inspection Reveals Visible Evidence in or on the structure:

Active Infestation

Previous Infestation

Previous Treatment

8A.Subterranean Termites

Yes ☐ No ☒

Yes ☒ No ☐

Yes ☒ No ☐

8B.Drywood Termites

Yes ☐ No ☒

Yes ☐ No ☒

Yes ☐ No ☒

8C.Formosan Termites

Yes ☐ No ☒

Yes ☐ No ☒

Yes ☐ No ☒

8D.Carpenter Ants

Yes ☐ No ☒

Yes ☐ No ☒

Yes ☐ No ☒

8E.Other Wood Destroying Insects

Yes ☐ No ☒

Yes ☐ No ☒

Yes ☐ No ☒

Specify:

8F.Explanation of signs of previous treatment (including pesticides, baits, existing treatment stickers or other methods) identified:

Kitchen sticker from Research Pest Control, TPCL No. 3939, treated subterranean termite on 5-13-02 with Termador Sc

8G.Visible evidence of: Termite damage has been observed in the following areas: Garage stairwell steps

If there is visible evidence of active or previous infestation, it must be noted. The type of insect(s) must be listed in the first blank and all identified infested areas of the property inspected must be noted in the second blank. (Refer to Part D, E & F, Scope of Inspection)

TEXAS OFFICIAL WOOD DESTROYING INSECT REPORT

Page 2 of 2

The conditions conducive to insect infestation reported in 7A & 7B:
 9. Will be or has been mechanically corrected by inspecting company:
 If "Yes," specify corrections:

Yes ☐ No ☒

9A. Corrective treatment recommended for active infestation or evidence of previous infestation with no prior treatment as identified in Section 8. (Refer to Part G, H, and I, Scope of Inspection)
 9B. A preventive treatment and/or correction of conducive conditions as identified in 7A & 7B is recommended as follows:
 Specify reason:
 Refer to Scope of Inspection Part J

Yes ☐ No ☒
 Yes ☒ No ☐

10A. This company has treated or is treating the structure for the following wood destroying insects: (This company has not treated this house for any insect.)
 If treating for subterranean termites, the treatment was: Partial ☐ Spot ☐ Bait ☐ Other ☐
 If treating for drywood termites or related insects, the treatment was: Full ☐ Limited ☐

10B. Date of Treatment by Inspecting Company _____ Common Name of Insect _____ Name of Pesticide, Bait or Other Method _____
 This company has a contract or warranty in effect for control of the following wood destroying insects:
 Yes ☐ No ☒ List Insects: _____
 If "Yes", copy(ies) of warranty and treatment diagram must be attached.

Diagram of Structure(s) Inspected

The inspector must draw a diagram including approximate perimeter measurements and indicate active or previous infestation and type of insect by using the following codes: E-Evidence of Infestation, A-Active; P-Previous; D-Drywood Termites; S-Subterranean Termites; F-Formosan Termites; C-Conducive Conditions; B-Wood Boring Beetles; H-Carpenter Ants; Other(s) - Specify

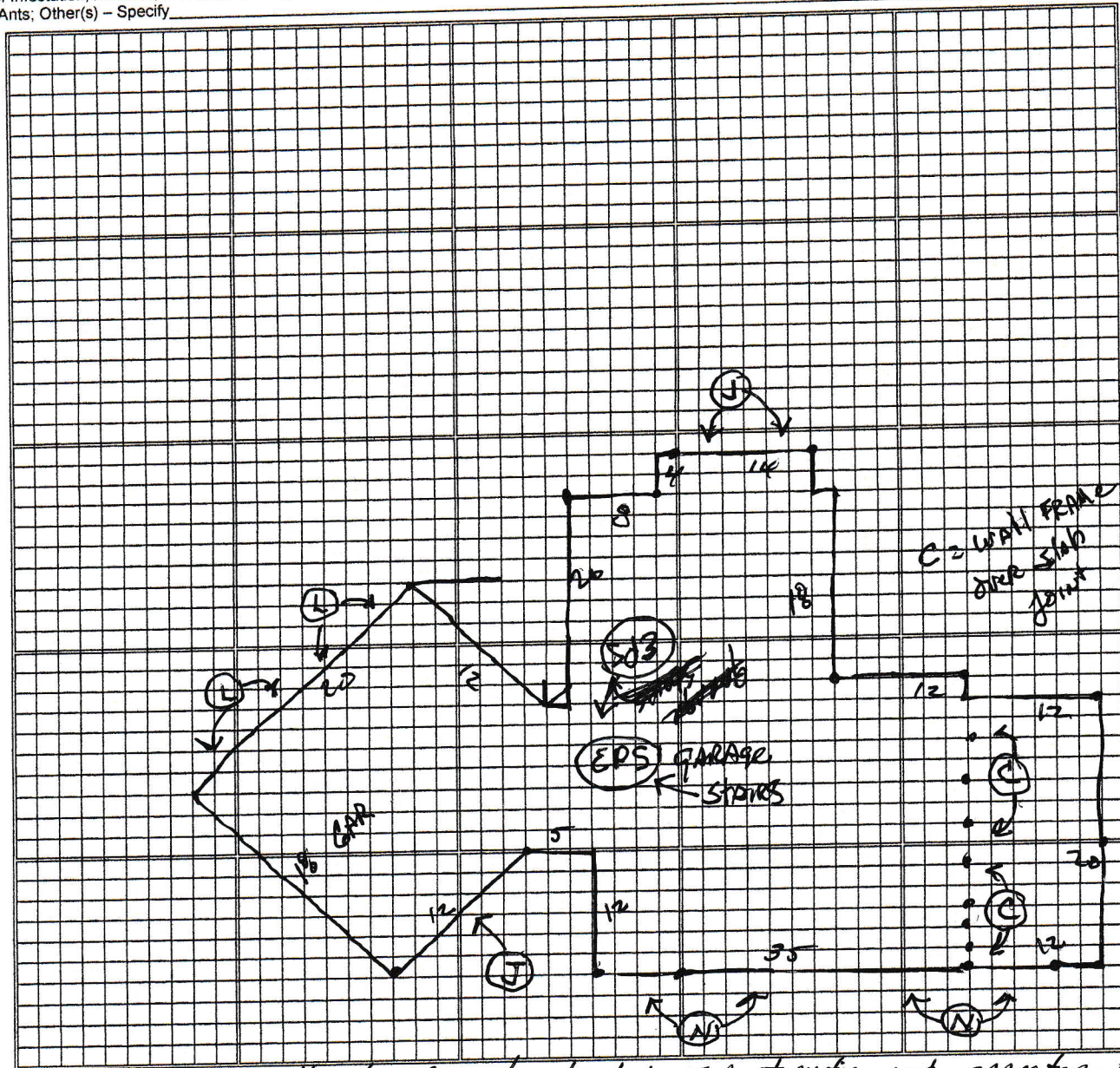

Additional Comments: Recommend the building be treated for termites and carpenter ants

Neither I nor the company for which I am acting have had, presently have, or contemplate having any interest in the property. I do further state that neither I nor the company for which I am acting is associated in any way with any party to this transaction.

Signatures: Brian Huntch
 11A. Inspector

Inspected Address 1400 Winstead Ln.
 Notice of Inspection Was Posted At or Near Austin, TX
 12A. Electric Breaker Box ☐
 Water Heater Closet ☐
 Bath Trap Access ☐
 Beneath the Kitchen Sink ☒
 Date Posted Feb. 20, 2019
 Date

Approved: Brian Huntch
 11B. Certified Applicator and Certified Applicator License Number

Statement of Purchaser

I have received the original or a legible copy of this form. I have read and understand any recommendations made. I have also read and understand the "Scope of Inspection." I understand that my inspector may provide additional information as an addendum to this report.
 If additional information is attached, list number of pages: _____

Signature of Purchaser of Property or their Designee _____

Date _____

SPCS/T-4 (Rev. 09/01/07)

ABBREVIATED LETTERS DESIGNATIONS FOR CONDUCTIVE CONDITIONS:
 G = WOOD TO GROUND I = FORMBOARDS LEFT IN PLACE J = EXCESSIVE MOISTURE
 M = WOOD ROT N = HEAVY FOLIAGE K = DEBRIS UNDER OR AROUND THE STRUCTURE
 T = INSUFFICIENT VENTILATION Q = WOOD PILE IN CONTACT WITH STRUCTURE
 O = PLANTER BOX ABUTTING STRUCTURE L = FOOTING TOO LOW OR SOIL LINE TOO HIGH
 C = OTHER R = WOODEN FENCE IN CONTACT WITH STRUCTURE