

SUBDIVISION REVIEW SHEET

CASE NO.: C8J-2016-0112.3A**Z.A.P. DATE:** 4/16/19**SUBDIVISION NAME:** Stoney Ridge C-3A (W/R C8J-2016-0112.2A)**AREA:** 2.64**LOT(S):** 37**OWNER/APPLICANT:** Lennar Homes of Texas Land and Construction, LTD (Richard N Mair)**AGENT:** Carlson, Brigrance, and Doering, Inc. (Bill E. Couch)**DISTRICT NUMBER:** 2**ADDRESS OF SUBDIVISION:** 7110 HEINE FARM ROAD**GRIDS:** MP13**COUNTY:** Travis**WATERSHED:** Dry Creek East**JURISDICTION:** Limited Purpose**EXISTING ZONING:** Vacant**NEIGHBORHOOD PLAN:** N/A**PROPOSED LAND USE:** Single Family, Public, ROW**ADMINISTRATIVE WAIVERS:** None**VARIANCES:** None**SIDEWALKS:** Sidewalks will be provided on both sides of all internal streets and the subdivision side of boundary streets.**DEPARTMENT COMMENTS:** The request is for approval of the Stoney Ridge C-3A. The proposed plat is composed of 37 lots on 2.64 acres.**STAFF RECOMMENDATION:** The staff recommends disapproval of the plat. This plat does not meet all applicable State and City of Austin LDC requirements.**ZONING AND PLATTING ACTION:** Statutory Disapproval

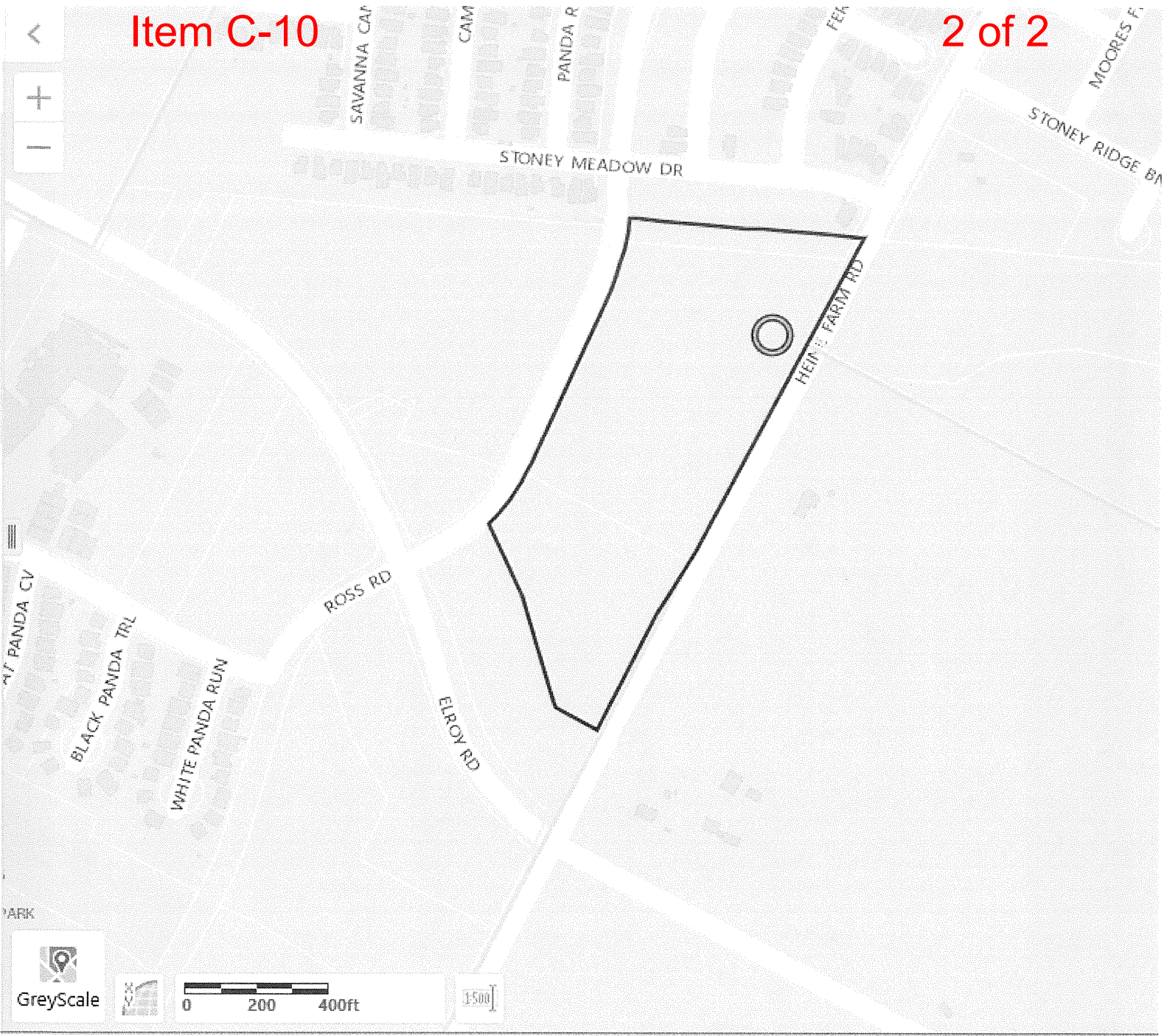

ZAP 12163669