

**SUBDIVISION REVIEW SHEET**

**CASE NO.:** C8-2019-0052.0A

**PC DATE:** April 23, 2019

**SUBDIVISION NAME:** Park Forest Section 6, Resubdivision of lot 18, Block A

**AREA:** 0.3

**LOT(S):** 2

**OWNER/APPLICANT:** Austin APG Properties (Glenn Gibson)

**AGENT:** Perales Engineering (Jerry Perales, P.E.)

**ADDRESS OF SUBDIVISION:** 4703 Clawson Rd.

**DISTRICT NUMBER:** 5

**GRIDS:** MG18

**COUNTY:** Travis

**WATERSHED:** Williamson Creek

**JURISDICTION:** Full-Purpose

**EXISTING ZONING:** Single Family

**MUD:** N/A

**NEIGHBORHOOD PLAN:** South Manchaca

**PROPOSED LAND USE:** Single Family

**ADMINISTRATIVE WAIVERS:**

**VARIANCES:** None

**SIDEWALKS:** Sidewalks will be provided on both sides of all internal streets and the subdivision side of boundary streets.

**DEPARTMENT COMMENTS:** The request is for approval of the Park Forest Section 6, Resubdivision of lot 18, Block A. The proposed plat is composed of 2 lots on 0.3 acres.

**STAFF RECOMMENDATION:** The staff recommends disapproval of the plat. This plat does not meet all applicable State and City of Austin LDC requirements.

**PLANNING COMMISSION / ZONING AND PLATTING ACTION:**



# AMANDA GIS

Getting Around

Search & Identify Data

AMANDA

ROWPACT

Tool Labels



Drawing and Measurement

Printing and Reporting

Help



Address Search



Find Review Cases



Parcel Search



Permits By Address



Change visible map layers



4607 SOUTH FOREST DR?

Point

Query



Filter

4605 CLAWSON RD

4608 CLAWSON RD

4607 CLAWSON RD

PARKDALE PL

4601 PARKDALE PL

4603 PARKDALE PL

4701 SOUTH FOREST DR

4700 CLAWSON RD

4701 CLAWSON RD

4605 PARKDALE PL

4703 SOUTH FOREST DR

4606 GILLIS S

4702 CLAWSON RD

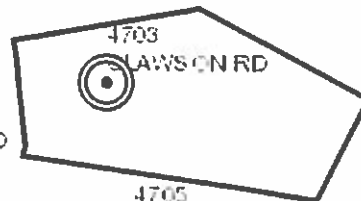

4703 CLAWSON RD

4607 GILLIS S

4706 SOUTH FOREST DR

4704 CLAWSON RD

4614 GILLIS S

4707 SOUTH FOREST DR

4706 CLAWSON RD

4705 CLAWSON RD

4611 GILLIS S

4709 SOUTH FOREST DR

4707 CLAWSON RD

1404 BIRCHWOOD CT

1402 BIRCHWOOD CT

4708 CLAWSON RD

4612 GILLIS S

4711 SOUTH FOREST DR

4709 CLAWSON RD

1407 BIRCHWOOD CT

SOUTH FOREST DR

4713 SOUTH FOREST DR

4711 CLAWSON RD

BIRCHWOOD CT



GreyScale

