

**ORDINANCE NO. \_\_\_\_\_**

**AN ORDINANCE REZONING AND CHANGING THE ZONING MAP FOR THE PROPERTY LOCATED AT 1301 WEST OLTORF STREET FROM GENERAL COMMERCIAL SERVICES (CS) DISTRICT TO MOBILE HOME RESIDENCE (MH) DISTRICT.**

**BE IT ORDAINED BY THE CITY COUNCIL OF THE CITY OF AUSTIN:**

**PART 1.** The zoning map established by Section 25-2-191 of the City Code is amended to change the base district from general commercial services (CS) district to mobile home residence (MH) district on the property described in Zoning Case No. C14-2019-0024, on file at the Planning and Zoning Department, as follows:

Tract 1, Oltorf Addition, a subdivision in Travis County, Texas, according to the map or plat of record in Volume 10, Page 12, of the Plat Records of Travis County, Texas (the “Property”),

locally known as 1301 West Oltorf Street in the City of Austin, Travis County, Texas, generally identified in the map attached as **Exhibit “A”**.

**PART 2.** This ordinance takes effect on \_\_\_\_\_, 2019.

# PASSED AND APPROVED

§§§

, 2019



Steve Adler  
Mayor

**APPROVED:** \_\_\_\_\_ **ATTEST:** \_\_\_\_\_

Anne L. Morgan  
City Attorney

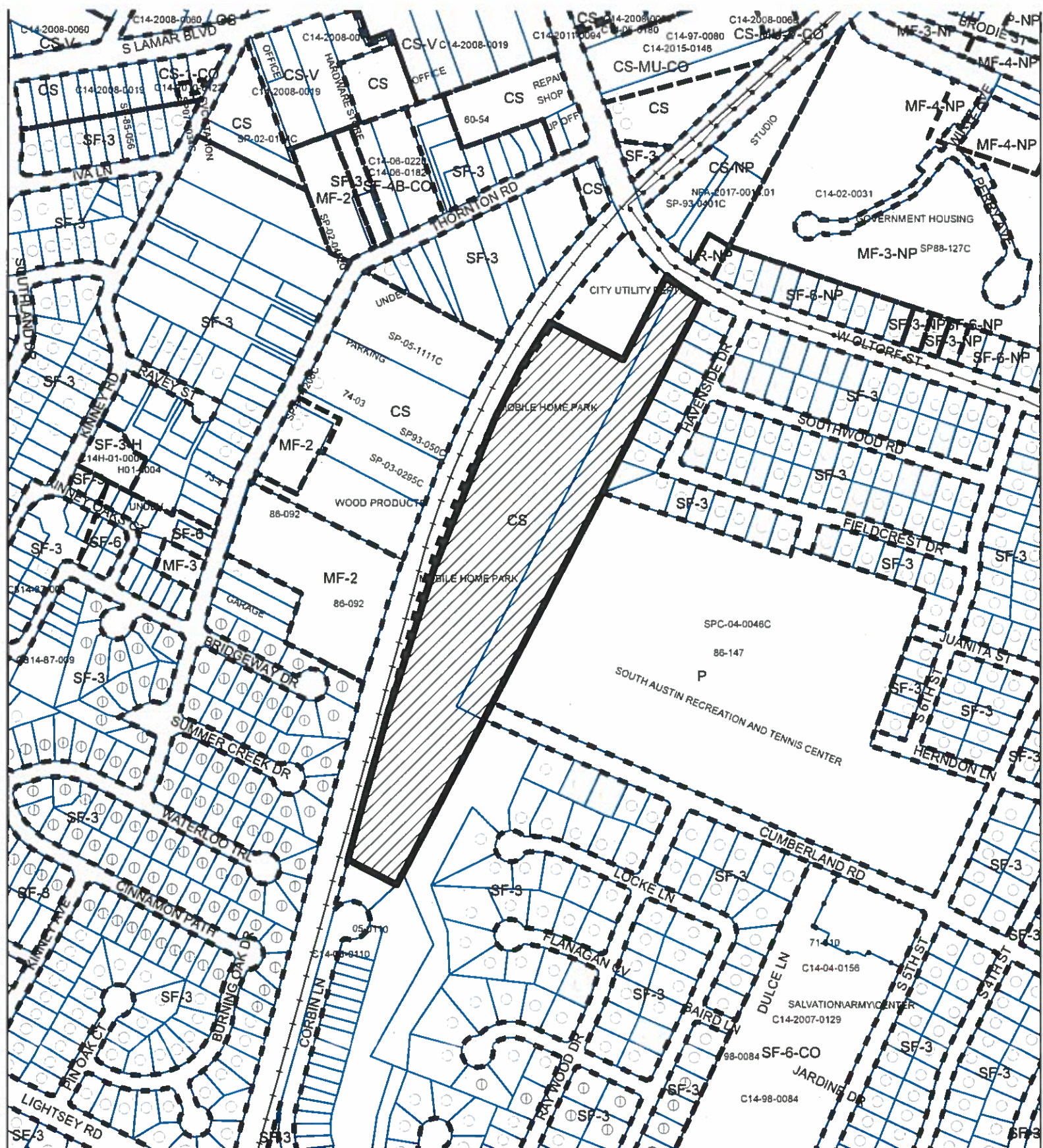
Jannette S. Goodall  
City Clerk



-  SUBJECT TRACT
-  PENDING CASE
-  ZONING BOUNDARY

## ZONING EXHIBIT "A"

ZONING CASE#: C14-2019-0024

1" = 400'

This product is for informational purposes and may not have been prepared for or be suitable for legal, engineering, or surveying purposes. It does not represent an on-the-ground survey and represents only the approximate relative location of property boundaries.

This product has been produced by CTM for the sole purpose of geographic reference. No warranty is made by the City of Austin regarding specific accuracy or completeness.



Created: 1/28/2019