

ORDINANCE NO. \_\_\_\_\_

AN ORDINANCE AMENDING ORDINANCE NO. 20120426-100 WHICH ADOPTED THE ST. JOHN/CORONADO HILLS COMBINED NEIGHBORHOOD PLAN AS AN ELEMENT OF THE IMAGINE AUSTIN COMPREHENSIVE PLAN, TO CHANGE THE LAND USE DESIGNATION ON THE FUTURE LAND USE MAP FOR PROPERTY LOCATED AT 7100 EAST US HIGHWAY 290 SERVICE ROAD WESTBOUND.

BE IT ORDAINED BY THE CITY COUNCIL OF THE CITY OF AUSTIN:

**PART 1.** Ordinance No. 20120426-100 adopted the St. John/Coronado Hills Combined Neighborhood Plan as an element of the Imagine Austin Comprehensive Plan.

**PART 2.** Ordinance No. 20120426-100 is amended to change the land use designation from mixed use to higher density single family use for the property located at 7100 East US Highway 290 Service Road Westbound on the future land use map attached as **Exhibit "A"** and incorporated in this ordinance, and described in File NPA-2019-0029.01 at the Planning and Zoning Department.

**PART 3.** This ordinance takes effect on \_\_\_\_\_, 2019.

PASSED AND APPROVED

\_\_\_\_\_, 2019      § \_\_\_\_\_  
§ \_\_\_\_\_  
§ \_\_\_\_\_

Steve Adler  
Mayor

**APPROVED:** \_\_\_\_\_ **ATTEST:** \_\_\_\_\_  
Anne L. Morgan      Jannette S. Goodall  
City Attorney      City Clerk

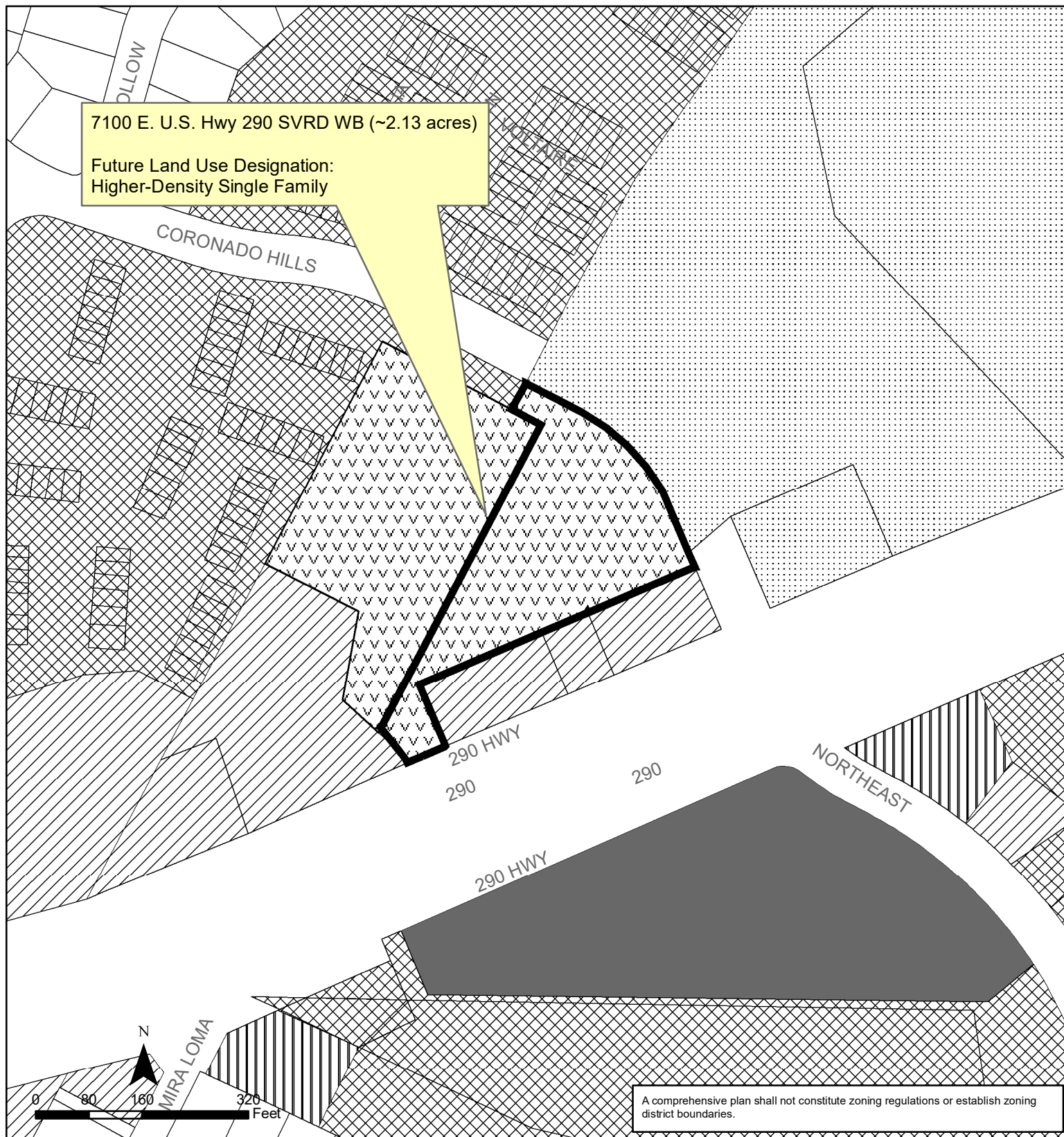

## Exhibit A

### St. John/Coronado Hills Combined Neighborhood Planning Area

#### NPA-2019-0029.01

This product is for informational purposes and may not have been prepared for or be suitable for legal, engineering, or surveying purposes. It does not represent an on-the-ground survey and represents only the approximate relative location of property boundaries.

This product has been produced by the Planning and Zoning Department for the sole purpose of geographic reference. No warranty is made by the City of Austin regarding specific accuracy or completeness.

#### Future Land Use

|  |                              |  |                  |
|--|------------------------------|--|------------------|
|  | Civic                        |  | Multi-Family     |
|  | Commercial                   |  | Office           |
|  | Higher-Density Single-Family |  | Single-Family    |
|  | Mixed Use                    |  | Subject Property |

