

ORDINANCE NO. _____

AN ORDINANCE REZONING AND CHANGING THE ZONING MAP FOR THE PROPERTY LOCATED AT 7307, 7311, 7401 AND 7403 EAST RIVERSIDE DRIVE IN THE MONTOPOLIS NEIGHBORHOOD PLAN AREA FROM EAST RIVERSIDE CORRIDOR (ERC) DISTRICT TO MOBILE HOME RESIDENCE (MH) DISTRICT.

BE IT ORDAINED BY THE CITY COUNCIL OF THE CITY OF AUSTIN:

PART 1. The zoning map established by Section 25-2-191 of the City Code is amended to change the base district from East Riverside Corridor (ERC) district to mobile home residence (MH) district on the property described in Zoning Case No. C14-2019-0007, on file at the Planning and Zoning Department, as follows:

9.15 acres out of Santiago Del Valle Grant, Abstract No. 24, Travis County, Texas, and

Lots 1A and 2A, Resubdivision of Baty Subdivision, a subdivision in Travis County, Texas according to the map or plat of record in Volume 54, Page 59, Plat Records of Travis County, Texas (the "Property"),

locally known as 7307, 7311, 7401 and 7403 East Riverside Drive in the City of Austin, Travis County, Texas, generally identified in the map attached as **Exhibit "A"**.

PART 2. The Property is subject to Ordinance No. 20130509-044 that established zoning for the Montopolis Neighborhood Plan.

PART 3. This ordinance takes effect on _____, 2019.

PASSED AND APPROVED

_____, 2019 § _____
 § _____
 § _____
Steve Adler
Mayor

APPROVED: _____ **ATTEST:** _____
Anne L. Morgan Jannette S. Goodall
City Attorney City Clerk

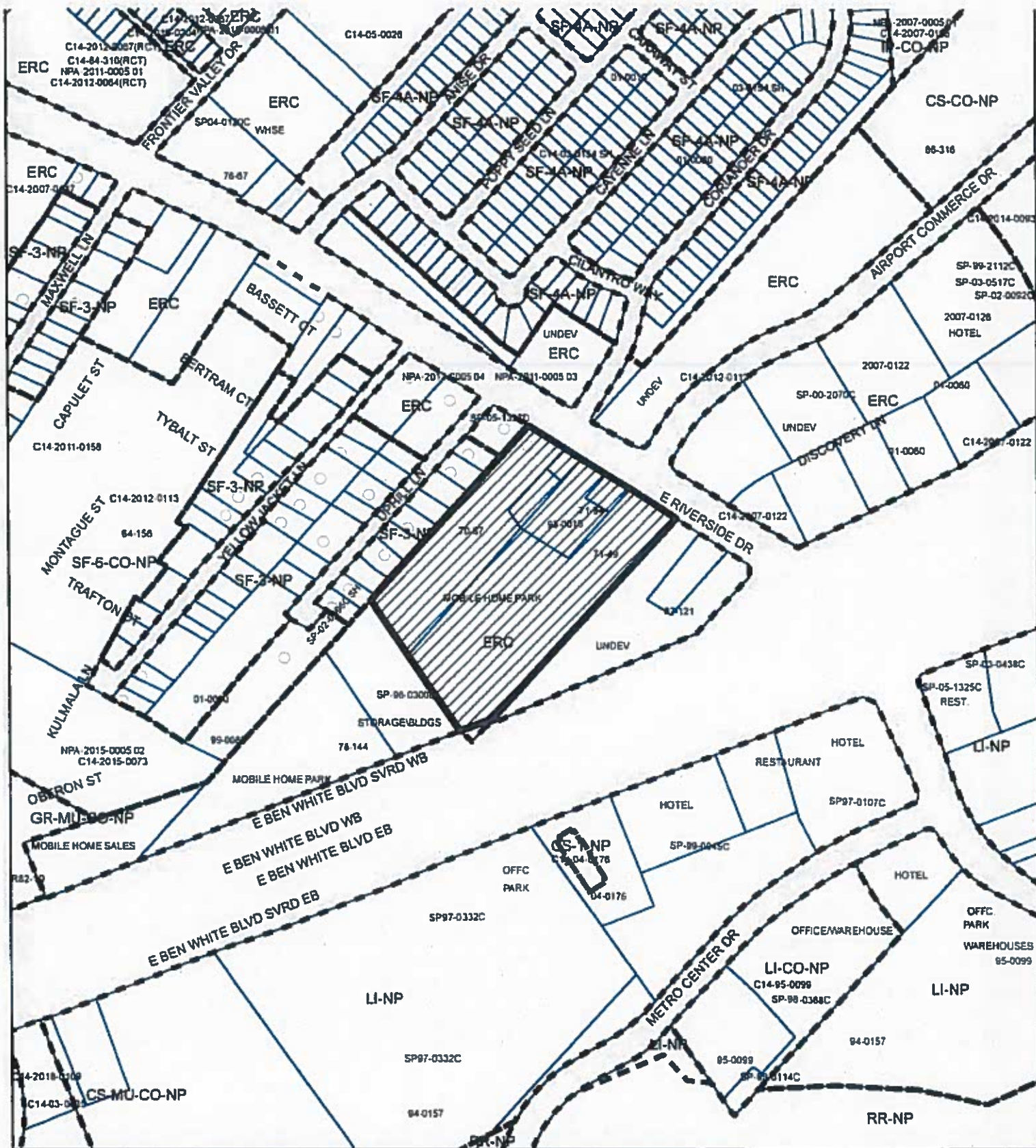

ZONING

ZONING CASE#: C14-2019-0007

EXHIBIT "A"



This product is for informational purposes and may not have been prepared for or be suitable for legal, engineering or surveying purposes. It does not represent an on-the-ground survey and represents only the approximate relative location of property boundaries.

This product has been produced by CTM for the sole purpose of geographic reference. No warranty is made by the City of Austin regarding specific accuracy or completeness.



Created: 5/21/2019



-  SUBJECT TRACT
-  PENDING CASE
-  ZONING BOUNDARY

1" = 400'