

**SUBDIVISION REVIEW SHEET****CASE NO.:** C8-2019-0092.0A**PC DATE:** June 25, 2019**SUBDIVISION NAME:** DCMC Dell Pace Project -MOB**AREA:** 29.55**LOT(S):** 4**OWNER/APPLICANT:** Seton Family of Hospitals**AGENT:** Stantec Consulting Services Inc (Daulton Wendel)**ADDRESS OF SUBDIVISION:** 4900 Mueller Blvd**GRIDS:** L25**COUNTY:** Travis**WATERSHED:** Boggy Creek**JURISDICTION:** Full-Purpose**EXISTING ZONING:** PUD**MUD:** N/A**NEIGHBORHOOD PLAN:** RMMA**PROPOSED LAND USE:** PUD**ADMINISTRATIVE WAIVERS:****VARIANCES:** None**SIDEWALKS:** Sidewalks will be provided on both sides of all internal streets and the subdivision side of boundary streets.**DEPARTMENT COMMENTS:** The request is for approval of the DCMC Dell Pace Project - MOB Final Plat. The proposed plat is composed of 4 lots on 29.55 acres.**STAFF RECOMMENDATION:** Staff recommends disapproval of the plat. This plat does not meet all applicable State and City of Austin LDC requirements.**PLANNING COMMISSION / ZONING AND PLATTING ACTION:**

Legend

Jurisdiction

- FULL PURPOSE
- LIMITED PURPOSE
- EXTRATERRITORIAL JURISDICTION
- 2 MILE ETJ AGRICULTURAL AGRICULTURE
- OTHER CITY LIMITS
- OTHER CITIES ETJ

Notes

Property Profile

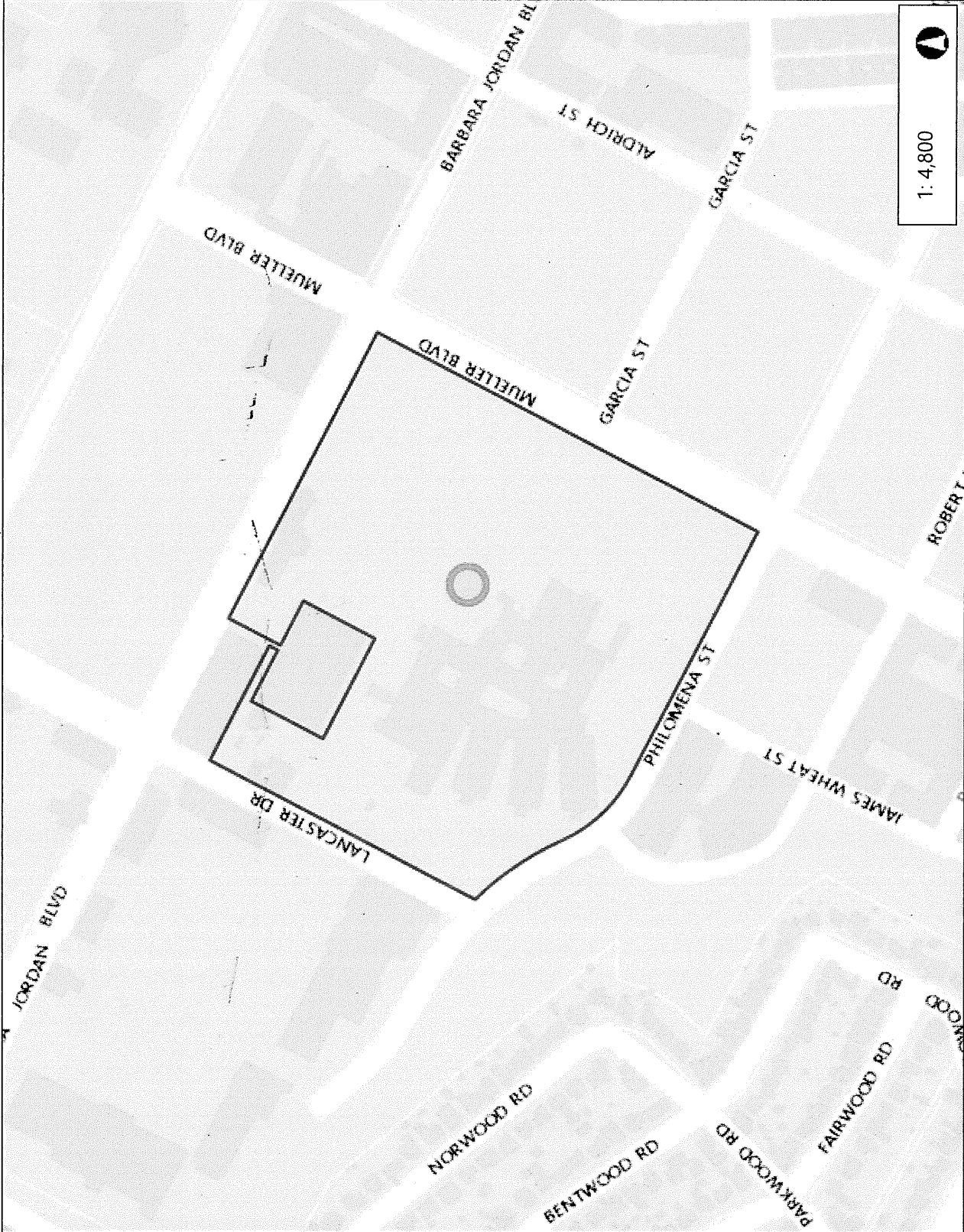

1:4,800

0.2 Miles

0.08

0

0.2

This product is for informational purposes and may not be suitable for legal, engineering, or surveying purposes. It does not represent an on-the-ground survey. This product has been produced by the City of Austin for the sole purpose of geographic reference. No warranty is made by the City of Austin regarding specific accuracy or completeness.

NAD\_1983\_StatePlane\_Texas\_Central\_FIPS\_4203\_Feet

Date Printed: