

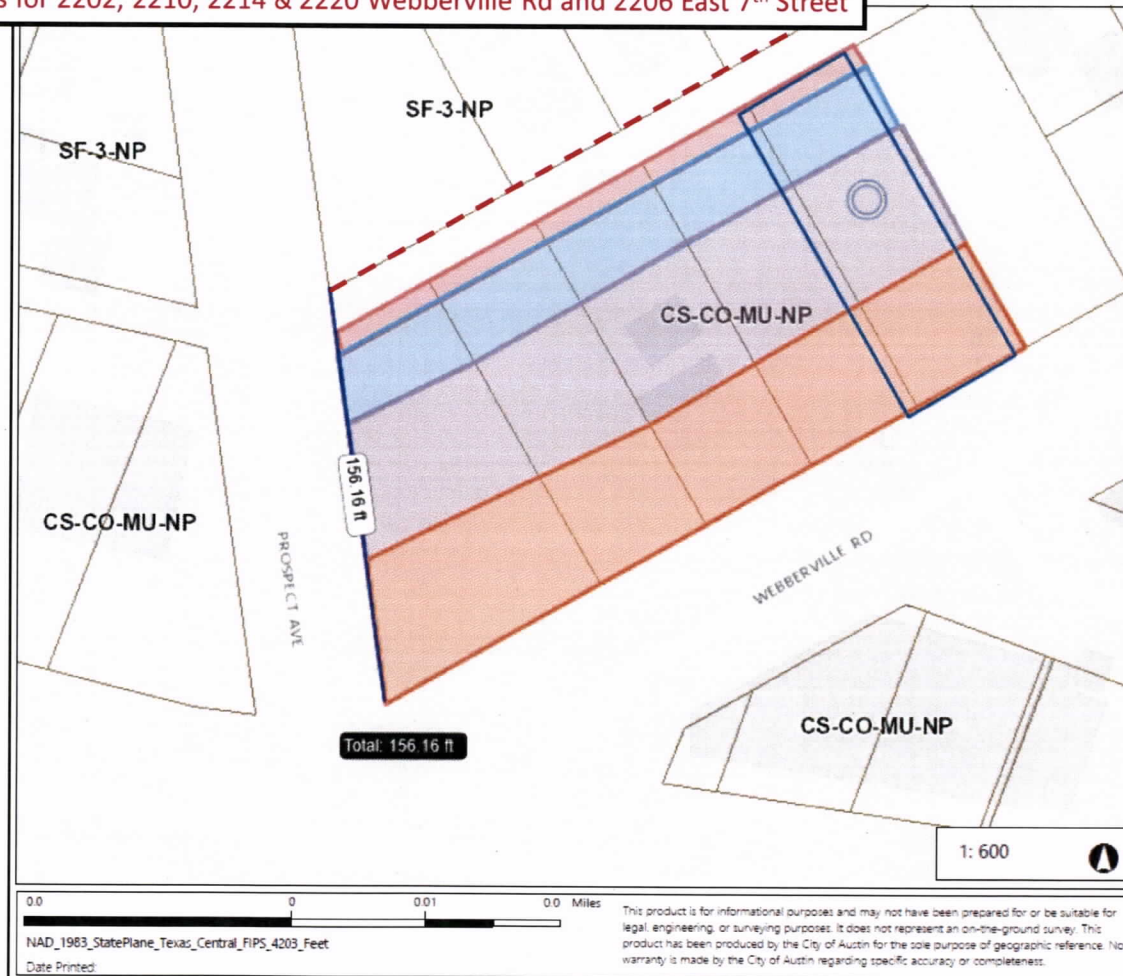





Late Backup

Compatibility Standards Illustration:

Height and Setbacks for 2202, 2210, 2214 & 2220 Webberville Rd and 2206 East 7th Street

Prepared by Council Member Flannigan's Office
Item 158 - C14-2019-0074 -2202 Webberville Rd



-  No Structure allowed
0 ft. to 25 ft. from SF-2 and SF-3
-  30ft or 2 stories allowed
25 ft. to 50 ft. from SF-2 and SF-3
-  40ft or 3 stories allowed
50 ft. to 100 ft. from SF-2 and SF-3
-  40ft to 50ft stories allowed
(40 ft. + 1 ft. in height for 10 ft. of setback)
100 ft. to 200 ft. from SF-2 and SF-3
-  Triggering Property Lines

Notes

Based on Regulations in § 25-2-1063 - HEIGHT LIMITATIONS AND SETBACKS FOR LARGE SITES.