

ORDINANCE NO. 20190620-155

AN ORDINANCE REZONING AND CHANGING THE ZONING MAP FOR THE PROPERTY LOCATED AT 3001 SCOFIELD RIDGE PARKWAY FROM COMMUNITY COMMERCIAL-MIXED USE-CONDITIONAL OVERLAY (GR-MU-CO) COMBINING DISTRICT TO COMMUNITY COMMERCIAL-MIXED USE (GR-MU) COMBINING DISTRICT.

BE IT ORDAINED BY THE CITY COUNCIL OF THE CITY OF AUSTIN:

PART 1. The zoning map established by Section 25-2-191 of the City Code is amended to change the base district from community commercial-mixed use-conditional overlay (GR-MU-CO) combining district to community commercial-mixed use (GR-MU) combining district on the property described in Zoning Case No. C14-2019-0058, on file at the Planning and Zoning Department, as follows:

Lot 1 of the Amended Plats of Lots 1 through 7, Block A, Terraces at Scofield Ridge, a subdivision in Travis County, Texas, according to the map or plat of record in Document No. 201700111, Plat Records of Travis County, Texas (the "Property"),

locally known as 3001 Scofield Ridge Parkway in the City of Austin, Travis County, Texas, generally identified in the map attached as **Exhibit "A"**.

PART 2. This ordinance takes effect on July 1, 2019.

PASSED AND APPROVED

_____, June 20 _____, 2019

§
§
§

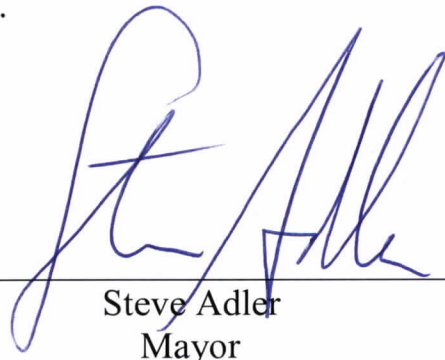

Steve Adler
Mayor

APPROVED:



Anne L. Morgan
City Attorney

ATTEST:

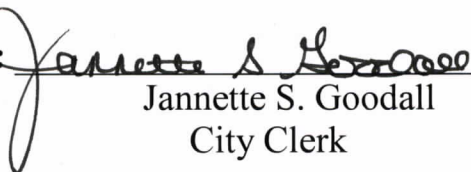

Jannette S. Goodall
City Clerk

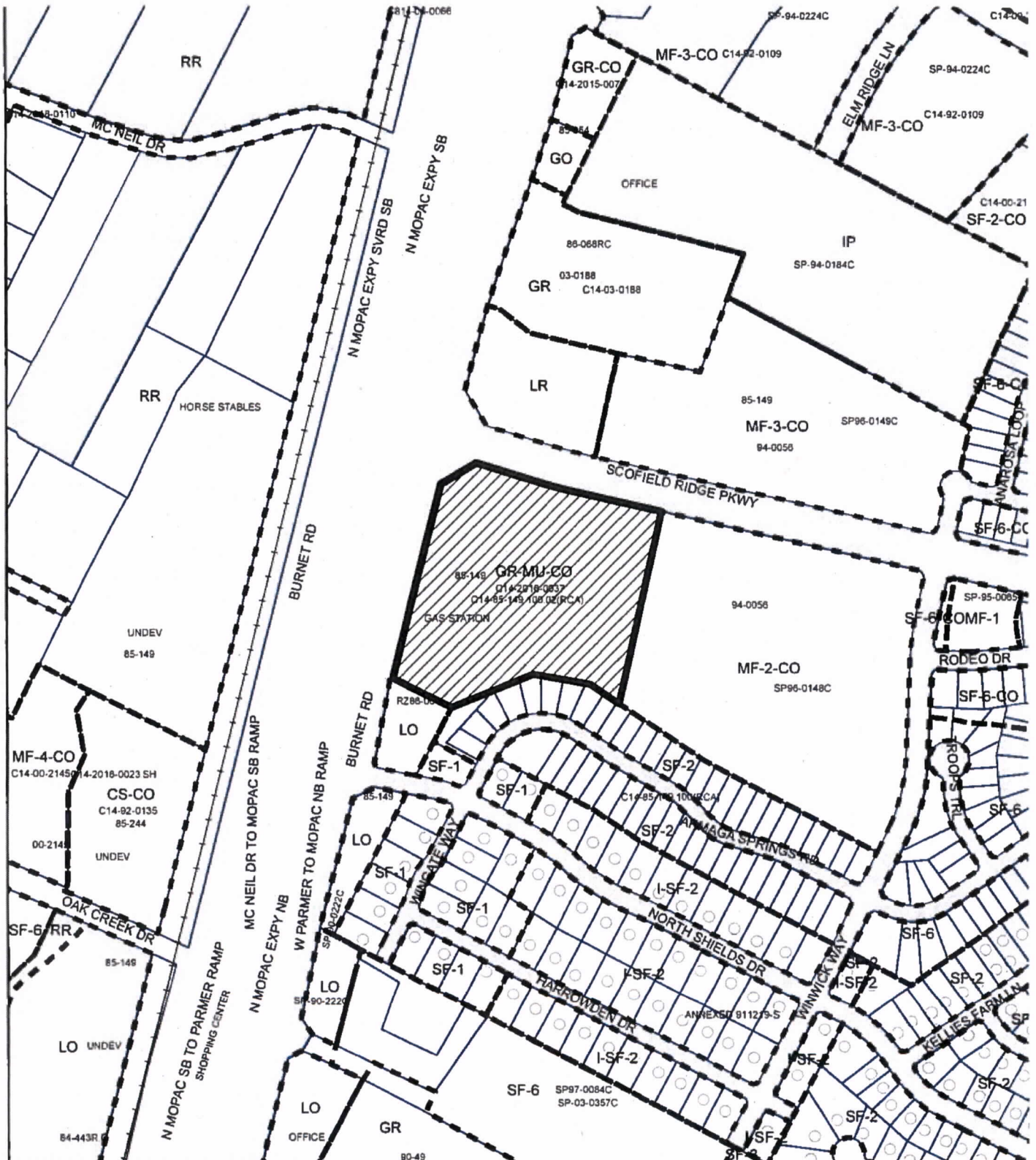

- SUBJECT TRACT
- PENDING CASE
- ZONING BOUNDARY

1" = 400'

ZONING
ZONING CASE#: C14-2019-0058

EXHIBIT "A"

This product is for informational purposes and may not have been prepared for or be suitable for legal, engineering, or surveying purposes. It does not represent an on-the-ground survey and represents only the approximate relative location of property boundaries.

This product has been produced by CTM for the sole purpose of geographic reference. No warranty is made by the City of Austin regarding specific accuracy or completeness.



Created: 3/18/2019