

SITE PLAN

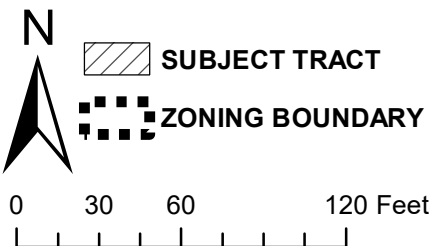

CASE#: SPC-2018-0478A
ADDRESS: 1300 E 4th Street, Bldg C
CASE NAME: Plaza Saltillo Block E Texaco
MANAGER: Anaiah Johnson

This product is for informational purposes and may not have been prepared for or be suitable for legal, engineering, or surveying purposes. It does not represent an on-the-ground survey and represents only the approximate relative location of property boundaries.

This product has been produced by the Planning and Development Review Department for the sole purpose of geographic reference. No warranty is made by the City of Austin regarding specific accuracy or completeness.



OPERATOR: Christine Barton-Holmes