

SUBDIVISION REVIEW SHEET**CASE NO.:** C8-2015-0042**PC DATE:** August 27, 2019**SUBDIVISION NAME:** St. Andrew's School Miller Tract**AREA:** 24.77**LOT(S):** 5**OWNER/APPLICANT:** ST ANDREWS EPISCOPL SCHOOL (Miller Tract)**AGENT:** LJA (Michael porvaznik)**ADDRESS OF SUBDIVISION:** 5613 Patton Ranch Road**GRIDS:** C20**COUNTY:** Travis**WATERSHED:** Barton Creek**JURISDICTION:** Full-Purpose**EXISTING ZONING:** MF-1-NP, P-NP**MUD:** N/A**NEIGHBORHOOD PLAN:** East Oak Hill**PROPOSED LAND USE:** Commercial**ADMINISTRATIVE WAIVERS:****VARIANCES:** None**SIDEWALKS:** Sidewalks will be provided on both sides of all internal streets and the subdivision side of boundary streets.**DEPARTMENT COMMENTS:** The request is for approval of the St. Andrew's School Miller Tract Final Plat. The proposed plat is composed of 5 lots on 24.77 acres.**STAFF RECOMMENDATION:** Staff recommends disapproval of the plat. This plat does not meet all applicable State and City of Austin LDC requirements.**PLANNING COMMISSION / ZONING AND PLATTING ACTION:**

Property Profile

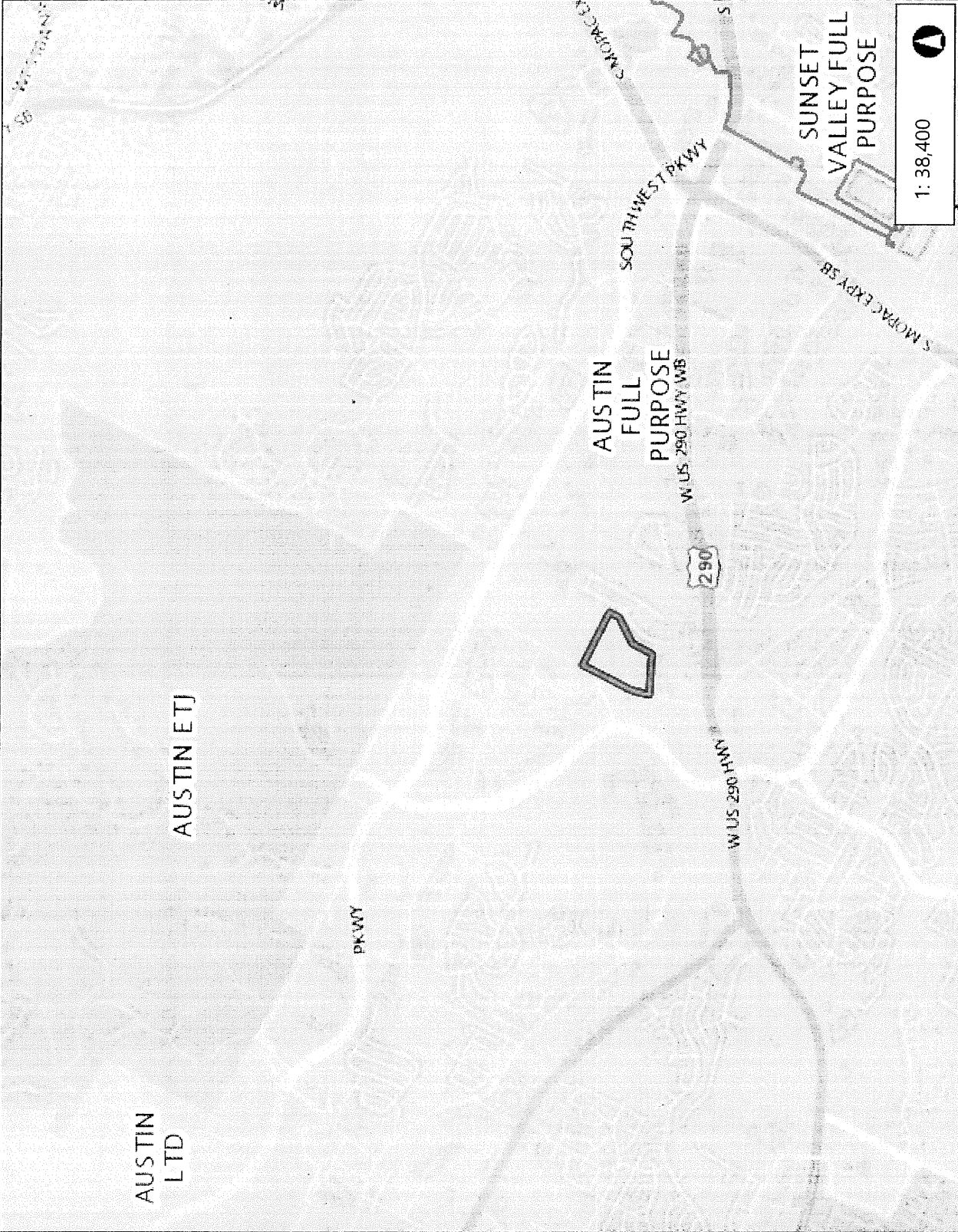

Legend

- Jurisdiction**
- FULL PURPOSE
 - LIMITED PURPOSE
 - EXTRATERRITORIAL JURISDICTION
 - 2 MILE ETJ AGRICULTURAL AGR
 - OTHER CITY LIMITS
 - OTHER CITIES ETJ
- Jurisdiction**
- FULL PURPOSE
 - LIMITED PURPOSE
 - EXTRATERRITORIAL JURISDICTION
 - 2 MILE ETJ AGRICULTURAL AGR
 - OTHER CITY LIMITS
 - OTHER CITIES ETJ

ZAD AC
 12300464

Notes



1: 38,400

This product is for informational purposes and may not have been prepared for or be suitable for legal, engineering, or surveying purposes. It does not represent an on-the-ground survey. This product has been produced by the City of Austin for the sole purpose of geographic reference. No warranty is made by the City of Austin regarding specific accuracy or completeness.

1.2 Miles



NAD_1983_StatePlane_Texas_Central_FIPS_4203_Feet

Date Printed: