

## SUBDIVISION REVIEW SHEET

**CASE NO.:** C8-2019-0148.0A

**Z.A.P. DATE:** 9-17-19

**SUBDIVISION NAME:** 707 W Slaughter Lane

**AREA:** 3.95

**LOT(S):** 1

**OWNER/APPLICANT:** SFC SOFTWARE FACTORY

**AGENT:** Professional Structural Engineers Inc. (Nobuki Omikawa)

**ADDRESS OF SUBDIVISION:** 707 W Slaughter Ln

**GRIDS:** MF14

**COUNTY:**

**WATERSHED:** Slaughter Creek

**JURISDICTION:** Full Purpose

**EXISTING ZONING:**

**DISTRICT:** 5

**NEIGHBORHOOD PLAN:**

**PROPOSED LAND USE:** Commercial

**ADMINISTRATIVE WAIVERS:** None

**VARIANCES:** None

**SIDEWALKS:** Sidewalks will be provided on both sides of all internal streets and the subdivision side of boundary streets.

**DEPARTMENT COMMENTS:** The request is for approval of the 707 W Slaughter Lane. The proposed plat is composed of 1 lots on 3.95 acres.

**STAFF RECOMMENDATION:** The staff recommends disapproval of the plat. This plat does not meet all applicable State and City of Austin LDC requirements.

**ZAP ACTION:**

ZAP 12309940

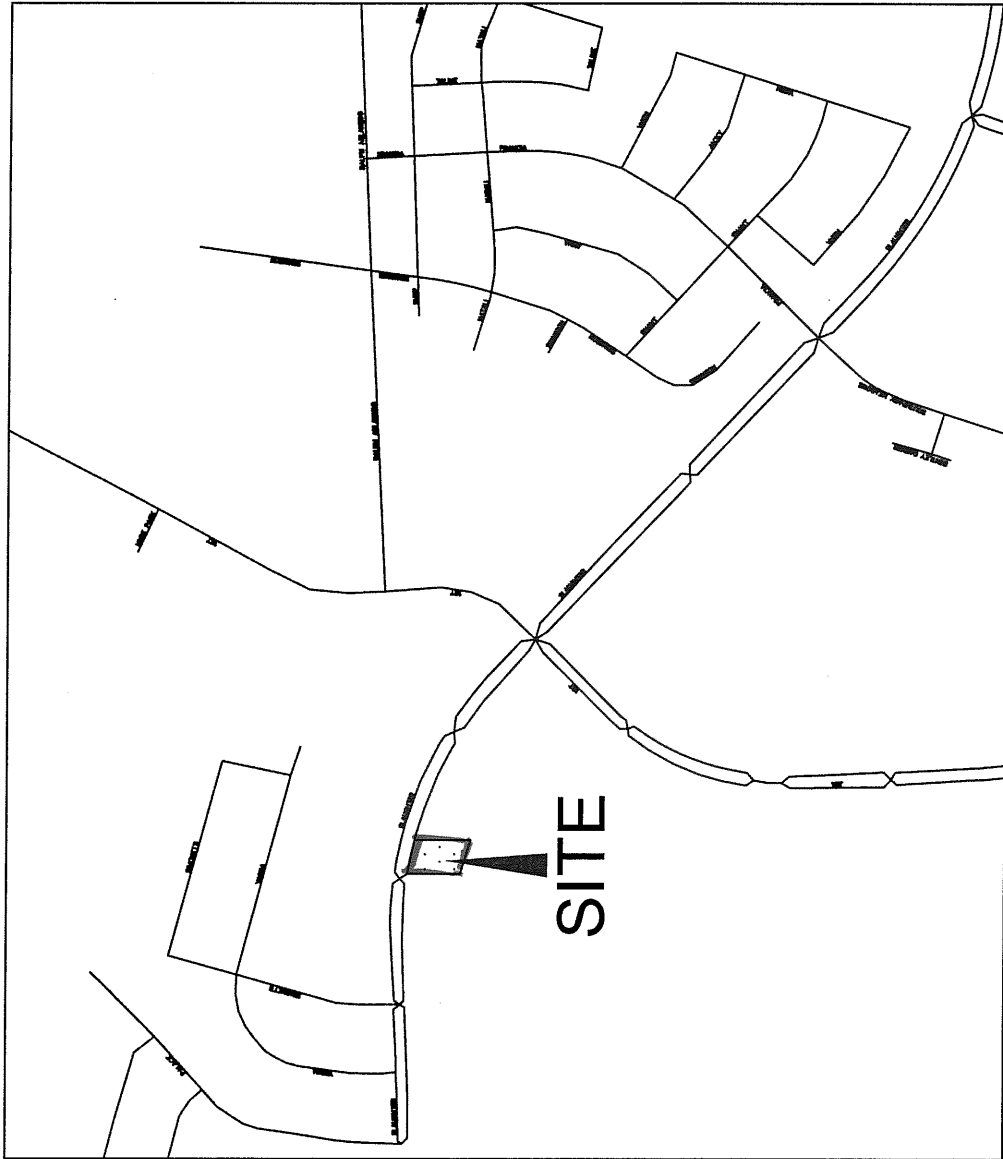

**SITE LOCATION MAP**  
GRID #MF14 & MAPSCO PAGE #496H