

ORDINANCE NO. 20190919-127

AN ORDINANCE AMENDING ORDINANCE NO. 040826-056 WHICH ADOPTED THE CENTRAL AUSTIN COMBINED NEIGHBORHOOD PLAN AS AN ELEMENT OF THE IMAGINE AUSTIN COMPREHENSIVE PLAN, TO CHANGE THE LAND USE DESIGNATION ON THE FUTURE LAND USE MAP FOR PROPERTY LOCATED AT 3805 RED RIVER STREET.

BE IT ORDAINED BY THE CITY COUNCIL OF THE CITY OF AUSTIN:

PART 1. Ordinance No. 040826-056 adopted the Central Austin Combined Neighborhood Plan as an element of the Imagine Austin Comprehensive Plan.

PART 2. Ordinance No. 040826-056 is amended to change the land use designation from single family use to mixed use/office use for the property located at 3805 Red River Street on the future land use map attached as **Exhibit "A"** and incorporated in this ordinance, and described in File NPA-2019-0019.01 at the Planning and Zoning Department.

PART 3. This ordinance takes effect on September 30, 2019.

PASSED AND APPROVED

_____, September 19, 2019

§
§
§

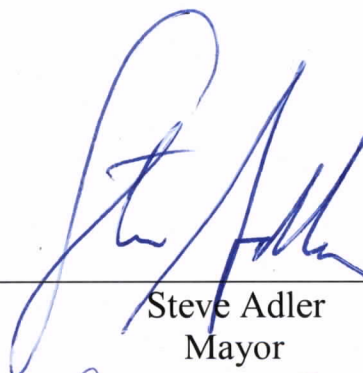

Steve Adler
Mayor

APPROVED:

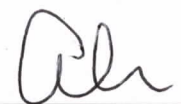

Anne L. Morgan
City Attorney

ATTEST:

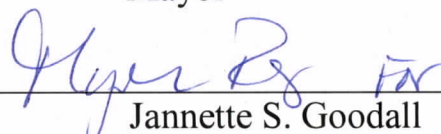

Jannette S. Goodall
City Clerk

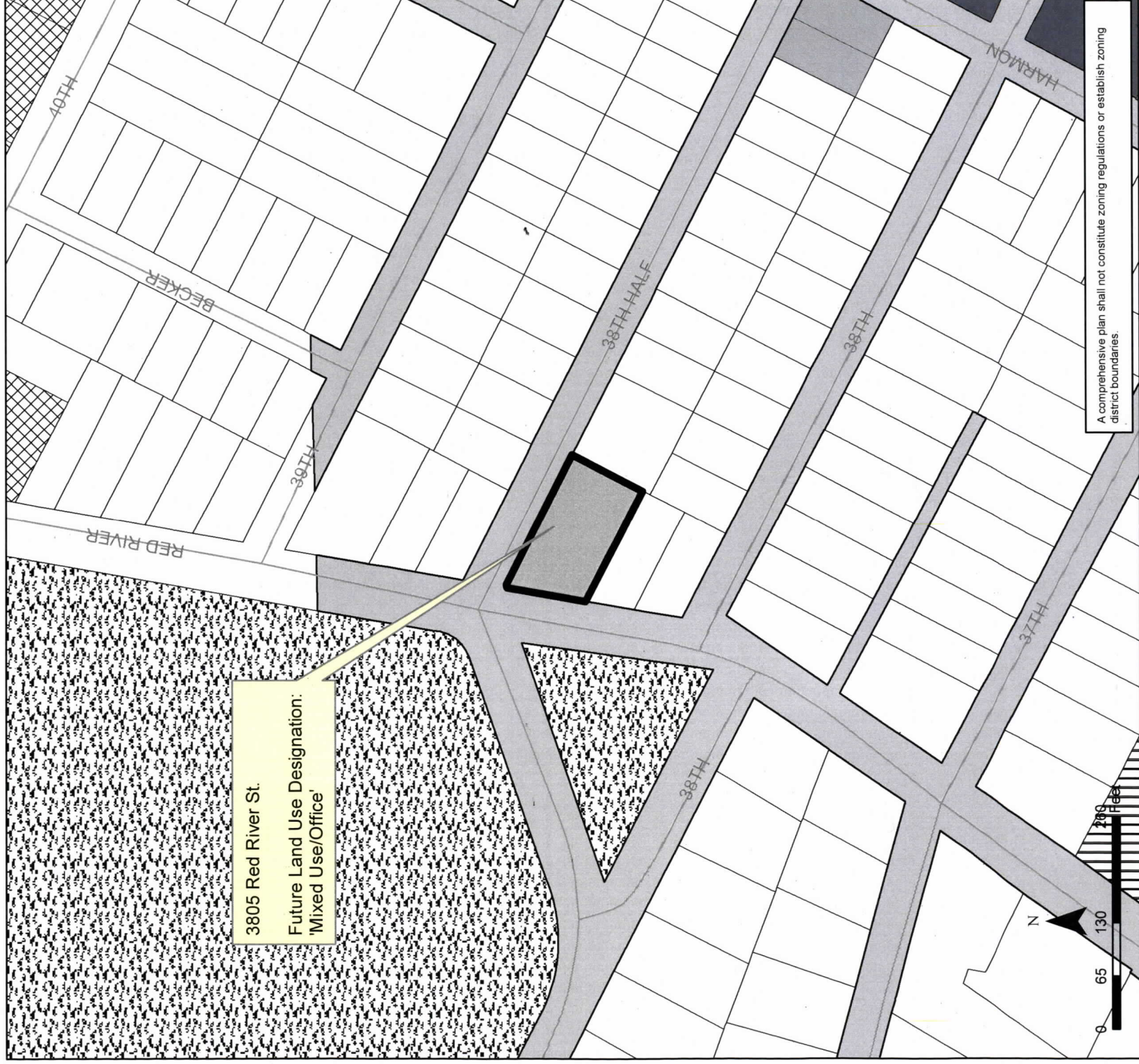

A comprehensive plan shall not constitute zoning regulations or establish zoning district boundaries.

Exhibit A Central Austin Combined Neighborhood Planning Area

Amendment NPA-2019-0019.01

This product is for informational purposes and may not have been prepared for or be suitable for legal, engineering, or surveying purposes. It does not represent an on-the-ground survey and represents only the approximate relative location of property boundaries.

This product has been produced by the Planning and Zoning Department for the sole purpose of geographic reference. No warranty is made by the City of Austin regarding specific accuracy or completeness.

Future Land Use	
	Subject Property
	Single-Family
	Higher-Density Single-Family
	Multi-Family
	Neighborhood Mixed Use
	Mixed Use
	High Density Mixed-Use
	Office
	Mixed Use/Office
	Civic
	Recreation & Open Space
	Transportation
	<Null>

